

4

3

2

1

THIS DRAWING IS UNPUBLISHED. RELEASED FOR PUBLICATION

© COPYRIGHT - TE Connectivity

ALL RIGHTS RESERVED.

LOC

DIST

REVISIONS

HB

P	LTR	DESCRIPTION	DATE	DWN	APVD
E1		REVISED PER ECO-11-005140	26MAR11	RK	HMR
G		1.CHANGE TE LOTO2.ADD LINE IDENTIFICATION3.TERMINALS TOLERANCE CLARIFICATION ECO-12-005305	02-APR-12	YS,H	BH,Y

Ⓞ

STE **TE** **us** **TE**

OSA-SS-224DM3 24V

5A 50V~

3A 125V~/30V



OEG



PART B

PART A

LOT NO.

ONE CHARACTER FOR LINE IDENTIFICATION Ⓞ

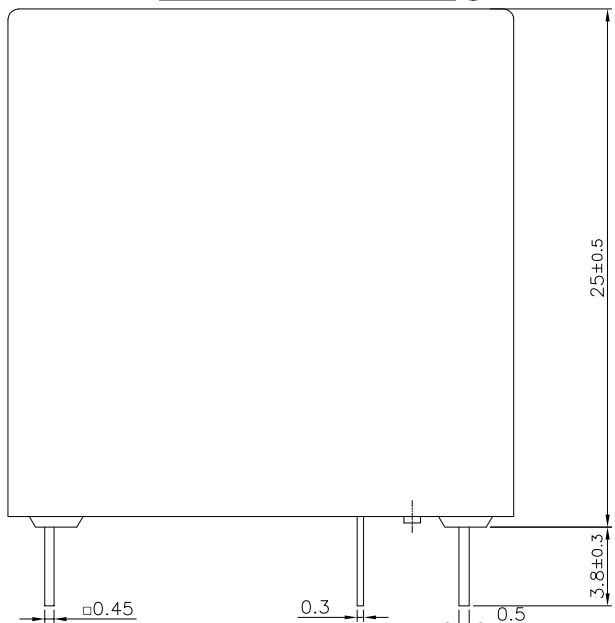

WIRING DIAGRAM(BOTTOM VIEW)

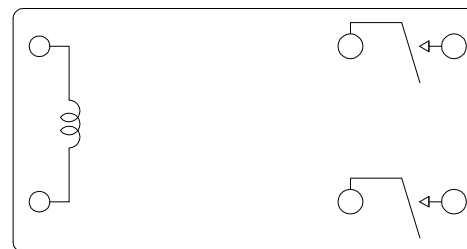

PC BOARD LAYOUT DIAGRAM(BOTTOM VIEW)

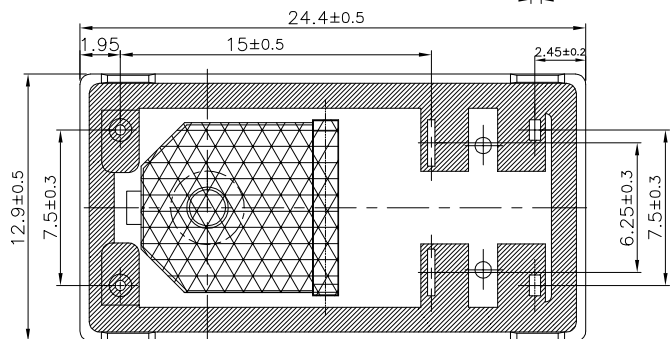
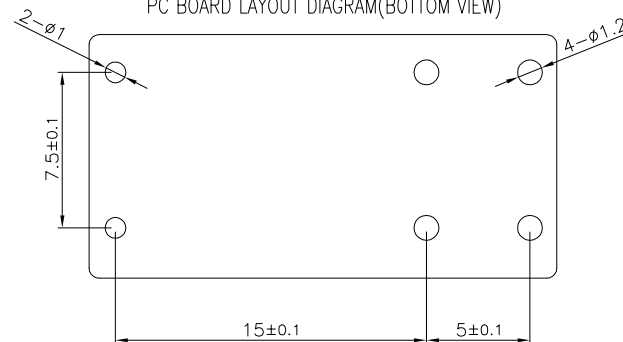

THIS DRAWING IS A CONTROLLED DOCUMENT.

DIMENSIONS:	TOLERANCES UNLESS OTHERWISE SPECIFIED:
mm	
	0 PLC ±
	1 PLC ±
	2 PLC ±
	3 PLC ±
	4 PLC ±
	ANGLES ±

DWN	Huang.Yunshou
CHK	Yu.Banghua
APVD	Zhang,Sunny
PRODUCT SPEC	-
APPLICATION SPEC	-
WEIGHT	-

STE TE Connectivity

NAME			
OSA-SH-2**DM3,000 CUSTOMER DWG			
SIZE	CAGE CODE	DRAWING NO	RESTRICTED TO
A3	00779	Ⓞ=3-1419124-5	-

CUSTOMER DRAWING SCALE 4:1 SHEET 1 OF 2 REV G

THIS DRAWING IS UNPUBLISHED. RELEASED FOR PUBLICATION
 © COPYRIGHT - By TE Connectivity ALL RIGHTS RESERVED.

LOC	DIST	REVISIONS			
P	LTR	DESCRIPTION	DATE	DWN	APVD
-	-	SEE SHEET 1	-	-	-

i	1461388-5	OSA-SH-248DM3	48V	OSA-SH-248DM3,000	107-79015(TRAY)
h	1461388-2	OSA-SH-206DM3	6V	OSA-SH-206DM3,000	107-79015(TRAY)
g	1461388-1	OSA-SH-205DM3	5V	OSA-SH-205DM3,000	107-79015(TRAY)
f	2-1440007-5	OSA-SH-224DM3	24V	OSA-SH-224DM3,000	107-79015(TRAY)
e	4-1419124-3	OSA-SH-224DM3	24V	OSA-SH-224DM3,000M	107-79016(TUBE)
d	8-1440001-3	OSA-SH-218DM3	18V	OSA-SH-218DM3,000	107-79015(TRAY)
c	3-1419124-5	OSA-SH-212DM3	12V	OSA-SH-212DM3,000	107-79015(TRAY)
b	3-1419124-6	OSA-SH-212DM3	12V	OSA-SH-212DM3,000M	107-79016(TUBE)
a	8-1440001-0	OSA-SH-209DM3	9V	OSA-SH-209DM3,000	107-79015(TRAY)
No.	PART NO.	PART A	PART B	TYPE NAME	PACKING SPEC

RELAY TYPE

			EPOXY RESIN	SEAL	14
			POLYURETHANE Cu WIRE	MAGNETIC WIRE	13
UL 94V-0			PA66	CARD	12
UL 94V-0			PBT	CASE	11
UL 94V-0			PBT	BOBBIN	10
		SOLDER DIP	Cu Alloy	COIL TERMINAL	9
		SOLDER DIP	Cu Alloy	HINGE SPRING	8
			Ag Alloy	S-CONTACT	7
			Ag Alloy	C-CONTACT	6
		SOLDER DIP	Cu Alloy	M-TERMINAL	5
		SOLDER DIP	Cu Alloy	MOVABLE SPRING	4
		Ni PLATING	STEEL	CORE	3
		Ni PLATING	STEEL	ARMATURE	2
		Ni PLATING	STEEL	YOKE	1
INCOMBUSTIBILITY	NOTES	FINISH	MATERIAL	DESCRIPTION	ITEM

NOTE:

- 1.TERMINAL DIMENSIONS WITHOUT TINNING.
- 2.LOT NO. SYSTEM AS FOLLOWING:

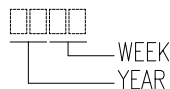

- 3.FOR THE TIN-PLATING OF THE PINS:
 +0.1mm FOR WIDTH, THICKNESS AND DIAMETER
 +0.5mm FOR LENGTH

Diagram dimension	Tolerance
0.99mm max.	±0.1mm
1 - 2.99mm	±0.2mm
3mm min.	±0.5mm

THIS DRAWING IS A CONTROLLED DOCUMENT.

DWN	Huang.Yunshou	TE Connectivity OSA-SH-2**DM3,000 CUSTOMER DWG	SIZE	A3	CAGE CODE	00779	DRAWING NO	©=3-1419124-5	RESTRICTED TO	-		
CHK	Yu.Banghua		APPLICATION SPEC	-	WEIGHT	-	SCALE	4:1	SHEET	2 OF 2	REV	G
APVD	Zhang.Sunny		MATERIAL	-	CUSTOMER DRAWING	-						
PRODUCT SPEC	-		FINISH	-								

X-ON Electronics

Largest Supplier of Electrical and Electronic Components

Click to view similar products for [General Purpose Relays](#) category:

Click to view products by [TE Connectivity](#) manufacturer:

Other Similar products are found below :

[PCN-105D3MH,000](#) [59641F200](#) [LY1SAC110120](#) [5X827E](#) [5X837F](#) [5X840F](#) [5X842F](#) [5X848E](#) [LY2N-AC120](#) [LY2S-AC220/240](#) [LY2-US-AC120](#) [LY3-US-AC120](#) [LY4F-UA-DC12](#) [LY4F-UA-DC24](#) [LY4F-US-AC120](#) [LY4F-US-AC240](#) [LY4F-US-DC24](#) [LY4F-VD-AC110](#) [LYQ20DC12](#) [M115C60](#) [M115N010](#) [M115N0150](#) [6031007G](#) [603-12D](#) [61211T0B4](#) [61212T400](#) [61222Q400](#) [61243B600](#) [61243C500](#) [61243Q400](#) [61311BOA2](#) [61311BOA6](#) [61311BOA8](#) [61311COA2](#) [61311COA1](#) [61311COA6](#) [61311F0A2](#) [61311QOA1](#) [61311QOA4](#) [61311T0D6](#) [61311TOA6](#) [61311TOA7](#) [61311TOB3](#) [61311TOB4](#) [61311U0A6](#) [61312Q600](#) [61312T400](#) [61312T600](#) [61313U200](#) [61313U400](#)