

USB A FEEDTHROUGH CONNECTOR GROUNDED TO OUTER SHELL

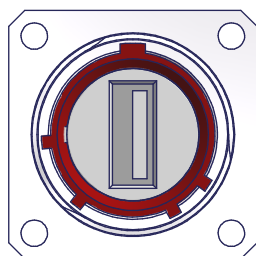

OPTION Y (OPTION Z AT REVERSE END)

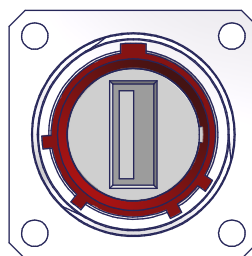

OPTION Z (OPTION Y AT REVERSE END)

**NOTES**  
 MIL-DTL-38999 STYLE  
 MATES WITH AMPHENOL USBFTV  
**MATERIALS**  
 USB A INSERT  
 CONTACTS 30µ Au/Ni  
 SHIELDING - NICKEL PLATED BRASS  
 BODY - PA, UL94V-0  
 PCB - FR4, UL94V-0

SEAL - SILICONE ELASTOMER  
 INSULATOR - PPS GL40 UL94-V0, COLOUR BLACK

**PERFORMANCE**  
 CURRENT RATING 1 AMP MAX PER CONTACT  
 VOLTAGE RATING 30V AC  
 TEMPERATURE -40°C TO +105°C

**PC4B0064-15NX-1-C**

SERIES  
 SHELL SIZE  
 KEY ARRANGEMENT (N, A, B, C, D, E)  
 INSERT ROTATION (X, Y, Z)  
 MATERIAL (SEE TABLE)  
 PLATING (SEE TABLE)  
 PART NUMBER FOR UNGROUNDED OPTION PC4B0064-15NX-1-C-U

CODE	MATERIAL / PLATING
1-C	ALUMINIUM / ELECTROLESS NICKEL
1-B	ALUMINIUM / CADMIUM OLIVE DRAB OVER ELECTROLESS NICKEL
1-ZB	ALUMINIUM / ZINC COBALT OLIVE DRAB OVER ELECTROLESS NICKEL
4-J	STAINLESS STEEL / PASSIVATE
2-Z	NICKEL ALUMINIUM BRONZE / SHOT BLAST

LIST NOT EXHAUSTIVE, FOR COMPREHENSIVE LIST AND SPECS, SEE WEBSITE

<b>DRAWN</b>	R.S.	DATE	3RD ANGLE PROJECTION NOT TO SCALE
<b>SALES APPR</b>	M.F.	01/09/2016	
<b>DESIGN APPR</b>			UNLESS OTHERWISE SPECIFIED ALL DIMENSIONS IN MILLIMETRES <b>GENERAL TOL</b> LINEAR +/-0,25MM ANGULAR +/- 1°
<b>PROD APPR</b>			
<b>QUAL APPR</b>			<b>MATERIAL</b> SEE PART NUMBER BREAKDOWN <b>FINISH</b> SEE PART NUMBER BREAKDOWN
<b>ISSUE</b>	REV.	DCR	
<b>1</b>			
NCAGE CODE U5792		WEIGHT	

**PART NUMBER:**

**PC4B0064-15\*\*-\*\*-\***

**TITLE:**

**USB A BULKHEAD FEEDTHROUGH ASSEMBLY**

**ASSY USED ON: USB A D38999/20**

THIS DRAWING IS COPYRIGHT AND THE PROPERTY OF POLAMCO LTD IT MUST NOT BE COPIED, USED FOR MANUFACTURE OR OTHERWISE DISCLOSED WITHOUT PRIOR WRITTEN CONSENT OF THE COMPANY.

POLAMCO LTD, WESTON LOCK, LOWER BRISTOL ROAD BATH BA2 1EP

SHT 1

**Polamco**  
TE connectivity

**DRAWING NO: C4461**

## X-ON Electronics

Largest Supplier of Electrical and Electronic Components

*Click to view similar products for [Modular Connectors / Ethernet Connectors](#) category:*

*Click to view products by [TE Connectivity](#) manufacturer:*

Other Similar products are found below :

[8949-H88/06BLKA/SN](#) [74441-0010/BKN](#) [MP1010RX-1000](#) [MP44RX-1000](#) [PHJ-4P4C-1-V-4](#) [PHP-6P6C-5](#) [GAX-3-66](#) [GAX-8-62](#) [GDCX-PA-66-50](#) [GDCX-PN-64](#) [GDCX-PN-66](#) [GDCX-PN-66-50](#) [GDLX-A-66](#) [GDLX-N-66](#) [GDLX-S-66](#) [GDLX-S-88K](#) [GDTX-S-88-50](#) [GDX-PA-1010](#) [GLX-N-1010M-BLK](#) [GLX-S-88M-BLK](#) [GMX-N-1010](#) [GMX-S-1010](#) [GMX-S-66](#) [GMX-SMT4-N-88](#) [GPX-2-64](#) [GSGX-N-2-88](#) [GSGX-N-4-88](#) [GSX-NS2-88-3.05](#) [GSX-NS2-88-3.05-50](#) [GSX-NS-88-3.05-50](#) [PT-108A-8C-UL](#) [PT-J951-8C](#) [PTS-J531-8CS-50UL](#) [1-1775629-2](#) [A-2014-0-4](#) [GWLX-S-88-GR](#) [GWLX-S9-88-YG](#) [DC-1021-8-WH-6](#) [1300530003](#) [1324640-4](#) [RJ11FTVC2G](#) [RJ11FTVC2N](#) [RJFTVX2SA1G](#) [132764-001](#) [1413235](#) [MP88X-1000](#) [MPS88RX-5000](#) [E5288-S000K3-L](#) [E5908-15A242-L](#) [155302-001](#)