

THIS DRAWING IS UNPUBLISHED. RELEASED FOR PUBLICATION
 © COPYRIGHT - By - ALL RIGHTS RESERVED.

| LOC | | DIST | | REVISIONS | | | |
|-----|-----|--|-----------|-----------|------|--|--|
| # | LYR | DESCRIPTION | DATE | OWN | APVD | | |
| C | | OBSOLETE P/N ECO-09-014329 | 28Jul2009 | YS.H | BH.Y | | |
| D | | CHANGS LOGBOARD LINE IDENTIFICATION ECO-12-003498 & ADD CIP SYMBOL P-11-003756 | 08Nov2012 | YS.H | BH.Y | | |
| D1 | | ADD A NEW PN ECO-14-009275 | 19JUN2014 | Q.L | B.F | | |

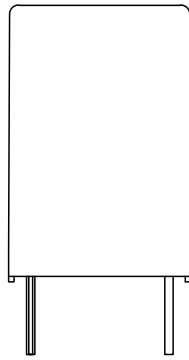

CONNECTION DIAGRAM (BOTTOM VIEW)

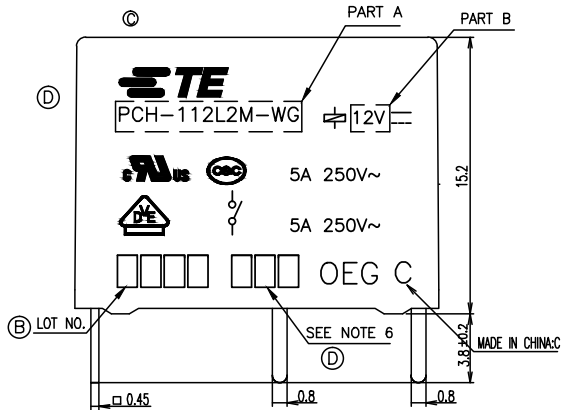
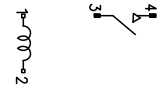

DRILLING DIAGRAM (BOTTOM VIEW)

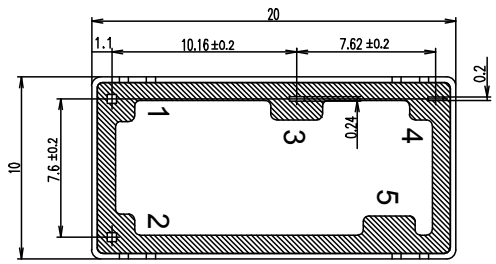
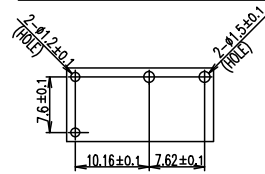

| Diagram dimension | Tolerance |
|-------------------|-----------|
| 0.99mm max. | ±0.1mm |
| 1 - 2.99mm | ±0.2mm |
| 3mm min. | ±0.3mm |

| | | | | | |
|---|--|-------------------|--|-------------------------|--------------------|
| THIS DRAWING IS A CONTROLLED DOCUMENT. | | DWN KY.DU | TE Connectivity | | |
| DIMENSIONS: mm | | CHK N.Funayama | | | |
| DIMENSIONS: mm TOLERANCES UNLESS OTHERWISE SPECIFIED: 0 PLC ± - 1 PLC ± - 2 PLC ± - 3 PLC ± - 4 PLC ± - ANGLES ± - | | APVD C.H.HAU | NAME PCH-L2M(H)-WG CUSTOMER DRAWING | | |
| MATERIAL - | | FINISH - | PRODUCT SPEC - | APPLICATION SPEC - | RESTRICTED TO - |
| | | SIZE A3 | CAGE CODE 00779 | DRAWING NO C=1721768 | SCALE 5:1 |
| | | CUSTOMER DRAWING | | SHEET 1 of 2 | REV D1 |

4

3

2

1

THIS DRAWING IS UNPUBLISHED. RELEASED FOR PUBLICATION
 © COPYRIGHT - By - ALL RIGHTS RESERVED.

| LOC | | DIST | | REVISIONS | | | |
|-----|-----|-------------|------|-----------|------|--|--|
| P | LYR | DESCRIPTION | DATE | OWN | APVD | | |
| - | - | SEE SHEET 1 | - | - | - | | |

| | | | | | | |
|---------------|---------------|--------|------------------|-----------------|------|------------|
| ① 1-1721768-6 | PCH-109L2M-WG | 5V | PCH-109L2M-WG | 107-79096(TUBE) | p | ACTIVE |
| 1-1721768-5 | PCH-124L2M-WG | 24V | PCH-124L2M-WG | 107-79096(TUBE) | o | ACTIVE |
| 1-1721768-4 | PCH-148L2M-WG | 48V | PCH-148L2M(H)-WG | 107-79019(TRAY) | n | OBSOLETE |
| 1-1721768-3 | PCH-124L2M-WG | 24V | PCH-124L2M(H)-WG | 107-79019(TRAY) | m | OBSOLETE |
| 1-1721768-2 | PCH-112L2M-WG | 12V | PCH-112L2M(H)-WG | 107-79019(TRAY) | l | OBSOLETE |
| 1-1721768-1 | PCH-109L2M-WG | 9V | PCH-109L2M(H)-WG | 107-79019(TRAY) | k | OBSOLETE |
| 1-1721768-0 | PCH-106L2M-WG | 6V | PCH-106L2M(H)-WG | 107-79019(TRAY) | j | OBSOLETE |
| 1721768-9 | PCH-109L2M-WG | 5V | PCH-109L2M(H)-WG | 107-79019(TRAY) | i | OBSOLETE |
| 1721768-8 | PCH-103L2M-WG | 3V | PCH-103L2M(H)-WG | 107-79019(TRAY) | h | OBSOLETE |
| 1721768-7 | PCH-148L2M-WG | 48V | PCH-148L2M-WG | 107-79019(TRAY) | g | ACTIVE |
| 1721768-6 | PCH-124L2M-WG | 24V | PCH-124L2M-WG | 107-79019(TRAY) | f | ACTIVE |
| 1721768-5 | PCH-112L2M-WG | 12V | PCH-112L2M-WG | 107-79019(TRAY) | e | ACTIVE |
| 1721768-4 | PCH-109L2M-WG | 9V | PCH-109L2M-WG | 107-79019(TRAY) | d | ACTIVE |
| 1721768-3 | PCH-106L2M-WG | 6V | PCH-106L2M-WG | 107-79019(TRAY) | c | ACTIVE |
| 1721768-2 | PCH-105L2M-WG | 5V | PCH-105L2M-WG | 107-79019(TRAY) | b | ACTIVE |
| 1721768-1 | PCH-103L2M-WG | 3V | PCH-103L2M-WG | 107-79019(TRAY) | a | ABSOLUTE |
| TE PART NO | TE TYPE NAME | PART B | PART A | PACKAGE SPEC. | TYPE | P/N STATUS |

RELAY TYPE

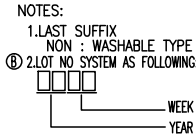

- ③ 3. TERMINAL DIMENSION IS BEFORE SOLDER DIP;
- ④ 4. FOR THE TIN-PLATING OF THE PINS:
 +0.1mm FOR WIDTH, THICKNESS AND DIAMETER.
 +0.5mm FOR LENGTH.
- ⑤ 5. MARKING FROM INK TO LASER.

⑥ 6. ADD LOT NO. SYSTEM AS FOLLOWING;



- I, DIGITS FOR DAY OF THE WEEK
 1...MONDAY IN THIS WEEK;
 2...TUESDAY IN THIS WEEK;

 7...SUNDAY IN THIS WEEK
- II, DIGITS FOR SHIFT OF THE DAY
 1...DAY SHIFT IN THIS DAY;
 2...NIGHT SHIFT IN THIS DAY;
- III, ONE CHARACTER DISTINGUISH THE LINE IDENTITY, SUCH AS: A,B,...,Z

| | | | | |
|------------------|-------------|---------------|--------------------|------|
| | UV RESIN | UV SEAL | 16 | |
| | EPOXY RESIN | SEAL | 15 | |
| CLASS F (A) | MW79 (A) | MAGNETIC WIRE | 14 | |
| | SOLDER DIP | CP WIRE | COIL TERMINAL | 13 |
| | | Ag ALLOY | STATIONARY CONTACT | 12 |
| | | Ag ALLOY | MOVABLE CONTACT | 11 |
| | | Cu ALLOY | HINGE SPRING | 10 |
| | SOLDER DIP | Cu ALLOY | NO TERMINAL | 9 |
| | SOLDER DIP | Cu ALLOY | MOVABLE SPRING | 8 |
| UL 94V-0 | | LCP | CARD | 7 |
| UL 94V-0 | | PET | CASE | 6 |
| UL 94HB | | PA NYLON | BOBBIN | 5 |
| UL 94V-0 | | PET | BASE | 4 |
| | Ni PLATED | STEEL | CORE | 3 |
| | CuNi PLATED | STEEL | ARMATURE | 2 |
| | CuNi PLATED | STEEL | YOKE | 1 |
| INCOMBUSTIBILITY | TREATMENT | MATERIAL | DESCRIPTION | ITEM |

| | | | | | | | | | | | | | | | | | | | | | | | | | | | | | |
|---|--------|------------------|------------|--------------------------------|---------|---|-----|---|---|---|-----|---|---|---|-----|---|---|---|-----|---|---|--------|--------|---|---|------------------|--|-----------|------------|
| THIS DRAWING IS A CONTROLLED DOCUMENT. | | DWN | KY.DU | TE Connectivity | | | | | | | | | | | | | | | | | | | | | | | | | |
| | | CHK | N.Funayama | PCH-L2M(H)-WG CUSTOMER DRAWING | | | | | | | | | | | | | | | | | | | | | | | | | |
| DIMENSIONS: mm | | APVD | C.H.Hsu | NAME | | | | | | | | | | | | | | | | | | | | | | | | | |
| TOLERANCES UNLESS OTHERWISE SPECIFIED: | | PRODUCT SPEC | | SIZE | | | | | | | | | | | | | | | | | | | | | | | | | |
| <table border="1"> <tr><td>0</td><td>PLC</td><td>±</td><td>-</td></tr> <tr><td>1</td><td>PLC</td><td>±</td><td>-</td></tr> <tr><td>2</td><td>PLC</td><td>±</td><td>-</td></tr> <tr><td>3</td><td>PLC</td><td>±</td><td>-</td></tr> <tr><td>4</td><td>PLC</td><td>±</td><td>-</td></tr> <tr><td>ANGLES</td><td>FINISH</td><td>±</td><td>-</td></tr> </table> | | 0 | PLC | ± | - | 1 | PLC | ± | - | 2 | PLC | ± | - | 3 | PLC | ± | - | 4 | PLC | ± | - | ANGLES | FINISH | ± | - | APPLICATION SPEC | | CAGE CODE | DRAWING NO |
| 0 | PLC | ± | - | | | | | | | | | | | | | | | | | | | | | | | | | | |
| 1 | PLC | ± | - | | | | | | | | | | | | | | | | | | | | | | | | | | |
| 2 | PLC | ± | - | | | | | | | | | | | | | | | | | | | | | | | | | | |
| 3 | PLC | ± | - | | | | | | | | | | | | | | | | | | | | | | | | | | |
| 4 | PLC | ± | - | | | | | | | | | | | | | | | | | | | | | | | | | | |
| ANGLES | FINISH | ± | - | | | | | | | | | | | | | | | | | | | | | | | | | | |
| MATERIAL | | WEIGHT | | A3 | 00779 | | | | | | | | | | | | | | | | | | | | | | | | |
| | | CUSTOMER DRAWING | | ① | 1721768 | | | | | | | | | | | | | | | | | | | | | | | | |
| | | SCALE | 5:1 | SHEET | 2 of 2 | | | | | | | | | | | | | | | | | | | | | | | | |
| | | REV | D1 | | | | | | | | | | | | | | | | | | | | | | | | | | |

X-ON Electronics

Largest Supplier of Electrical and Electronic Components

Click to view similar products for [General Purpose Relays](#) category:

Click to view products by [TE Connectivity](#) manufacturer:

Other Similar products are found below :

[PCN-105D3MH,000](#) [59641F200](#) [5JO-1000CD-SIL](#) [LY1SAC110120](#) [5X827E](#) [5X837F](#) [5X840F](#) [5X842F](#) [5X848E](#) [LY2N-AC120](#) [LY2S-AC220/240](#) [LY2-US-AC120](#) [LY3-US-AC120](#) [LY4F-UA-DC12](#) [LY4F-UA-DC24](#) [LY4F-US-AC120](#) [LY4F-US-AC240](#) [LY4F-US-DC24](#) [LY4F-VD-AC110](#) [LYQ20DC12](#) [M115C60](#) [M115N010](#) [M115N0150](#) [6031007G](#) [603-12D](#) [61211T0B4](#) [61212T400](#) [61222Q400](#) [61243B600](#) [61243C500](#) [61243Q400](#) [61311BOA2](#) [61311BOA6](#) [61311BOA8](#) [61311C0A2](#) [61311COA1](#) [61311COA6](#) [61311F0A2](#) [61311QOA1](#) [61311QOA4](#) [61311T0D6](#) [61311TOA6](#) [61311TOA7](#) [61311TOB3](#) [61311TOB4](#) [61311U0A6](#) [61312Q600](#) [61312T400](#) [61312T600](#) [61313U200](#)