

THIS DRAWING IS UNPUBLISHED. RELEASED FOR PUBLICATION  
 © COPYRIGHT BY TYCO ELECTRONICS CORPORATION. ALL RIGHTS RESERVED.

LOC	DIST	REVISIONS			
P	LTR	DESCRIPTION	DATE	DWN	APVD
AD	00	A	OG3C-0469-04	16AUG05	RB MZ

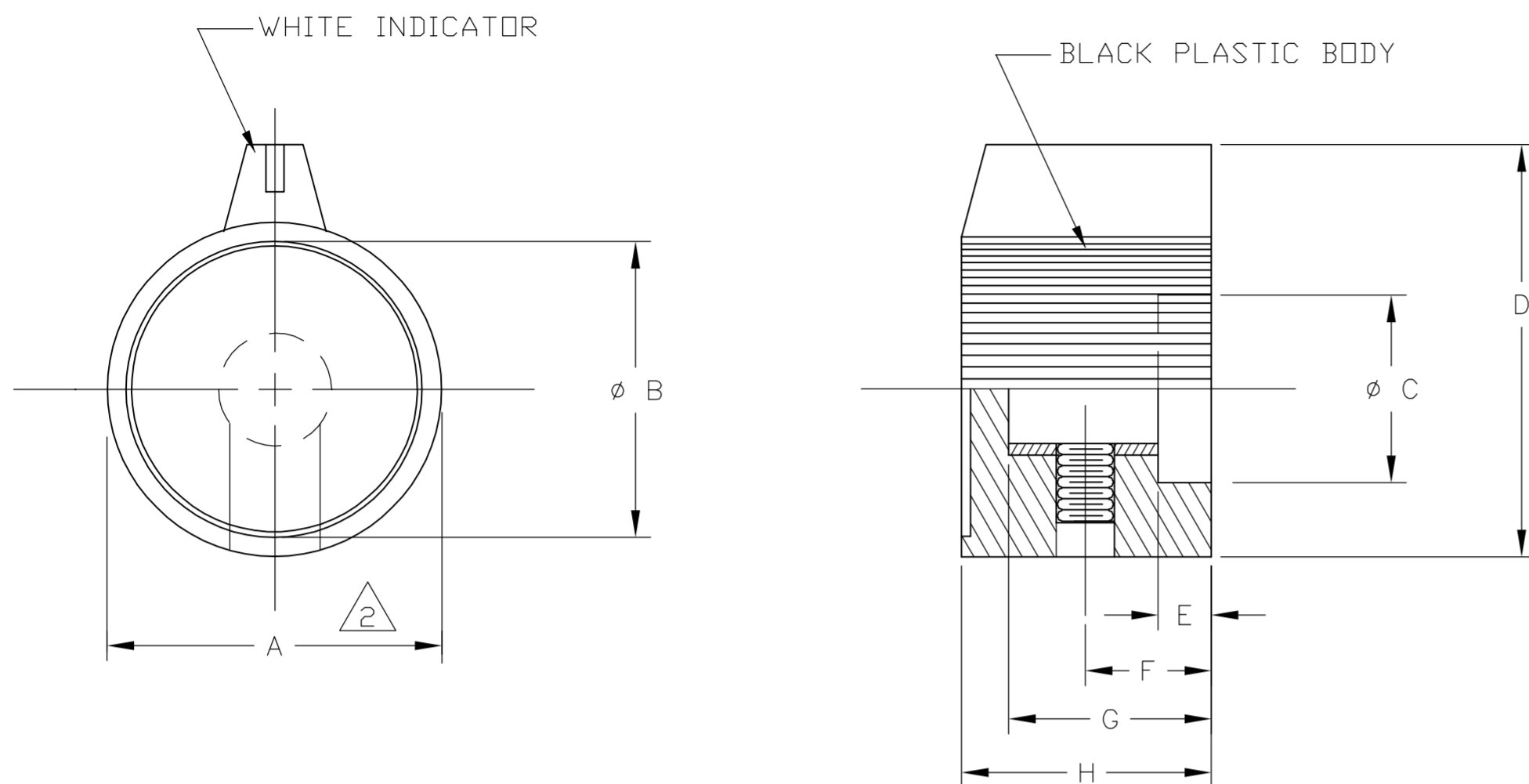

**SPECIFICATIONS:**

**MATERIALS:**  
 BODY: PHENOLIC, COLOR: BLACK.  
 SHAFT HOLE INSERT: BRASS  
 SET SCREW: #6-32 UNC-2A.  
 CAP: SPUN ALUMINUM.

**NOTES:** UNLESS OTHERWISE SPECIFIED

- INTERPRET DRAWING PER ANSI Y14.5M-1982.
- DIM. A MEASURED AT BASE OF KNOB (LARGEST DIA.).

TYCO PT NO	ALCO PT NO	HOLE SIZE	"A" DIA.	"B"	"C"	"D"	"E"	"F"	"G"	"H"
7-1437624-7	PKJ-70B-1/4	.251	.760	.665	.545	.915	.118	.255	.450	.555
7-1437624-6	PKJ-60B-1/4	.251	.630	.545	.468	.758	.118	.255	.440	.530
7-1437624-4	PKJ-50B-1/4	.251	.500	.416	.420	.577	.113	.276	.429	.512
7-1437624-5	PKJ-50B-1/8	.126	.500	.416	.420	.577	.113	.276	.429	.512

TOLERANCE CHART		
	DIMENSION	TOLERANCE
BODY	.020-.157	±.004
	.158-.630	±.010
	.631-2.52	±.015
SHAFT HOLE	.126 DIA.	+0.003 -0.000
	.251 DIA.	+0.003 -0.000

THIS DRAWING IS A CONTROLLED DOCUMENT.		DWN R BROWN 16AUG05	Tyco Electronics Corporation Harrisburg, Pa 17105-3608	
DIMENSIONS: INCHES		CHK M ZITTO 16AUG05		
TOLERANCES UNLESS OTHERWISE SPECIFIED:		APVD M ZITTO 16AUG05	NAME KNOB PKJ SERIES	
0 PLC ± - 1 PLC ± - 2 PLC ± - 3 PLC ± - 4 PLC ± - ANGLES ± 3°		PRODUCT SPEC -	RESTRICTED TO -	
MATERIAL -		FINISH -	WEIGHT -	SIZE A2
		CAGE CODE 00779		DRAWING NO C=1437624
		CUSTOMER DRAWING		SCALE 2:1
		SHEET 1 OF 1		REV A

## X-ON Electronics

Largest Supplier of Electrical and Electronic Components

*Click to view similar products for [Knobs & Dials](#) category:*

*Click to view products by [TE Connectivity](#) manufacturer:*

Other Similar products are found below :

[790-1030](#) [790-1202](#) [790-2226](#) [8519](#) [8529](#) [8547](#) [85-559](#) [8573](#) [11K5015-EMNB](#) [11K5019-ECNB](#) [11K5020-KLAB](#) [11K5048-KMNB](#)  
[11K5014-EMNB](#) [11K5015-EMNG](#) [11K5019-EMNB](#) [MS91528-2N2B](#) [1770](#) [P400S-08-D6-N](#) [K6510](#) [KNP700A1/4](#) [3045B](#) [AR22PY-122B](#)  
[PKJ50B18](#) [277A](#) [348003](#) [42000B38](#) [420114B14](#) [5006](#) [56008-001](#) [KS700B14](#) [411](#) [420037B14](#) [WA-101C-P](#) [WA-102B](#) [WA-103](#) [WA-109B](#)  
[WA-1450-P](#) [WA-1550](#) [WA-1600-P](#) [WA-2300](#) [WA-4100](#) [WA-4108-P](#) [0166736-006](#) [0195316-052](#) [0703006-003](#) [0744386-211](#) [52-928.20](#)  
[52-928.9](#) [8517](#) [8545](#)