

Land of Origin

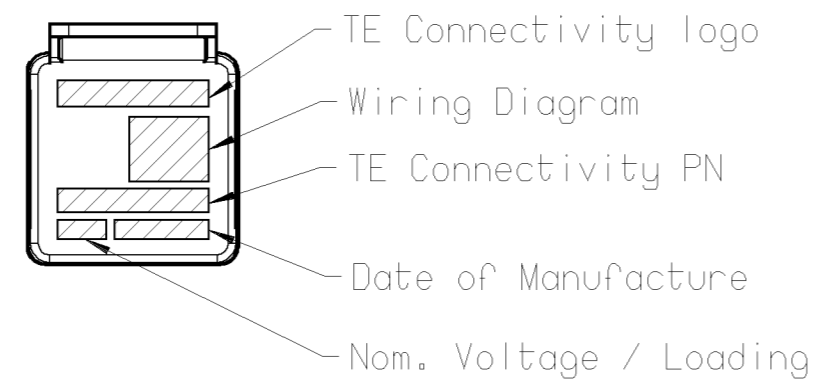

TERMINAL CONFIGURATION

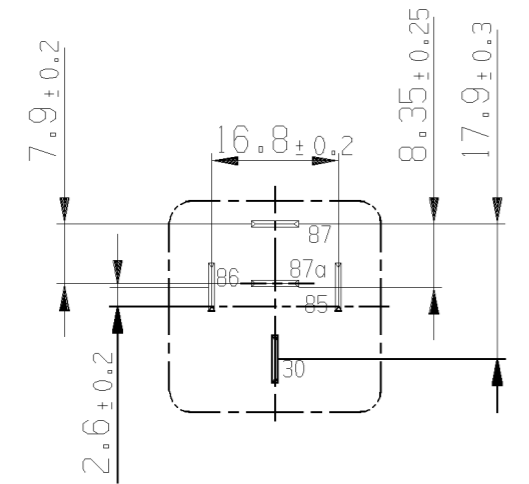

WIRING DIAGRAM

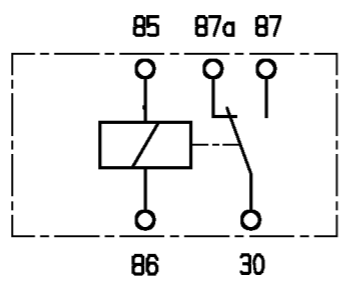

BLADE TERMINALS DIN 46 244-A6,3-0,8 CuZn TIN PLATED  
 CUT EDGES WITHOUT TIN PLATING ALLOWED  
 DEGREE OF PROTECTION ACC. TO IEC529 = DIN 40 050 Teil 9  
 TERMINALS IP20  
 HOUSING IP34  
 IN CONNECTION WITH A CONNECTOR HOUSING  
 MOUNTING POSITION: TERMINALS SHALL POINT DOWNWARDS  
 FOR ALL OTHER POSITIONS PROTECTION GROUP IP 20 IS VALID

PART	MATERIAL	COLOUR
HOUSING	PA 66 GF 30± 10 [%]	BLACK
BASE PLATE	PA 66 GF 30± 10 [%]	BLACK

OBSOLETE BOSCH P/N	TE P/N	REV	PART NUMBER	CUSTOMER P/N	CODE NO
0 332 209 150	0-1904022-2		V23234-A1001-X036		
	1-1904022-2				
	2-1904022-2				
	3-1904022-2				
	4-1904022-2				
	5-1904022-2				
6-1904022-2					
PROPRIETARY THE REPRODUCTION, TRANSMISSION OR USE OF THIS DOCUMENT OR IT'S CONTENTS IS NOT PERMITTED WITHOUT EXPRESSED WRITTEN AUTHORITY. OFFENDERS WILL BE LIABLE FOR ALL DAMAGES. ALL RIGHTS, INCLUDING RIGHTS CREATED BY REGISTERED PATENT(S) GRANTED FOR A UTILITY MODEL OR DESIGN, ARE RESERVED.			CHANGES TO THIS DRAWING MUST BE DONE ONLY IN CAD		PAPER SIZE <b>A3</b>
APPLICABLE SPEC.:			FINISH DIMENSIONS APPLY PLATING SCALE <b>1:1</b> WEIGHT <b>Ca.34g</b>		
TOLERANCE UNLESS SPECIFIED OTHERWISE			DIMENSIONS IN MM		
DATE NAME 2006-06-06 P.Tomas			PART NAME <b>MINI RELAY B            CHANGEOVER 12V 20/30A</b>		
LOCATION PE EVORA			PART NO. <b>V23234-A1001-X036</b>		
REV. CHANGE ORDER DATE APP.			CUSTOMER DRAWING		SHT. <b>1</b> OF 2



Nominal voltage (load and excitation circuit)	
Permissible operating voltage	8...16V
Permissible ambient temperature	-40... 100 ° C
Response voltage (at 20 ° C)	≤ 8 V
Release voltage (at 20 ° C)	1,2...5.5 V
Response time	≤ 10 ms
Release time	≤ 10 ms
Contact material	Silver based
Equivalent coil resistance at terminal 85-86	85± 5Ω

Voltage drop at blade terminals at a measuring current of 10± 0.5A	
Normally Open Contact, Terminal 30-87 in new condition	Typically ≤ 50mV, Max. 300mV
After life test	Typically ≤ 80mV, Max. 300mV
Normally Closed Contact, Terminal 30-87a in new condition	Typically ≤ 70mV, Max. 300mV
After life test	Typically ≤ 120mV, Max. 300mV

**ELECTRICAL ENDURANCE**

Resistive Load 30A on NO	- ≥ 250.000 cycles
Resistive Load 10A on NO	- ≥ 250.000 cycles
Resistive Load 20A on NC	- ≥ 250.000 cycles

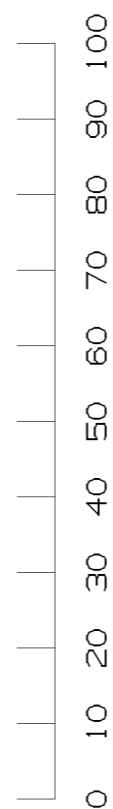

PROPRIETARY THE REPRODUCTION, TRANSMISSION OR USE OF THIS DOCUMENT OR IT'S CONTENTS IS NOT PERMITTED WITHOUT EXPRESSED WRITTEN AUTHORITY. OFFENDERS WILL BE LIABLE FOR ALL DAMAGES. ALL RIGHTS, INCLUDING RIGHTS CREATED BY REGISTERED PATENT(S) GRANTED FOR A UTILITY MODEL OR DESIGN, ARE RESERVED.				CHANGES TO THIS DRAWING MUST BE DONE ONLY IN CAD		PAPER SIZE <b>A3</b>	
APPLICABLE SPEC. #				FINISH			
				DIMENSIONS APPLY		PLATING	
				TOLERANCE UNLESS SPECIFIED OTHERWISE		SCALE	
				DIMENSIONS IN MM		WEIGHT <b>Ca. 34g</b>	
				DATE		NAME	
B1	ECO-14-008934	12JUN2014	LSand	DWN.	2006-06-06	PART NAME <b>MINI RELAY B</b>	
B	ECO-12-015770	30AUG2012	A.P.	APP.		<b>CHANGEOVER 12V 20/30A</b>	
A4	INITIAL VERSION	2007-10-18	PTom	REV.		MATERIAL	
A3	---	2007-03-01	--	LOCATION	PE EVORA	PART NO.	
A2	---	2007-01-31	--			<b>V23234-A1001-X036</b>	
A1	---	2006-11-13	--			SHT.	
A1	---	2006-10-30	--			<b>2</b>	
REV.	CHANGE ORDER	DATE	APP.	CUSTOMER DRAWING		OF 2	

## X-ON Electronics

Largest Supplier of Electrical and Electronic Components

*Click to view similar products for [Automotive Relays](#) category:*

*Click to view products by [TE Connectivity](#) manufacturer:*

Other Similar products are found below :

[7-1414968-8](#) [7-1617345-6](#) [9-1617516-5](#) [G5CE1ASIDC12](#) [1393204-2](#) [1393302-3](#) [13Z99A115-0074](#) [1432872-1](#) [AR4-15F11-S01](#) [AR4-15H11](#)  
[1617057-2](#) [1617058-6](#) [1617518-5](#) [2-1617057-2](#) [2-1617057-6](#) [2-1617058-3](#) [CB1F-M-12V-H15](#) [898H-1AH-D-001-12VDC](#) [AR4-11F11](#)  
[AR4-15F11](#) [AR4-41F11](#) [24198-1](#) [4-1617057-0](#) [41FZ-200ACG-BSL](#) [5-1616920-2](#) [5-1617052-9](#) [5407-0011-HS](#) [CB1AF-M-12V-H59](#) [5-](#)  
[1617346-8](#) [103-1AH-C-12VDC](#) [V23134A1052X299](#) [6-1393302-1](#) [897H-1AH-D-R1-U01-12VDC](#) [FTR-P3CP024W1-06](#) [1-1617057-8](#) [3-](#)  
[1393305-1](#) [5436-0001-HS](#) [V23086-R1851-A502](#) [V23136-A0004-X075](#) [898H-1AH-D1SW-R1-12VDC](#) [RH4C1P2607](#) [RE031005](#)  
[V23134M0052G242](#) [1393204-1](#) [23234B0001X001-EV-144](#) [AZ979-1A-24D](#) [2-1904020-1](#) [V23134B0052C642](#) [V23134B0053C642](#) [V23234-](#)  
[A1001-X036](#)