

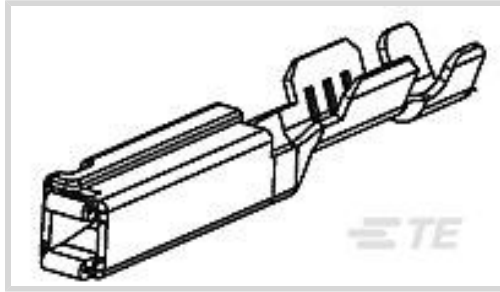

Terminals & Splices > Automotive Terminals > GET .64 CONNECTOR SYSTEM, RECEPT AND TAB



Terminal & Splice Type: **Receptacle**

Mating Tab Width: **1 mm [.039 in]**

Mating Tab Thickness: **.64 mm [.025 in]**

Terminal Transmits: **0 – 24 A (Low Power)**

Wire Size: **.22 – .35 mm²**

[All GET .64 CONNECTOR SYSTEM, RECEPT AND TAB \(29\)](#)

Features

Product Type Features

Receptacle Style	180°
Sealable	No
Primary Locking Feature	Clean Body
Wire Type	Copper

Contact Features

Typical Current Rating	9 A
Crimp Type	F-Crimp
Terminal & Splice Type	Receptacle
Mating Tab Width	1 mm [.039 in]
Mating Tab Thickness	.64 mm [.025 in]
Interface Plating	Tin (Sn)
Contact Termination Area Plating Material	Tin (Sn)

Termination Features

Termination Method	Crimp
--------------------	-------

Dimensions

Wire Size	.22 – .35 mm ²
Wire Size Search	.22 mm ² , .25 mm ² , .3 mm ² , .35 mm ²



Wire Insulation Diameter	1.2 – 1.4 mm [.043 – .065 in]
--------------------------	-------------------------------

Usage Conditions

Operating Temperature Range	-40 – 125 °C, -40 – 125 °C [-40 – 125 °F]
-----------------------------	---

Packaging Features

Packaging Method	Reel
Packaging Quantity	10000

Other

Terminal Transmits	0 – 24 A (Low Power)
--------------------	----------------------

Product Compliance

[For compliance documentation, visit the product page on TE.com>](#)

EU RoHS Directive 2011/65/EU	Compliant
EU ELV Directive 2000/53/EC	Compliant
China RoHS 2 Directive MIIT Order No 32, 2016	No Restricted Materials Above Threshold
EU REACH Regulation (EC) No. 1907/2006	Current ECHA Candidate List: JUN 2020 (209) Candidate List Declared Against: JAN 2020 (205) Does not contain REACH SVHC
Halogen Content	Low Halogen - Br, Cl, F, I < 900 ppm per homogenous material. Also BFR/CFR/PVC Free
Solder Process Capability	Not applicable for solder process capability

Product Compliance Disclaimer

This information is provided based on reasonable inquiry of our suppliers and represents our current actual knowledge based on the information they provided. This information is subject to change. The part numbers that TE has identified as EU RoHS compliant have a maximum concentration of 0.1% by weight in homogenous materials for lead, hexavalent chromium, mercury, PBB, PBDE, DBP, BBP, DEHP, DIBP, and 0.01% for cadmium, or qualify for an exemption to these limits as defined in the Annexes of Directive 2011/65/EU (RoHS2). Finished electrical and electronic equipment products will be CE marked as required by Directive 2011/65/EU. Components may not be CE marked. Additionally, the part numbers that TE has identified as EU ELV compliant have a maximum concentration of 0.1% by weight in homogenous materials for lead, hexavalent chromium, and mercury, and 0.01% for cadmium, or qualify for an exemption to these limits as defined in the Annexes of Directive 2000/53/EC (ELV). Regarding the REACH Regulation, the information TE provides on SVHC in articles for this part number is based on the latest European Chemicals Agency (ECHA) 'Guidance on requirements for substances in articles' posted at this URL: <https://echa.europa.eu/guidance-documents/guidance-on-reach>

Compatible Parts



TE Model / Part # 2305570-1
TERMINAL CUTTER, SIDE FEED



TE Model / Part # CAT-G3353-CH8172
GET .64 CONNECTOR SYSTEM,
CONNECTOR HSG



TE Model / Part # CAT-M8793-CH8172
MQS, CONNECTOR HOUSING



TE Model / Part # CAT-G3353-T273
GET .64 CONNECTOR SYSTEM,
RECEPT AND TAB



TE Model / Part # 2151540-1
OCEAN_2.0_APPLICATOR-S-
055F0700



TE Model / Part # 2151540-2
OCEAN_2.0_APPLICATOR-S-
055F0700



KIT REPRESENTATION ONLY

TE Model / Part # 7-2151540-7
OCEAN_2.0_SPARE_PART_KIT-
055F0700



TE Model / Part # 2203663-6
2X9 SEALED PLUG ASSY KEY B



TE Model / Part # 1411001-7
2x4 SEALED HARN ASSY W/O CPA



TE Model / Part # 1411001-6
SEALED HARN ASSY W CPA KEY B



TE Model / Part # 1-1419168-1
MARKET 1X6 FEMALE SEALED



TE Model / Part # 2272006-1
Plug Assembly, 20P GET, w/o CPA



TE Model / Part # 2-2151540-1
OCEAN_2.0_APPLICATOR-S-
055F0700



TE Model / Part # 2-2151540-2
OCEAN_2.0_APPLICATOR-S-
055F0700



TE Model / Part # 1924639-2
1X8 FEMALE ASSY KEY D, LP LATC



TE Model / Part # 3-2151540-2
OCEAN_2.0_APPLICATOR-S-
055F0700

Also in the Series | **Get .64 Connector System**



Automotive Connector Caps & Covers
(7)



Automotive Headers(2)



Automotive Housings(120)



Automotive Terminals(29)

Customers Also Bought



TE Model / Part #1394512-1
EINZELLEITDICHTG,BL



TE Model / Part #1393366-1
GET .64 CONNECTOR SYSTEM,
RECEPT AND TAB



TE Model / Part #1534100-1
MOS, CONNECTOR HOUSING



TE Model / Part #953381-1
LOCKING DEVICE FOR 6W MOS

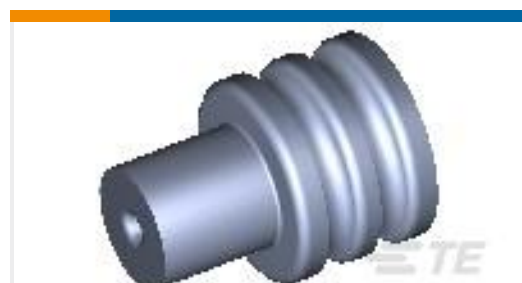

TE Model / Part #963294-1
SINGLE WIRE SEAL INSULATION DI



TE Model / Part #967067-2
MOS EINZELLEITDICHT

Documents

Product Drawings

[V23540X7000Y 11=GET-FEM TERM S](#)

English

[V23540X7000Y 11=GET-FEM TERM S](#)

English

CAD Files

[3D PDF](#)

3D

Customer View Model

[ENG_CVM_CVM_1393367-1_B.2d_dxf.zip](#)

English

Customer View Model

[ENG_CVM_CVM_1393367-1_B.3d_igs.zip](#)

English

Customer View Model

[ENG_CVM_CVM_1393367-1_B.3d_stp.zip](#)

English

By downloading the CAD file I accept and agree to the [Terms and Conditions](#) of use.

Datasheets & Catalog Pages

[GET 0.64 Interconnection System](#)

English

Product Specifications

[Application Specification](#)

German



Application Specification

English

Application Specification

English

Product Environmental Compliance

[MD_1393367-1_07032017952_dmtec](#)

English

[MD_1393367-1_07032017952_dmtec](#)

English

Instruction Sheets

UNSEALED GET/MCP 81/40 SLIDER LEVER TYPE CONNECTOR

Japanese

Instruction Sheet (non U.S.)

Japanese

X-ON Electronics

Largest Supplier of Electrical and Electronic Components

Click to view similar products for [Automotive Connectors](#) category:

Click to view products by [TE Connectivity](#) manufacturer:

Other Similar products are found below :

[003-018-000](#) [60403001](#) [60993906-B](#) [M902-2131](#) [M902-2161](#) [M902-2344](#) [72.330.1035.1](#) [73.353.4028.0](#) [F119300-B](#) [F166900](#) [F258300-B](#)
[F358300-B](#) [F407400](#) [F444110](#) [F487000](#) [F509500B-B](#) [827153-1](#) [8N1515-32-24P](#) [9-1326729-8](#) [925474-1](#) [928905-1](#) [964562-4](#) [968782-1](#)
[GT17SA-8DS-HU](#) [98891-1012](#) [98947-1016](#) [12004147](#) [12004475-L](#) [12010290](#) [12010309-B](#) [12015454](#) [12020219-B](#) [12041318-B](#) [12052225-](#)
[L](#) [12052466](#) [12064869](#) [12004327-B](#) [12015308](#) [12015384](#) [12015909](#) [1-21030-1](#) [12041254](#) [12041318](#) [12047946-B](#) [12047957](#) [12047957-L](#)
[12059473](#) [12066261](#) [12110546](#) [12110546-B](#)