

**DMC-MR 30-23 AX**

Dimensions externes suivant EN4165-003  
External dimensions according to EN4165-003

EX

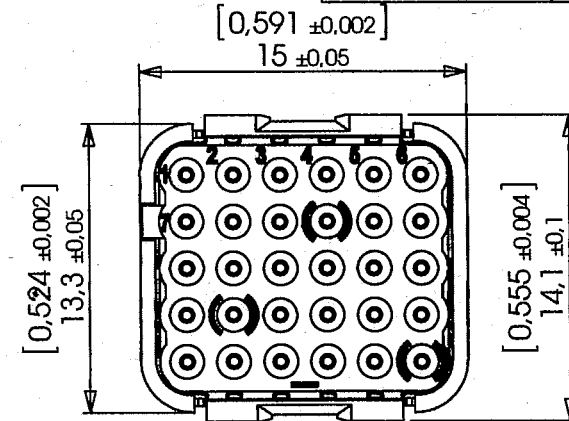
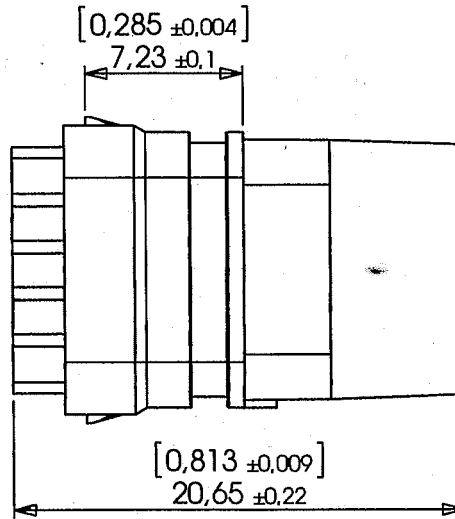
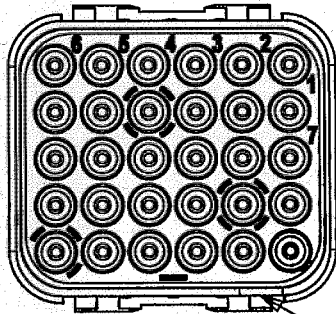

X: Codage A,B,C,D,E,F,G,H ou N  
X: Keying A,B,C,D,E,F,G,H, or N  
(1)

**CARACTERISTIQUES:**

Température d'utilisation: -55°C à +175°C  
Matériaux: Thermoplastique, silicone fluoré violet  
Masse: 3,4g Maxi  
Dimensions: Millimètres (pouces)  
Contacts:  
- Mâle #23 câble cuivre - 182-4043-23  
Outil insertion/extraction contacts:  
-M81969/14-01

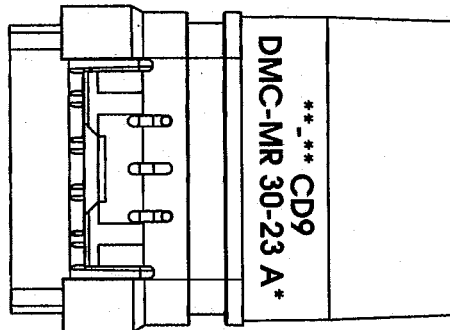

**CHARACTERISTICS:**

Operating temperature range: -55°C to +175°C  
Materials: Thermoplastic and purple fluorosilicone  
Weight: 3,4g Maxi  
Dimensions: Millimeters [Inches]  
Contacts:  
- Pin #23 for copper cable - 182-4043-23  
Contacts insertion/extraction tool:  
-M81969/14-01

Module livré sans contact mâle / Module delivered without pin contact

b	27/04/15	OE230415	SERIE DMC-M	DATE 04/03/2013	VISA Creation Created	VISA Approval Approval
a	24/12/14	UPDATE				
Revision	Date	Observations	DESIGNATION	REF :		
			Module femelle pour contact mâle #23 Socket module for #23 pin contact	P/N: DMC-MR 30-23 AX (1)		
ORIGINE :		DE156/13				VERSION   REVISION
ORIGIN :						
<b>Connecteurs Electriques Deutsch</b> 17, rue LAVOISIER - BP 117 - 27091 EVREUX CEDEX 09 - FRANCE			<b>FICHE TECHNIQUE</b> <b>TECHNICAL DATA SHEET</b>			204-19-C/01

## X-ON Electronics

Largest Supplier of Electrical and Electronic Components

*Click to view similar products for [Rectangular MIL Spec Connectors](#) category:*

*Click to view products by [TE Connectivity](#) manufacturer:*

Other Similar products are found below :

[006-1169-16](#) [CSR31343-0001-00000](#) [CSR31899-0001-00000](#) [CSR31900-0001-A0001](#) [CTJ-3D-05](#) [CTS-S16/16](#) [M55302/57A36X](#)  
[M55302/58-A70Y](#) [65002-062](#) [65008-D08](#) [CY4602-000](#) [732-8020-01](#) [732-8021-02 B](#) [77058-22-55PN](#) [81542-20](#) [86.030.0053.0](#) [1241346-1](#)  
[RM252-020-311-2900](#) [DMC-M 08-16 SNE](#) [1589051-4](#) [BACC65CAMA](#) [BACC65CAMN](#) [BACC65CP1PN](#) [BACI10BC1220PN](#) [EN4165A99-](#)  
[011NB](#) [18023-9](#) [HSB-D4S03DM222X](#) [2217548-1](#) [891-009-15SA2-BRT1T](#) [SIM2S100A](#) [1604996-2](#) [SMD25PN90L-4055](#) [220A012-25225-0](#)  
[22628-10-6P-791](#) [CSR31343-0001-A0001](#) [CSR31899-0001-A0001](#) [CSR31900-0001-00000](#) [33526M11-08PD](#) [RE04-212S](#) [CTD160E01F-](#)  
[6148](#) [CTJ112E03B](#) [CTJ122E02D-8000](#) [CTJ-3D-12](#) [CTJ920E06N-513](#) [CTJ920E12N-513](#) [CTL-16-090](#) [CTR06-5100SY](#) [M55302/63A20H](#)  
[M55302/66-30H](#) [M81714/63-22S W/PLUGS INS](#)