

CL21 型金属化聚酯薄膜电容器

Metallized Polyester Film Capacitor Type CL21

■ 特点 Features

- 体积小容量大 具有自愈性能 Small size, large capacitance values; self-healing property

■ 用途 Applications

- 直流和 VHF 级信号隔直，旁路和耦合电路 Blocking, by-pass and coupling of DC and signals to VHF range
- 用于逻辑和时间电路 Logic and timing circuit
- 轻值脉冲形成网络 Light duty pulse forming network
- 广泛用于滤波，降噪和低脉动电路中 Widely applied to filtration, noise suppression and low pulsating circuits

■ 技术规范 Technical Specifications

- 引用标准 Reference Standard: GB7335-87
- 额定值和特性 Ratings and characteristics
- 气候类别 Climate category: 55/085/21
- 额定电压 Rated voltage: 50/100/160V, 250V, 400V, 630V
- 电容量范围 Capacitance range: 0.01~4.7μF
- 电容量偏差 Capacitance tolerance: ±5% (J)、±10% (K)、±20% (M)
- 损耗角正切: $\leq 10 \times 10^{-3}$ (20°C, 1kHz)
- 耐电压 voltage proof: 1.75U_r(5s)
- 绝缘电阻 Withstand voltage: Cr \leq 0.33μF, U_R \leq 100V, R \geq 20000MΩ; U_R>100V, R \geq 40000MΩ

$$Cr > 0.33\mu F, U_R \leq 100V, RC \geq 6600S; U_R > 100V, RC \geq 12000S$$

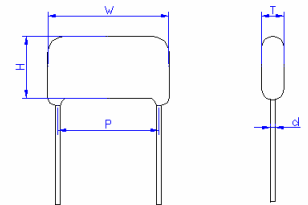

● 结构 Construction

- 金属化聚酯薄膜，环氧树脂包封 Metallized Polyester film, flame-retardant epoxy resin coating

■ 外形尺寸 Dimensions(mm)

| 电容量(μF) | 50V/100V/160V | | | | | 250V | | | | | 400V | | | | | 630V | | | | |
|---------|---------------|------|------|-----|-----|------|------|------|-----|-----|------|------|------|-----|-----|------|------|------|-----|-----|
| | Wmax | Hmax | Tmax | p±1 | d | Wmax | Hmax | Tmax | p±1 | d | Wmax | Hmax | Tmax | p±1 | d | Wmax | Hmax | Tmax | p±1 | d |
| 0.015 | 10 | 7.7 | 4.6 | 7.5 | 0.6 | 10 | 7.7 | 4.6 | 7.5 | 0.6 | 10 | 7.7 | 4.6 | 7.5 | 0.6 | 10 | 7.7 | 4.6 | 7.5 | 0.6 |
| 0.022 | 10 | 7.7 | 4.6 | 7.5 | 0.6 | 10 | 7.7 | 4.6 | 7.5 | 0.6 | 10 | 7.7 | 4.6 | 7.5 | 0.6 | 10 | 7.7 | 4.6 | 7.5 | 0.6 |
| 0.033 | 10 | 7.9 | 4.7 | 7.5 | 0.6 | 10 | 7.9 | 4.7 | 7.5 | 0.6 | 10 | 7.9 | 4.7 | 7.5 | 0.6 | 10 | 7.9 | 4.7 | 7.5 | 0.6 |
| 0.047 | 10 | 8 | 4.6 | 7.5 | 0.6 | 10 | 8 | 4.6 | 7.5 | 0.6 | 10 | 8 | 4.6 | 7.5 | 0.6 | 10 | 8 | 4.6 | 7.5 | 0.6 |
| 0.068 | 10 | 8 | 4.6 | 7.5 | 0.6 | 10 | 8 | 4.6 | 7.5 | 0.6 | 10 | 8 | 4.6 | 7.5 | 0.6 | 10 | 9 | 6 | 7.5 | 0.6 |
| 0.1 | 10 | 8.1 | 4.8 | 7.5 | 0.6 | 10 | 8.1 | 4.8 | 7.5 | 0.6 | 10 | 8.5 | 5 | 7.5 | 0.6 | 13 | 10 | 6.5 | 7.5 | 0.6 |
| 0.15 | 10 | 8.6 | 4.8 | 7.5 | 0.6 | 10 | 8.6 | 4.8 | 7.5 | 0.6 | 13 | 10 | 5 | 10 | 0.6 | 13 | 11 | 8 | 10 | 0.6 |
| 0.22 | 10 | 9 | 5 | 7.5 | 0.6 | 13 | 9 | 5 | 10 | 0.6 | 13 | 11 | 6 | 10 | 0.6 | 18 | 11.5 | 6.5 | 15 | 0.8 |
| 0.33 | 10 | 8.5 | 5 | 7.5 | 0.6 | 13 | 10 | 6 | 10 | 0.6 | 18 | 11 | 6 | 15 | 0.8 | 18 | 13 | 8 | 15 | 0.8 |
| 0.47 | 10 | 9 | 5.5 | 7.5 | 0.6 | 18 | 10.5 | 5.5 | 15 | 0.8 | 18 | 12 | 6 | 15 | 0.8 | 18 | 14 | 9 | 15 | 0.8 |
| 0.68 | 13 | 10 | 5.5 | 10 | 0.6 | 18 | 11.5 | 6.5 | 15 | 0.8 | 18 | 14 | 9 | 15 | 0.8 | 23 | 15 | 8.5 | 20 | 0.8 |
| 1.0 | 13 | 11 | 6.5 | 10 | 0.6 | 18 | 13 | 8 | 15 | 0.8 | 18 | 16 | 11 | 15 | 0.8 | | | | | |
| 1.5 | 18 | 11 | 6 | 15 | 0.8 | 18 | 14.5 | 10 | 15 | 0.8 | 23 | 17 | 10 | 20 | 0.8 | | | | | |
| 2.2 | 18 | 12 | 7 | 15 | 0.8 | 18 | 16.5 | 12 | 15 | 0.8 | 23 | 19 | 12.5 | 20 | 0.8 | | | | | |

注：表中以外的规格和尺寸，可以商谈。

Note: Other specifications and sizes out of the table are negotiable.

X-ON Electronics

Largest Supplier of Electrical and Electronic Components

Click to view similar products for [Film Capacitors](#) category:

Click to view products by [Tongfeng](#) manufacturer:

Other Similar products are found below :

[F339X134748MIP2T0](#) [F450KG153J250ALH0J](#) [750-1018](#) [FKP1-1500160010P15](#) [FKP1R031007D00JYSD](#) [FKP1R031507E00JYSD](#)
[FKP1U024707E00KYSD](#) [82DC4100CK60J](#) [82EC1100DQ50K](#) [PFR5101J100J11L16.5TA18](#) [PME261JB5220KR19T0](#) [A451GK223M040A](#)
[A561ED221M450A](#) [QXJ2E474KTPT](#) [QXL2B333KTPT](#) [R49AN347000A1K](#) [EEC2G505HQA406](#) [B25668A6676A375](#) [B25673A4282E140](#)
[BFC233868148](#) [BFC2370GC222](#) [C3B2AD44400B20K](#) [C4ASWBU3220A3EK](#) [CB027C0473J--](#) [CB177I0184J--](#) [CB182K0184J--](#) [23PW210](#)
[950CQW5H-F](#) [SBDC3470AA10J](#) [SCD105K122A3-22](#) [2N3155](#) [A571EH331M450A](#) [FKP1-2202KV5P15](#) [FKS3-680040010P10](#)
[QXL2E473KTPT](#) [445450-1](#) [B25669A3996J375](#) [46KI322000M1M](#) [46KR415050M1K](#) [4BSNBX4100ZBFJ](#) [MKP383510063JKP2T0](#)
[MKPY2-.02230020P15](#) [MKT 1813-368-015](#) [4055292001](#) [46KN410000N1K](#) [EEC2E106HQA405](#) [EEC2G205HQA402](#) [EEC2G805HQA415](#)
[P409CP224M250AH470](#) [82EC2150DQ50K](#)