

CL21 型金属化聚酯薄膜电容器

Metallized Polyester Film Capacitor Type CL21

■ 特点 Features

- 体积小容量大 具有自愈性能 Small size, large capacitance values; self-healing property

■ 用途 Applications

- 直流和 VHF 级信号隔直，旁路和耦合电路 Blocking, by-pass and coupling of DC and signals to VHF range
- 用于逻辑和时间电路 Logic and timing circuit
- 轻值脉冲形成网络 Light duty pulse forming network
- 广泛用于滤波，降噪和低脉动电路中 Widely applied to filtration, noise suppression and low pulsating circuits

■ 技术规范 Technical Specifications

- 引用标准 Reference Standard: GB7335-87
- 额定值和特性 Ratings and characteristics
- 气候类别 Climate category: 55/085/21
- 额定电压 Rated voltage: 50/100/160V, 250V, 400V, 630V
- 电容量范围 Capacitance range: 0.01~4.7μF
- 电容量偏差 Capacitance tolerance: ±5% (J)、±10% (K)、±20% (M)
- 损耗角正切: $\leq 10 \times 10^{-3}$ (20°C, 1kHz)
- 耐电压 voltage proof: 1.75U_r(5s)
- 绝缘电阻 Withstand voltage: Cr \leq 0.33μF, U_R \leq 100V, R \geq 20000MΩ; U_R>100V, R \geq 40000MΩ

$$Cr > 0.33\mu F, U_R \leq 100V, RC \geq 6600S; U_R > 100V, RC \geq 12000S$$

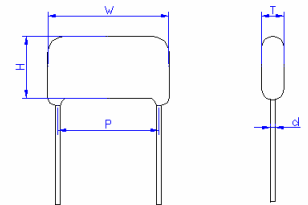

● 结构 Construction

- 金属化聚酯薄膜，环氧树脂包封 Metallized Polyester film, flame-retardant epoxy resin coating

■ 外形尺寸 Dimensions(mm)

电容量(μF)	50V/100V/160V					250V					400V					630V				
	Wmax	Hmax	Tmax	p±1	d	Wmax	Hmax	Tmax	p±1	d	Wmax	Hmax	Tmax	p±1	d	Wmax	Hmax	Tmax	p±1	d
0.015	10	7.7	4.6	7.5	0.6	10	7.7	4.6	7.5	0.6	10	7.7	4.6	7.5	0.6	10	7.7	4.6	7.5	0.6
0.022	10	7.7	4.6	7.5	0.6	10	7.7	4.6	7.5	0.6	10	7.7	4.6	7.5	0.6	10	7.7	4.6	7.5	0.6
0.033	10	7.9	4.7	7.5	0.6	10	7.9	4.7	7.5	0.6	10	7.9	4.7	7.5	0.6	10	7.9	4.7	7.5	0.6
0.047	10	8	4.6	7.5	0.6	10	8	4.6	7.5	0.6	10	8	4.6	7.5	0.6	10	8	4.6	7.5	0.6
0.068	10	8	4.6	7.5	0.6	10	8	4.6	7.5	0.6	10	8	4.6	7.5	0.6	10	9	6	7.5	0.6
0.1	10	8.1	4.8	7.5	0.6	10	8.1	4.8	7.5	0.6	10	8.5	5	7.5	0.6	13	10	6.5	7.5	0.6
0.15	10	8.6	4.8	7.5	0.6	10	8.6	4.8	7.5	0.6	13	10	5	10	0.6	13	11	8	10	0.6
0.22	10	9	5	7.5	0.6	13	9	5	10	0.6	13	11	6	10	0.6	18	11.5	6.5	15	0.8
0.33	10	8.5	5	7.5	0.6	13	10	6	10	0.6	18	11	6	15	0.8	18	13	8	15	0.8
0.47	10	9	5.5	7.5	0.6	18	10.5	5.5	15	0.8	18	12	6	15	0.8	18	14	9	15	0.8
0.68	13	10	5.5	10	0.6	18	11.5	6.5	15	0.8	18	14	9	15	0.8	23	15	8.5	20	0.8
1.0	13	11	6.5	10	0.6	18	13	8	15	0.8	18	16	11	15	0.8					
1.5	18	11	6	15	0.8	18	14.5	10	15	0.8	23	17	10	20	0.8					
2.2	18	12	7	15	0.8	18	16.5	12	15	0.8	23	19	12.5	20	0.8					

注：表中以外的规格和尺寸，可以商谈。

Note: Other specifications and sizes out of the table are negotiable.

X-ON Electronics

Largest Supplier of Electrical and Electronic Components

Click to view similar products for [Film Capacitors](#) category:

Click to view products by [Tongfeng](#) manufacturer:

Other Similar products are found below :

[F339X134748MIP2T0](#) [F450KG153J250ALH0J](#) [750-1018](#) [FKP1-1500160010P15](#) [FKP1R031007D00JYSD](#) [FKP1R031507E00JYSD](#)
[FKP1U024707E00KYSD](#) [82DC4100CK60J](#) [82EC1100DQ50K](#) [PFR5101J100J11L16.5TA18](#) [PME261JB5220KR19T0](#) [A451GK223M040A](#)
[A561ED221M450A](#) [QXJ2E474KTPT](#) [QXL2B333KTPT](#) [R49AN347000A1K](#) [EEC2G505HQA406](#) [B25668A6676A375](#) [B25673A4282E140](#)
[BFC233868148](#) [BFC2370GC222](#) [C3B2AD44400B20K](#) [C4ASWBU3220A3EK](#) [CB027C0473J--](#) [CB177I0184J--](#) [CB182K0184J--](#) [23PW210](#)
[950CQW5H-F](#) [SBDC3470AA10J](#) [SCD105K122A3-22](#) [2N3155](#) [A571EH331M450A](#) [FKP1-2202KV5P15](#) [FKS3-680040010P10](#)
[QXL2E473KTPT](#) [445450-1](#) [B25669A3996J375](#) [46KI322000M1M](#) [46KR415050M1K](#) [4BSNBX4100ZBFJ](#) [MKP383510063JKP2T0](#)
[MKPY2-.02230020P15](#) [MKT 1813-368-015](#) [4055292001](#) [46KN410000N1K](#) [EEC2E106HQA405](#) [EEC2G205HQA402](#) [EEC2G805HQA415](#)
[P409CP224M250AH470](#) [82EC2150DQ50K](#)