

N-73A

Electrical Specifications (@25°C)

1. Maximum Power: 150 VA
2. Input Voltage: 115V @ 50/60Hz
3. Output Voltage:
 - Series: 230V
 - Parallel: 115V
4. Full Secondary Load: 0.65 Amps RMS
5. Voltage Regulation: 5 % TYP @ full load to no load

Description:

The N-73A is a power transformer for isolating equipment from direct connection to the powerline. The primary and secondary coils are concentrically wound providing excellent magnetic coupling. Having good magnetic coupling between windings helps reduce leakage flux and phase shift.

Safety:

These units are designed with 1500V isolation between winding to winding and between winding and core. Materials and construction are rated for Class B insulation system.

Dimensions: Unit: In inches

A	B	C	D	E
3.875	3.281	3.625	2.50	2.750

Weight: 7.0 Lbs.

Mounting Holes: .375 x .187"

Connections: 10.0±1" leads, 0.250±0.062" Skin & Tin

Schematic:

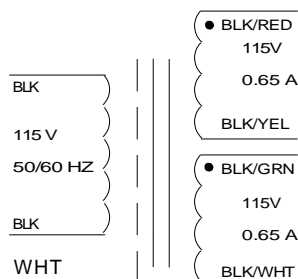

INPUT – Between BLK and BLK

OUTPUT: Series: JUMPER BLK/YEL to BLK/GRN. Output between BLK/RED and BLK/WHT, Parallel: JUMPER BLK/RED to BLK/GRN and BLK/YEL to BLK/WHT. Output between BLK/RED and BLK/YEL or BLK/GRN and BLK/WHT.

SHIELD: WHT

RoHS Compliance: As of manufacturing date February 2016, all standard products meet the requirements of 2015/863/EU, known as the RoHS 3 initiative.

* Upon printing, this document is considered "uncontrolled". Please contact Triad Magnetics' website for the most current version.

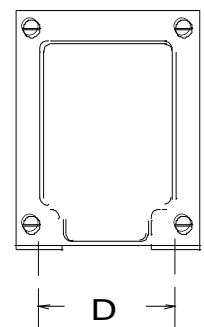
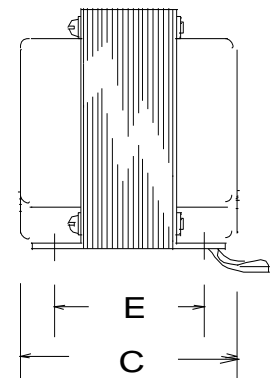
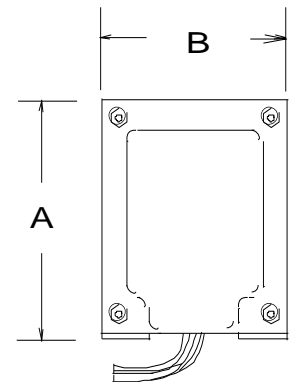

X-ON Electronics

Largest Supplier of Electrical and Electronic Components

Click to view similar products for [Power Transformers](#) category:

Click to view products by [Triad](#) manufacturer:

Other Similar products are found below :

[ET-030A](#) [F-102X](#) [F-120X](#) [F-14X-1](#) [F-181U](#) [F-18A](#) [F-199U](#) [F-19X](#) [F-202U](#) [F-204U](#) [F-206U](#) [F-227X](#) [F-238U](#) [F-239U-1](#) [F-23U](#) [F24-250-B](#)
[F-242U](#) [F-245U](#) [F-264U](#) [F-265U](#) [F-267U](#) [F-281U](#) [F-283U](#) [F-290X](#) [F-295Z](#) [F-296Z](#) [F-298Z](#) [F-3143P](#) [F-3298Z](#) [F-33U](#) [F-346X](#) [F-35U](#) [F-](#)
[364U](#) [F-392A](#) [F-395X](#) [F-397U](#) [F-412X](#) [F-47U](#) [F-55X-1](#) [F-60U](#) [F-68U](#) [F-71U](#) [F-72Z](#) [F-74U](#) [F-83A](#) [F-84AC](#) [F-85U](#) [F-86U](#) [F-9U](#) [PCT-02](#)