

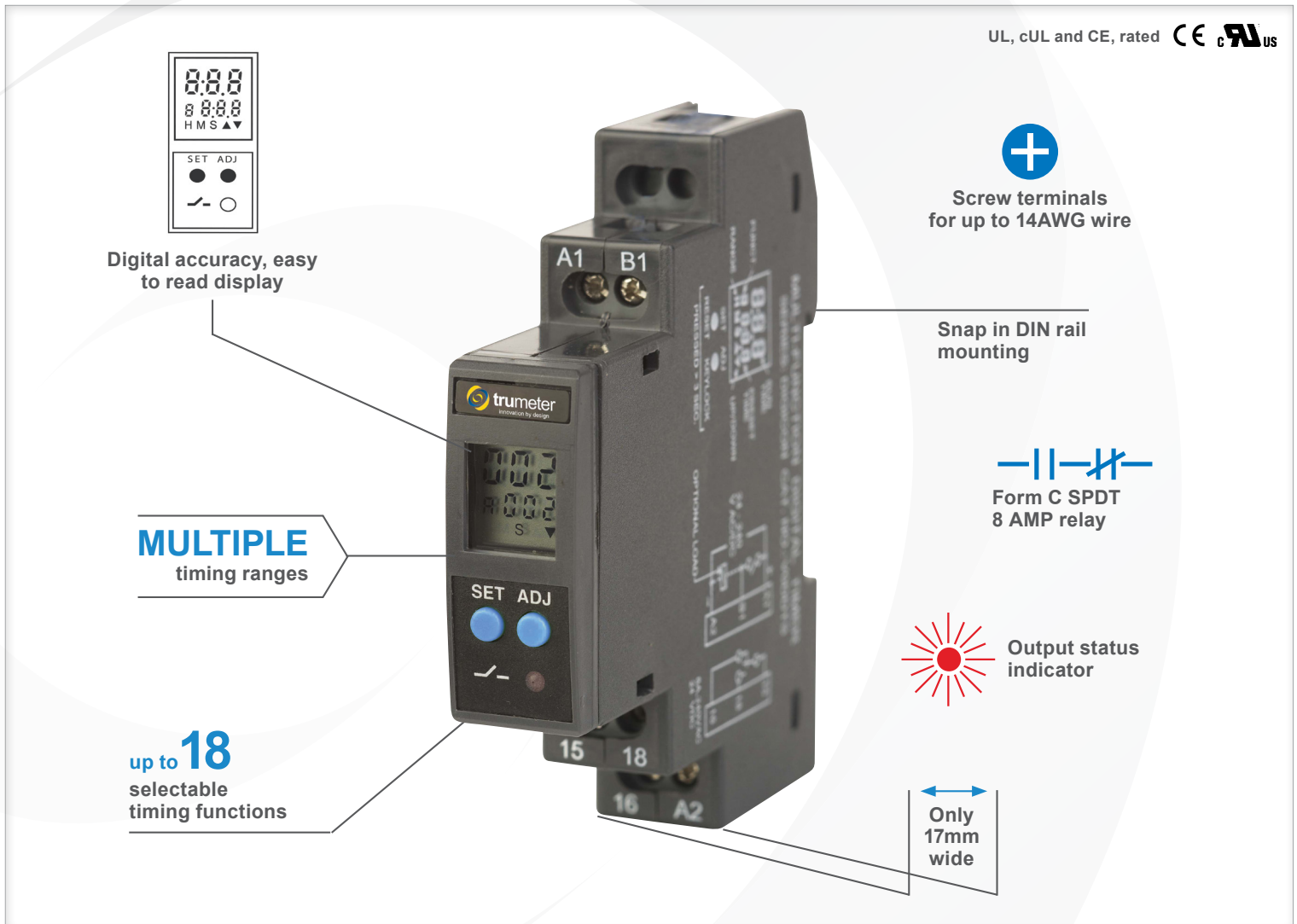

# Timing Control Made Easy

## 7954 and 7957 Multi-function time relays

Versatile and easy to program

### Programmable DIN Rail Time Relay



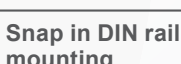

UL, cUL and CE, rated 

 Screw terminals for up to 14AWG wire

 Snap in DIN rail mounting

 Form C SPDT 8 AMP relay

 Output status indicator

 Only 17mm wide

Digital accuracy, easy to read display

**MULTIPLE** timing ranges

up to **18** selectable timing functions

Trumeter's new range of digital time relays offer 8 or 18 operating modes, easily configured on the 3 digit LCD display: a wide range of 0.1s - 999Hr to suit all applications; a clear indication of the relay status via the front panel LED; can accept a wide range of operating voltages for most installations. The keylock feature means settings cannot be tampered with, for 100% reliable operation.

Programming is retained during power shut down, the current timing is lost and will reset when power is back on.

## Key Features

### Features

- Compact 17.5mm wide DIN rail mountable
- 3 digit LCD for easy programming and run time indication
- Tamper proof with key lock feature
- Wide timing range: 0.1s - 999Hr
- Multi-function: 8 (7954) or 18 (7957) selectable operating modes
- Universal Voltage: 24 - 240VAC/VDC
- Option to select up/down timing
- CE, UL & cUL approved
- 8 AMP Form C (SPDT) Relay outputs

### Programmable:

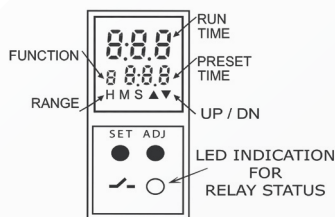

- Preset Time: The Timer Duration selected by the user
- Run Time: In Down counting ▼ mode it indicates the time remaining, while in Up counting ▲ mode indicates the elapsed time.
- Default Mode: Down counting ▼
- Up/Down ▼▲ blinks during the Timer Duration (T)

### Specifications:

- Input voltage range
- Relay Capability
- Temp range
- Time ranges

### Part Numbers

7954 8 Functions  
7957 18 Functions

### Operating modes

#### 7957

- ON Delay
- Repeat Cycle OFF/ON
- Repeat Cycle ON/OFF
- Impulse on Power Up
- Accumulative Delay on Signal
- Accumulative Delay on Inverted Signal
- Accumulative Impulse on Signal
- Signal ON Delay
- Inverted Signal ON Delay
- Signal OFF Delay
- Impulse ON/OFF
- Signal OFF/ON
- Leading Edge Impulse 1
- Leading Edge Impulse 2
- Trailing Edge Impulse 1
- Trailing Edge Impulse 2
- Delayed Impulse
- Inverted Signal ON Delay (Type 2)

#### 7954

- ON Delay
- Repeat Cycle OFF/ON
- Repeat Cycle ON/OFF
- Signal ON/OFF
- Signal OFF Delay
- Interval
- Signal OFF/ON
- One Shot Output

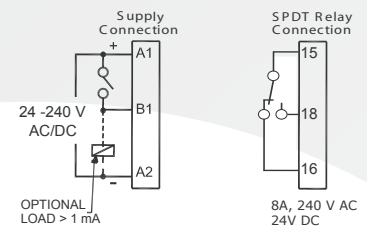

## Easy To Program & Install

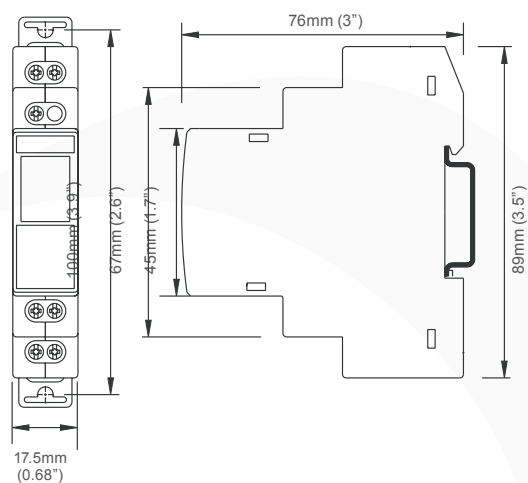

Full specifications available online [www.trumeter.com](http://www.trumeter.com)

## X-ON Electronics

Largest Supplier of Electrical and Electronic Components

*Click to view similar products for [Timers](#) category:*

*Click to view products by [Trumeter](#) manufacturer:*

Other Similar products are found below :

[H5S-WFB2D](#) [304E-007-A-00-PX](#) [305E-015-A-1-0-PX](#) [THR2U-110A](#) [81506944](#) [H7AN-RT6M AC100-240](#) [711-0131](#) [600DT-CU](#)  
[1SVR508130R0000](#) [1SVR730100R3100](#) [1SVR740040R3300](#) [H3Y-2 AC24 10S](#) [81503028](#) [722-0001](#) [732-0023](#) [80.01.0.240.0000T](#)  
[81.01.0.230.0000T](#) [12.A4.8.230.0010](#) [85.03.0.024.0000](#) [80.61.0.240.0000T](#) [LTR10](#) [SL555D](#) [SA555DR-HXY](#) [NE555P-HXY](#) [KG316T-D](#)  
[AC220V](#) [JSZ3A-E AC220V](#) [JSZ3A-F AC220V](#) [JSS48A-2Z AC/DC24V-48V](#) [JSZ3C-B AC220V](#) [JSZ6-2 10s DC24V](#) [JSZ6-2 60s DC24V](#)  
[JSZ3Y 30s AC220V](#) [JS14P 999s AC220V](#) [JS14P 99s AC220V](#) [KG10M AC220V](#) [JSZ3A-A AC220V](#) [JSZ3A-B DC24V](#) [JSS48A-2Z AC220V](#)  
[JSZ6-2 10s AC220V](#) [JSZ3F 30s AC220V](#) [JZF-07 AC220V](#) [JSZ3A-B AC220V](#) [JS14P 99s AC380V](#) [JSZ3F 60s AC220V](#) [710037400000004](#)  
[NKG3-M AC220V](#) [JSZ3A-D AC220V](#) [JSZ6-2 60s AC220V](#) [KG10D-1H AC220V](#) [JSS48A AC220V](#)