

Model 404 Series

Position Sensor

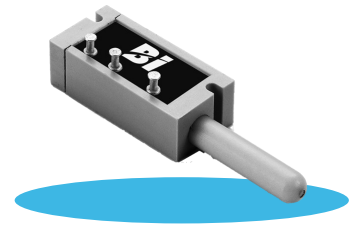

Features:

- Short travel (0.5 inches), linear motion with spring return
- Accurate position feedback
- Compact design for small spaces
- Conductive plastic technology
- Long life (5 million actuations)

Applications:

- Robotics
- Automotive
- Heavy equipment
- Industrial automation
- Wing flap position
- Pedal position
- Satellite dish
- Electro surgical equipment

Electrical

| | |
|---|---|
| Resistance range | 1K to 150K Ohms |
| Standard resistance tolerance | ±10% |
| Minimum practical resistance tolerance | ±5% |
| Independent linearity | ±1% |
| Minimum practical independent linearity | ±0.5% |
| Input voltage | 400 VDC maximum, not to exceed power rating |
| Dielectric strength | 1,000 V rms |
| Insulation resistance | 1,000 Megohms minimum |
| Output smoothness | 0.1% maximum at 10" to 18" per minute |
| Actual electrical travel | 0.50" ±0.015" (12.7 mm ±0.38 mm) |
| Electrical continuity travel | Within mechanical travel |
| End voltage | Maximum 0.5% of input voltage |
| Resolution | Essentially infinite |
| Temperature coefficient of resistance | -400 ppm/°C typical |
| Temperature coefficient of output voltage | ±10 ppm/°C typical |

Mechanical

| | |
|--------------------------|---|
| Torque mechanical travel | 0.56" ±0.015" (14.2 mm ±0.38 mm) |
| Actuating force | 14 oz. maximum, internal spring to return slider to extended position |
| Backlash | 0.003" maximum |
| Static stop strength | 20 lb. minimum |
| Body style | Rectangular |
| Termination style | Turret terminations |

General Note
TT Electronics reserves the right to make changes in product specification without notice or liability. All information is subject to TT Electronics' own data and is considered accurate at time of going to print.

TT Electronics | BI Technologies
413 Rood Rd, Suite 7
Calexico, CA 92231
Ph: +1 714 447 2345
www.ttelectronics.com/bi-technologies

Environmental (MIL-PRF-39023)

| | |
|-----------------------------|---|
| Operating temperature range | -40°C to +125°C dynamic, -55°C to +125°C static |
| Load life | 1 million shaft cycles at 0.25 Watts & 70°C, maximum 10% ΔR |

Ordering Information

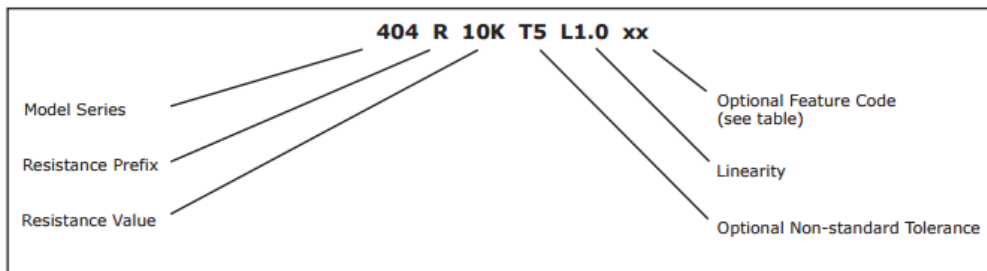

Circuit Diagram



Feature Codes

| | |
|----------------|----|
| Linearity Tape | LT |
|----------------|----|

Outline Drawing

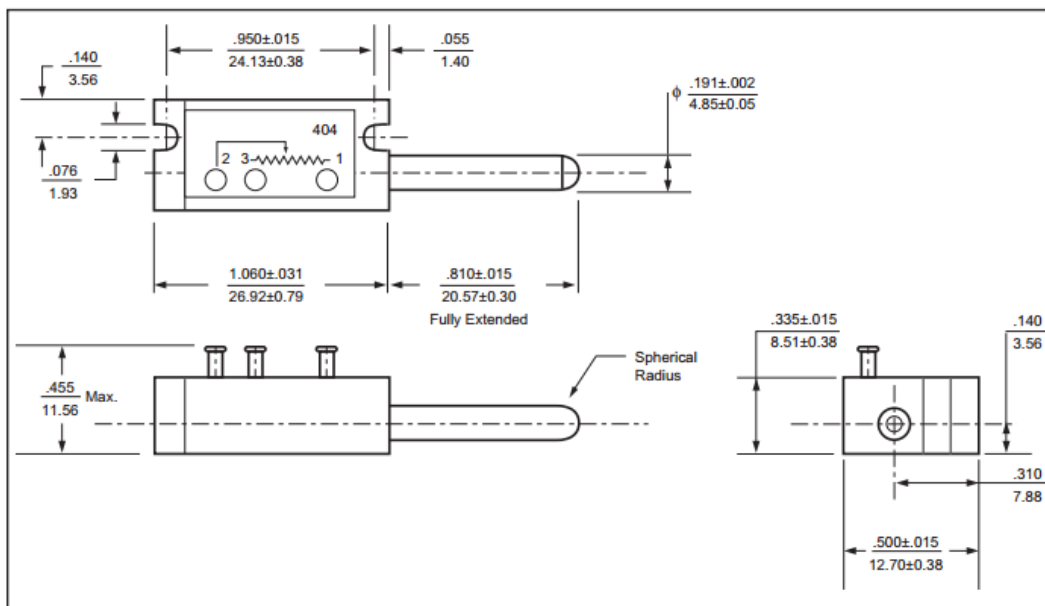

General Note

TT Electronics reserves the right to make changes in product specification without notice or liability. All information is subject to TT Electronics' own data and is considered accurate at time of going to print.

© TT electronics plc

TT Electronics | BI Technologies
 413 Rood Rd, Suite 7
 Calexico, CA 92231
 Ph: +1 714 447 2345
www.ttelectronics.com/bi-technologies

X-ON Electronics

Largest Supplier of Electrical and Electronic Components

Click to view similar products for [Linear Displacement Sensors](#) category:

Click to view products by [TT Electronics](#) manufacturer:

Other Similar products are found below :

[9810405](#) [9810421](#) [Z4D-F04A](#) [05282945-012](#) [67010001-000](#) [ZG-RPD11](#) [9810907](#) [9810908](#) [04-0760-0006](#) [LCPL Wiper-01](#) [04-0882-0237](#)
[02560412-006](#) [04-0847-0023](#) [02560618-000](#) [RP12250L223BWB](#) [RP12300L223BWB](#) [02560390-000](#) [02350512-000](#) [02560394-000](#)
[HMC1512-TR](#) [E3S-DBP21](#) [E3FC-RN21](#) [E3FC-DP23](#) [E3FC-DP13 2M](#) [LCPL400-10K](#) [060-3613-02](#) [F38000100](#) [F38000105](#) [F38000205](#)
[F38000206](#) [SPS-L035-LATS](#) [SPS-L075-HALS](#) [SPS-L225-HALS](#) [SPS-L225-HDLS](#) [02560407-000](#) [02560409-000](#) [02560405-000](#) [02560408-](#)
[000](#) [02560406-000](#) [02560542-000](#) [02560541-000](#) [02560545-000](#) [02560992-000](#) [05282946-006](#) [02560395-000](#) [02560389-000](#) [02560391-000](#)
[05282947-012](#) [02560398-000](#) [04560950-000](#)