

REV	LOCATIONS	DESCRIPTION	DATE	REVISER	APPD

SPECIFICATIONS

Electrical
 Current Rating: 0.5A AC(rms)/DC
 Voltage Rating: 50V AC(rms)/DC
 Contact Resistance: 50 mΩ Max.
 Insulation Resistance: 100 MΩ Min.
 Withstanding Voltage: 200V AC r.m.s
 Temperature Range—Operating: -35°C~+85°C
 Material and Plating
 Housing: LCP (UL 94V-0) Black
 Contacts: Phosphor Bronze/ Selective gold in contact area, matte tin on tail

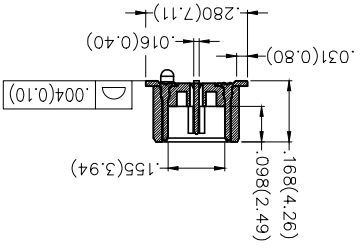

Circuits (n)	Part No.	Dimensions(in/mm)	
		A	B
60	FBB05007-M60S3XX3K6M	.787(20.00)	.728(18.48)
120	FBB05007-M120S3XX3K6M	1.575(40.00)	1.515(38.48)

Ordering Information

1 Category | 2 Series Number | 3 Distinction No. | 4 Type | 5 Circuits | 6 Entry Angle | 7 Plating | 8 Thickness of Plating | 9 Material-Resin | 10 Color-Resin | 11 Packaging

FBB 050 07 - M XX S 3 XX 3 K6 M

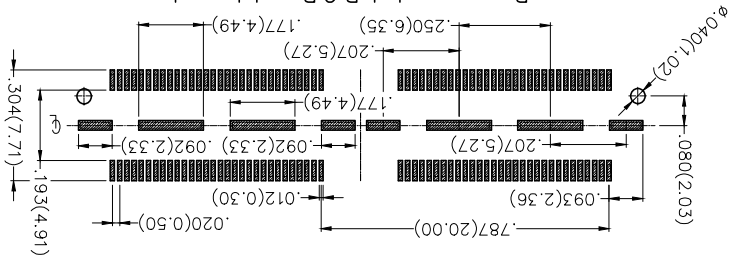
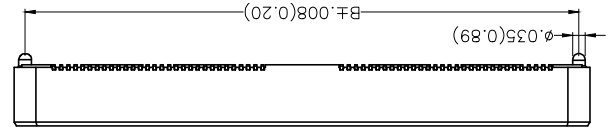
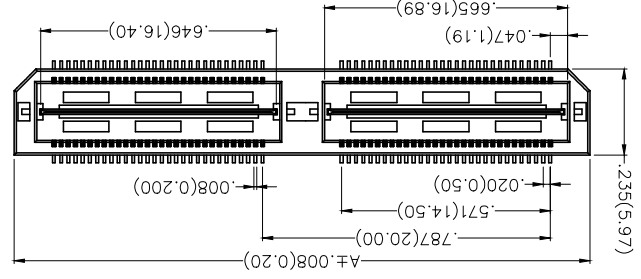

Recommended P.C.Board Layout
 General Tolerances: ±.002(0.05)

THIRD ANGLE PROJECTION	DESIGN UNITS Inch (metric)	SCALE 5:1	SIZE A4	GENERAL TOLERANCES (UNLESS SPECIFIED)		APPROVE BY		DATE		PART NO.	ITEM NO.	TITLE	Board to Board Pitch 0.5mm 180° Vertical (SMT)		REV 0	SHEET NO. 1/1
				X.±.012(0.30)	X.±.008(0.20)	DATE	DATE	DATE	DATE							
	X.±.012(0.30)	X.±.008(0.20)	X.±.006(0.15)	X.±.004(0.10)	FRANK	FRANK	21/DEC/18	21/DEC/18	FBB05007-MXXS3XX3K6M	FBB05007	Leader Of Industry	Board to Board Pitch 0.5mm 180° Vertical (SMT)				
	X.±.008(0.20)	X.±.006(0.15)	X.±.004(0.10)	X.±.003(0.075)	CHEERY	CHEERY	21/DEC/18	21/DEC/18	KATE	KATE	Electronics(SZ)CO.,LTD AND SHOULD NOT BE USED WITHOUT WRITTEN PERMISSION					

8

7

6

5

4

3

2

1

F

E

D

C

B

A

F

E

D

C

B

A

X-ON Electronics

Largest Supplier of Electrical and Electronic Components

Click to view similar products for [Board to Board & Mezzanine Connectors](#) category:

Click to view products by [TXGA](#) manufacturer:

Other Similar products are found below :

[10135583-642402LF](#) [89885-310LF](#) [589158040000018](#) [6-1393048-0](#) [68683-613](#) [MDF7-12DP-2.54DSA](#) [MDF7-18P-2.54DSA\(01\)](#) [MDF7-20DP-2.54DSA](#) [MDF7-26D-2.54DSA\(55\)](#) [MDF7-3P-2.54DSA\(01\)](#) [MDF7B-20P-2.54DSA\(01\)](#) [MDF7B-3P-2.54DSA\(55\)](#) [MDF7C-11P-2.54DSA\(55\)](#) [MDF7C-18P-2.54DSA\(55\)](#) [MDF7C-5P-2.54DSA\(01\)](#) [MDF7P-5P-2.54DSA\(55\)](#) [75234-0516](#) [FCN-230C068-11](#) [FCN-268F012-G/BD](#) [FCN-268F036-G/BD](#) [FCN-268M012-G/0D](#) [FCN-268M024-G/1D](#) [FCN-360C008-C](#) [FCN-360C040-C](#) [FCN-723J004/1](#) [MIS-048-01-F-D-DP-K](#) [832-10-034-10-001000](#) [93696-325LF](#) [11828-1FA](#) [AXK630345P](#) [18097-0013](#) [ICA-328STT](#) [2007042-2](#) [304400-2](#) [FCN-214Q030-G/0](#) [FCN-215Q040-G/0](#) [FCN-230C068-ESA](#) [FCN-234P048-G/0](#) [FCN-235D050-G/C](#) [FCN-360A3](#) [FCN-360C040-B](#) [210-93-314-41-105000](#) [2-22603-0](#) [379-064-521-202](#) [MDF7-12P-2.54DSA\(01\)](#) [MDF7-16P-2.54DS\(56\)](#) [MDF7-40DP-2.54DSA\(55\)](#) [MDF7-8P-2.54DSA\(55\)](#) [MDF7B-16P-2.54DSA\(55\)](#) [AXG720047](#)