

REV	LOCATIONS	DESCRIPTION	DATE	REVISER	APPD

SPECIFICATIONS

Electrical
 Current Rating: 0.5A AC(rms)/DC
 Voltage Rating: 50V AC(rms)/DC
 Contact Resistance: 50 mΩ Max.
 Insulation Resistance: 100 MΩ Min.
 Withstanding Voltage: 200V AC r.m.s
 Temperature Range—Operating: -35°C~+85°C
 Material and Plating
 Housing: LCP (UL 94V-0) Black
 Contacts: Phosphor Bronze/ Selective gold in contact area, matte tin on tail

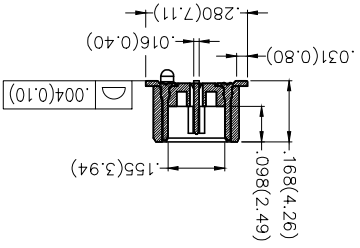

Circuits (n)	Part No.	Dimensions(in/mm)	
		A	B
60	FBB05007-M60S3XX3K6M	.787(20.00)	.728(18.48)
120	FBB05007-M120S3XX3K6M	1.575(40.00)	1.515(38.48)

Ordering Information

FBB 050 07 - M XX S 3 XX 3 K6 M

- Category
- Series Number
- Distinction No.
- Type
- Circuits
- Entry Angle
- Plating
- Thickness of Plating
- Material—Resin
- Color—Resin
- Packaging

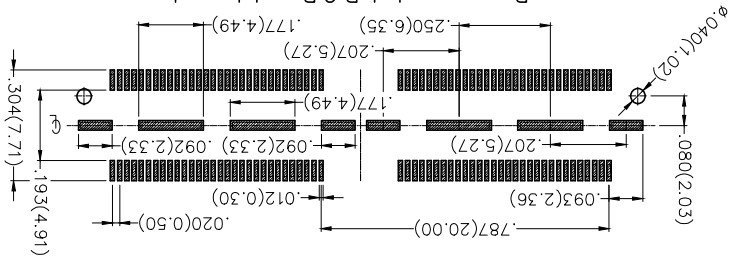
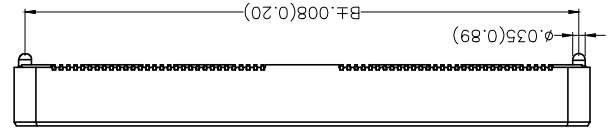
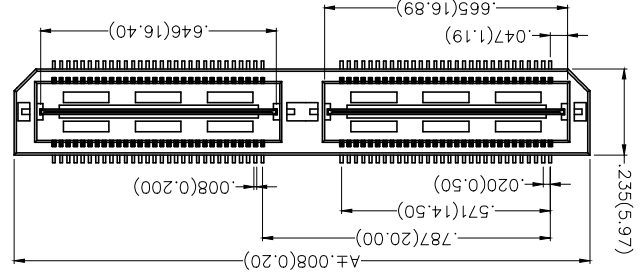

Recommended P.C.Board Layout
 General Tolerances: ±.002(0.05)

THIRD ANGLE PROJECTION	DESIGN UNITS Inch (metric)	SCALE 5:1	SIZE A4	GENERAL TOLERANCES (UNLESS SPECIFIED)		DATE 21/DEC/18	APPROVE BY FRANK	DATE 21/DEC/18	PART NO. FBB05007	ITEM NO. FBB05007	TITLE Board to Board	Board to Board Pitch 0.5mm 180° Vertical (SMT)		REV 0	SHEET NO. 1/1
				APPROVE BY FRANK	DATE 21/DEC/18							CHECKED BY CHERRY	DATE 21/DEC/18		
	X.±.012(0.30)	X.±.008(0.20)	X.±.006(0.15)	X.±.004(0.10)	X.±.05										



THIS DRAWING CONTAINS INFORMATION THAT IS PROPRIETARY TO TXGA INDUSTRIAL ELECTRONICS(SZ)CO.,LTD AND SHOULD NOT BE USED WITHOUT WRITTEN PERMISSION

X-ON Electronics

Largest Supplier of Electrical and Electronic Components

Click to view similar products for [Board to Board & Mezzanine Connectors](#) category:

Click to view products by [TXGA](#) manufacturer:

Other Similar products are found below :

[10135583-642402LF](#) [89885-310LF](#) [589158040000018](#) [6-1393048-0](#) [68683-613](#) [MDF7-12DP-2.54DSA](#) [MDF7-18P-2.54DSA\(01\)](#) [MDF7-20DP-2.54DSA](#) [MDF7-26D-2.54DSA\(55\)](#) [MDF7-3P-2.54DSA\(01\)](#) [MDF7B-20P-2.54DSA\(01\)](#) [MDF7B-3P-2.54DSA\(55\)](#) [MDF7C-11P-2.54DSA\(55\)](#) [MDF7C-18P-2.54DSA\(55\)](#) [MDF7C-5P-2.54DSA\(01\)](#) [MDF7P-5P-2.54DSA\(55\)](#) [75234-0516](#) [FCN-230C068-11](#) [FCN-268F012-G/BD](#) [FCN-268F036-G/BD](#) [FCN-268M012-G/0D](#) [FCN-268M024-G/1D](#) [FCN-360C008-C](#) [FCN-360C040-C](#) [FCN-723J004/1](#) [MIS-048-01-F-D-DP-K](#) [832-10-034-10-001000](#) [93696-325LF](#) [11828-1FA](#) [AXK630345P](#) [18097-0013](#) [ICA-328STT](#) [2007042-2](#) [304400-2](#) [FCN-214Q030-G/0](#) [FCN-215Q040-G/0](#) [FCN-230C068-ESA](#) [FCN-234P048-G/0](#) [FCN-235D050-G/C](#) [FCN-360A3](#) [FCN-360C040-B](#) [210-93-314-41-105000](#) [2-22603-0](#) [379-064-521-202](#) [MDF7-12P-2.54DSA\(01\)](#) [MDF7-16P-2.54DS\(56\)](#) [MDF7-40DP-2.54DSA\(55\)](#) [MDF7-8P-2.54DSA\(55\)](#) [MDF7B-16P-2.54DSA\(55\)](#) [AXG720047](#)