

REV	LOCATIONS	DESCRIPTION	DATE	REVISER	APPD

**SPECIFICATIONS**

Electrical  
 Current Rating: 2.0A(Circuits), 16A(Ground)  
 (One pin power per row)  
 Voltage Rating: 225V AC(rms)/DC  
 Contact Resistance: 15 mΩ Max.  
 Insulation Resistance: 5000 MΩ Min.  
 Withstanding Voltage: 675V AC r.m.s  
 Temperature Range—Operating: -55°C~+85°C  
 Material and Plating  
 Housing: LCP (UL 94V-0)  
 Contacts: Phosphor Bronze/ Selective gold in  
 contact area, matte tin on tail

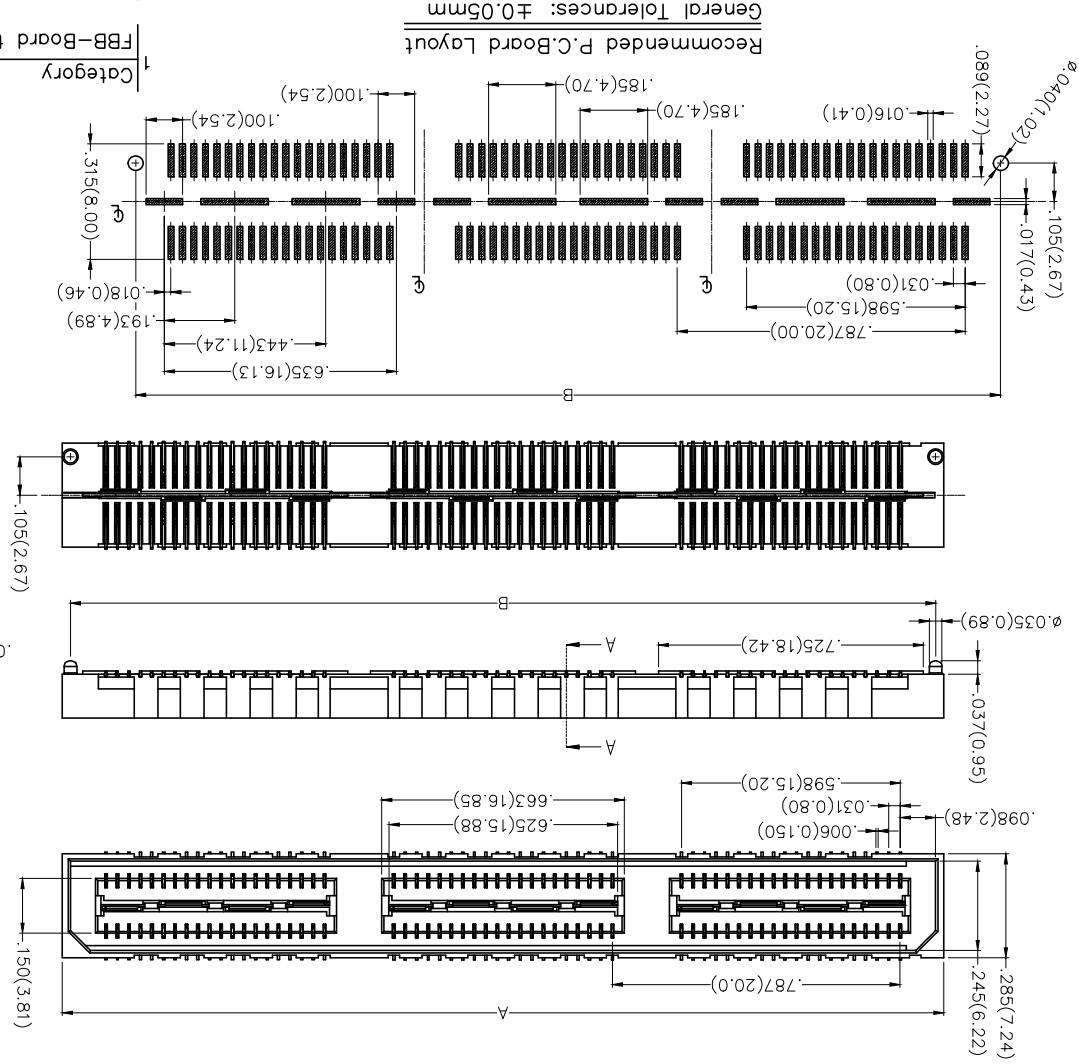
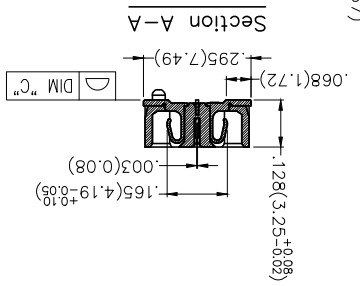

Recommended P.C.Board Layout  
 General Tolerances: ±0.05mm

**Ordering Information**

1 Category  
 2 Series Number  
 3 Distinction No.  
 4 Type  
 5 Circuits  
 6 Entry Angle  
 7 Plating  
 8 Thickness of Plating  
 9 Material—Resin  
 10 Color—Resin  
 11 Packaging

Circuits (n)	Part No.		Dimensions(in/mm)	
	A	B	C	
40	FBB08004-F40S3XX3K6M	.838(21.28)	.793(20.13)	.004(0.10)
80	FBB08004-F80S3XX3K6M	1.625(41.28)	1.580(40.13)	.004(0.10)
120	FBB08004-F120S3XX3K6M	2.413(61.28)	2.367(60.13)	.006(0.15)

THIRD ANGLE PROJECTION	DESIGN UNITS Inch (metric)	SCALE 5:1	SIZE A4	GENERAL TOLERANCES (UNLESS SPECIFIED)		APPROVE BY FRANK	DATE 21/DEC/18	PART NO.		ITEM NO.
				X.F.012(0.30)	X.F.7			FBB08004-FXXS3XX3K6M	FBB08004	
	X.F.008(0.20)	X.F.1	X.F.1	X.F.0.5	X.F.0.5	CHECKED BY CHERRY	DATE 21/DEC/18	TITLE Board to Board Vertical (SMT) Pitch 0.8mm 180° Vertical		REV 0
	X.F.004(0.10)	X.F.1	X.F.1	X.F.0.5	X.F.0.5	DRAWN BY KATE	DATE 21/DEC/18	THIS DRAWING CONTAINS INFORMATION THAT IS PROPRIETARY TO TXGA INDUSTRIAL ELECTRONICS(S)ZCO.,LTD AND SHOULD NOT BE USED WITHOUT WRITTEN PERMISSION		SHEET NO. 1/1



## X-ON Electronics

Largest Supplier of Electrical and Electronic Components

*Click to view similar products for [Board to Board & Mezzanine Connectors](#) category:*

*Click to view products by [TXGA](#) manufacturer:*

Other Similar products are found below :

[10135583-642402LF](#) [89885-310LF](#) [589158040000018](#) [6-1393048-0](#) [68683-613](#) [MDF7-12DP-2.54DSA](#) [MDF7-18P-2.54DSA\(01\)](#) [MDF7-20DP-2.54DSA](#) [MDF7-26D-2.54DSA\(55\)](#) [MDF7-3P-2.54DSA\(01\)](#) [MDF7B-20P-2.54DSA\(01\)](#) [MDF7B-3P-2.54DSA\(55\)](#) [MDF7C-11P-2.54DSA\(55\)](#) [MDF7C-18P-2.54DSA\(55\)](#) [MDF7C-5P-2.54DSA\(01\)](#) [MDF7P-5P-2.54DSA\(55\)](#) [75234-0516](#) [FCN-230C068-11](#) [FCN-268F012-G/BD](#) [FCN-268F036-G/BD](#) [FCN-268M012-G/0D](#) [FCN-268M024-G/1D](#) [FCN-360C008-C](#) [FCN-360C040-C](#) [FCN-723J004/1](#) [MIS-048-01-F-D-DP-K](#) [832-10-034-10-001000](#) [93696-325LF](#) [11828-1FA](#) [AXK630345P](#) [18097-0013](#) [ICA-328STT](#) [2007042-2](#) [304400-2](#) [FCN-214Q030-G/0](#) [FCN-215Q040-G/0](#) [FCN-230C068-ESA](#) [FCN-234P048-G/0](#) [FCN-235D050-G/C](#) [FCN-360A3](#) [FCN-360C040-B](#) [210-93-314-41-105000](#) [2-22603-0](#) [379-064-521-202](#) [MDF7-12P-2.54DSA\(01\)](#) [MDF7-16P-2.54DS\(56\)](#) [MDF7-40DP-2.54DSA\(55\)](#) [MDF7-8P-2.54DSA\(55\)](#) [MDF7B-16P-2.54DSA\(55\)](#) [AXG720047](#)