

REV	LOCATIONS	DESCRIPTION	DATE	REVISER	APPD

SPECIFICATIONS

Electrical

Current Rating: 3A AC(rms)/DC
Voltage Rating: 250V AC(rms)/DC
Contact Resistance: 25 mΩ Max
Insulation Resistance: 1000 MΩ Min
Withstanding Voltage: 500V AC r.m.s
Temperature Range-Operating: -55°C~+105°C

Material and plating

Housing: PBT UL 94V-0
Contact: Copper Alloy/
Selective gold in contact area, tin on tail
Shell: SPCC/ Nickel Plated
Board Lock: Copper Alloy/ Tin Plated
Screws: Copper Alloy/ Nickel Plated

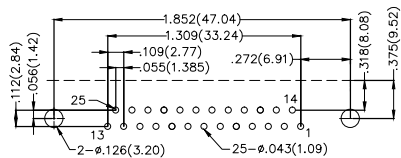
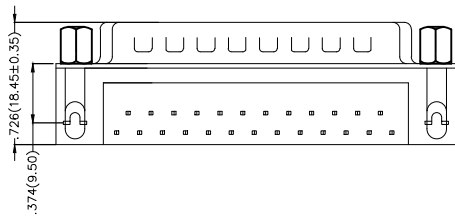
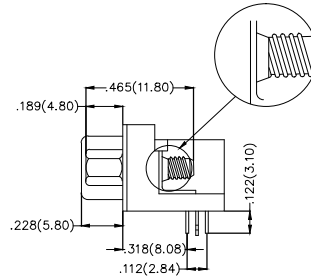
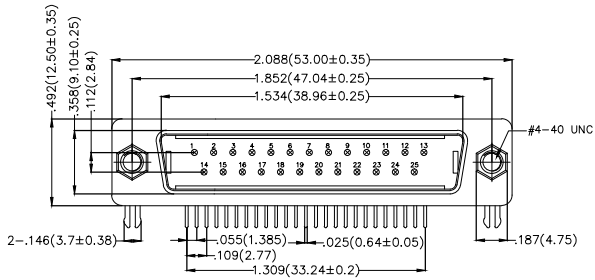

Recommended P.C.Board Layout

Ordering Information

FDB 25 01 - M0 D B 3 XX XX X A
1 2 3 4 5 6 7 8 9 10 11

1 Category FDB- D-SUB Connector	2 Circuits 25-25 Circuits	3 Distinction No. 01	4 Type MO-Male	5 Assembly Layout D-DIP	6 Entry Angle B-90° Angle
7 Plating 3-Selective gold in contact area, tin on tail	8 Thickness of Plating 00-Gold Flash 03-3μ" Custom Plate Available	9 Color-Resin K6-Black U1-Blue	10 Packaging K-Tray L-Tube	11 Distinction Type A-A Type	

<p>THIRD ANGLE PROJECTION</p>	<p>GENERAL TOLERANCES (UNLESS SPECIFIED)</p>		<p>APPROVE BY FRANK</p>	<p>DATE 28/JUN/13</p>	<p>PART NO. FDB2501-MODB3XXXXXA</p>	<p>ITEM NO. FDB2501</p>	<p>Leader Of Industry</p>	
	<p>DESIGN UNITS Inch (metric)</p>	<p>X.±0.012(0.30)</p>	<p>X.±5°</p>	<p>CHECKED BY JACOB</p>	<p>DATE 28/JUN/13</p>	<p>TITLE D-SUB connector 25 Circuits 90° Angle Male</p>		<p>REV 0</p>
<p>SCALE 5:1</p>	<p>SIZE A4</p>	<p>X.XX±.006(0.15)</p>	<p>.XX±1°</p>	<p>DRAWN BY CHERRY</p>	<p>DATE 28/JUN/13</p>	<p>THIS DRAWING CONTAINS INFORMATION THAT IS PROPRIETARY TO TXGA INDUSTRIAL ELECTRONICS(S.Z)CO.,LTD AND SHOULD NOT BE USED WITHOUT WRITTEN PERMISSION</p>		

REV	LOCATIONS	DESCRIPTION	DATE	REVISER	APPD

SPECIFICATIONS

Electrical

Current Rating: 3A AC(rms)/DC
Voltage Rating: 250V AC(rms)/DC
Contact Resistance: 25 mΩ Max
Insulation Resistance: 1000 MΩ Min
Withstanding Voltage: 500V AC r.m.s
Temperature Range-Operating: -55°C~+105°C

Material and plating

Housing: PBT UL 94V-0
Contact: Copper Alloy/
Selective gold in contact area, tin on tail
Shell: SPCC/ Nickel Plated
Board Lock: Copper Alloy/ Tin Plated

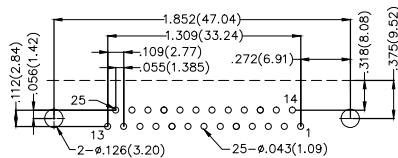
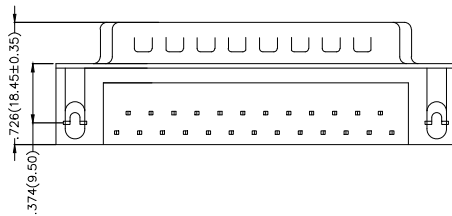
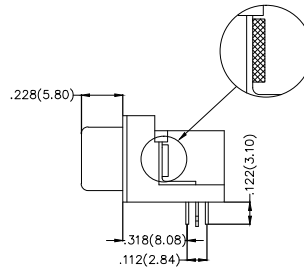
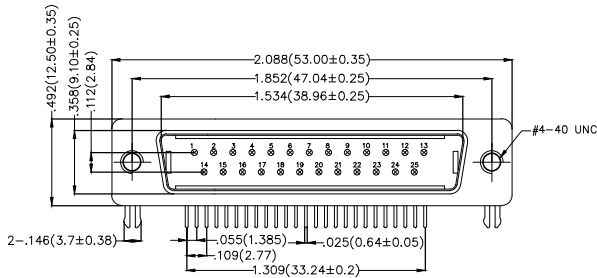

Recommended P.C.Board Layout

Ordering Information

FDB 25 01 — M0 D B 3 XX XX X B
1 2 3 4 5 6 7 8 9 10 11

1 Category FDB- D-SUB Connector	2 Circuits 25-25 Circuits	3 Distinction No. 01	4 Type M0-Male	5 Assembly Layout D-DIP	6 Entry Angle B-90° Angle
7 Plating 3-Selective gold in contact area, tin on tail	8 Thickness of Plating 00-Gold Flash 03-3μ" Custom Plate Available	9 Color-Resin K6-Black U1-Blue	10 Packaging K-Tray L-Tube	11 Distinction Type B-B Type	

<p>THIRD ANGLE PROJECTION</p>	<p>GENERAL TOLERANCES (UNLESS SPECIFIED)</p>		<p>APPROVE BY FRANK</p>	<p>DATE 28/JUN/13</p>	<p>PART NO. FDB2501-MODB3XXXXXB</p>	<p>ITEM NO. FDB2501</p>	<p>Leader Of Industry</p>	
	<p>DESIGN UNITS Inch (metric)</p>	<p>X.±.012(0.30)</p>	<p>X.±5'</p>	<p>CHECKED BY JACOB</p>	<p>DATE 28/JUN/13</p>	<p>TITLE D-SUB connector 25 Circuits 90° Angle Male</p>		<p>REV 0</p>
<p>SCALE 5:1</p>	<p>SIZE A4</p>	<p>X.XX±.006(0.15)</p>	<p>.XX±1'</p>	<p>DRAWN BY CHERRY</p>	<p>DATE 28/JUN/13</p>	<p>THIS DRAWING CONTAINS INFORMATION THAT IS PROPRIETARY TO TXGA INDUSTRIAL ELECTRONICS(S.Z)CO.,LTD AND SHOULD NOT BE USED WITHOUT WRITTEN PERMISSION</p>		

REV	LOCATIONS	DESCRIPTION	DATE	REVISER	APPD

SPECIFICATIONS

Electrical

Current Rating: 3A AC(rms)/DC
Voltage Rating: 250V AC(rms)/DC
Contact Resistance: 25 mΩ Max
Insulation Resistance: 1000 MΩ Min
Withstanding Voltage: 500V AC r.m.s
Temperature Range-Operating: -55°C~+105°C

Material and plating

Housing: PBT UL 94V-0
Contact: Copper Alloy/
Selective gold in contact area, tin on tail
Shell: SPCC/ Nickel Plated
Board Lock: Copper Alloy/ Tin Plated
Screws: Copper Alloy/ Nickel Plated

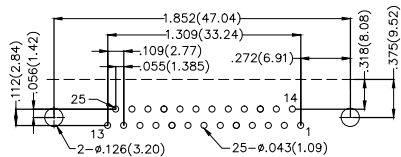
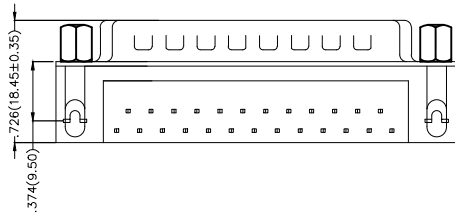
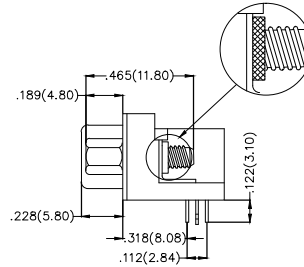
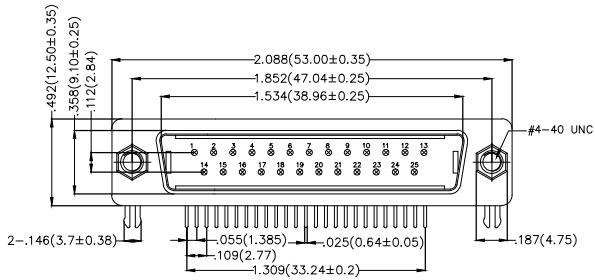

Recommended P.C.Board Layout

Ordering Information

FDB 25 01 - M0 D B 3 XX XX X C
1 2 3 4 5 6 7 8 9 10 11

1 Category FDB- D-SUB Connector	2 Circuits 25-25 Circuits	3 Distinction No. 01	4 Type M0-Male	5 Assembly Layout D-DIP	6 Entry Angle B-90° Angle
7 Plating 3-Selective gold in contact area, tin on tail	8 Thickness of Plating 00-Gold Flash 03-3μ" Custom Plate Available	9 Color-Resin K6-Black U1-Blue	10 Packaging K-Tray L-Tube	11 Distinction Type C-C Type	

<p>THIRD ANGLE PROJECTION</p>	<p>GENERAL TOLERANCES (UNLESS SPECIFIED)</p> <p>X.±.012(0.30) X.±5'</p>		<p>APPROVE BY FRANK</p>	<p>DATE 28/JUN/13</p>	<p>PART NO. FDB2501-MODB3XXXXXC</p>	<p>ITEM NO. FDB2501</p>	<p>Leader Of Industry</p>
	<p>DESIGN UNITS Inch (metric)</p>	<p>X.X±.008(0.20) X.±2'</p>	<p>CHECKED BY JACOB</p>	<p>DATE 28/JUN/13</p>	<p>TITLE D-SUB connector 25 Circuits 90° Angle Male</p>		
<p>SCALE 5:1</p>	<p>SIZE A4</p>	<p>X.XX±.006(0.15) .XX±1'</p>	<p>DRAWN BY CHERRY</p>	<p>DATE 28/JUN/13</p>	<p>THIS DRAWING CONTAINS INFORMATION THAT IS PROPRIETARY TO TXGA INDUSTRIAL ELECTRONICS(S.Z)CO.,LTD AND SHOULD NOT BE USED WITHOUT WRITTEN PERMISSION</p>		

REV	LOCATIONS	DESCRIPTION	DATE	REVISER	APPD

SPECIFICATIONS

Electrical

Current Rating: 3A AC(rms)/DC
Voltage Rating: 250V AC(rms)/DC
Contact Resistance: 25 mΩ Max
Insulation Resistance: 1000 MΩ Min
Withstanding Voltage: 500V AC r.m.s
Temperature Range—Operating: -55°C~+105°C

Material and plating

Housing: PBT UL 94V-0
Contact: Copper Alloy/
Selective gold in contact area, tin on tail
Shell: SPCC/ Nickel Plated
Board Lock: Copper Alloy/ Tin Plated
Screws: Copper Alloy/ Nickel Plated

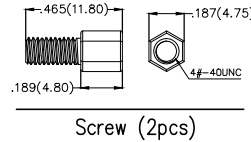
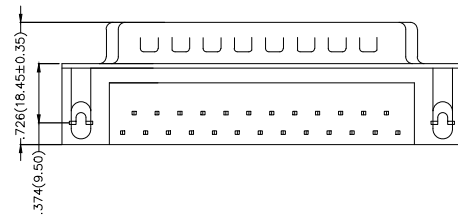
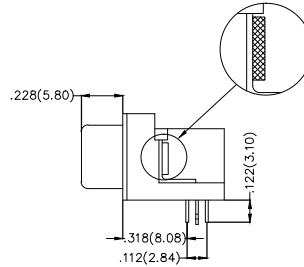
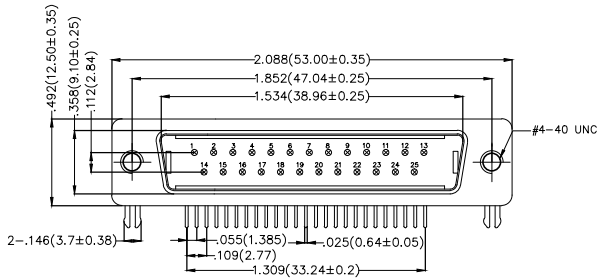

Ordering Information

FDB 25 01 — M0 D B 3 XX XX X D
1 2 3 4 5 6 7 8 9 10 11

1 Category FDB- D-SUB Connector	2 Circuits 25-25 Circuits	3 Distinction No. 01	4 Type M0-Male	5 Assembly Layout D-DIP	6 Entry Angle B-90° Angle
7 Plating 3-Selective gold in contact area, tin on tail	8 Thickness of Plating 00-Gold Flash 03-3μ" Custom Plate Available	9 Color-Resin K6-Black U1-Blue	10 Packaging K-Tray L-Tube	11 Distinction Type D-D Type	

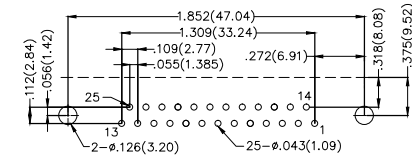

Recommended P.C.Board Layout

 THIRD ANGLE PROJECTION	GENERAL TOLERANCES (UNLESS SPECIFIED) X.±.012(0.30) X.±5' X.X±.008(0.20) X.±2' X.XX±.006(0.15) .XX±1" X.XXX±.004(0.10) .XXX±0.5'		APPROVE BY FRANK CHECKED BY JACOB DRAWN BY CHERRY	DATE 28/JUN/13 DATE 28/JUN/13 DATE 28/JUN/13	PART NO. FDB2501-MODB3XXXXXD ITEM NO. FDB2501	 Leader Of Industry
	DESIGN UNITS Inch (metric) SCALE 5:1 SIZE A4	TITLE D-SUB connector 25 Circuits 90° Angle Male	THIS DRAWING CONTAINS INFORMATION THAT IS PROPRIETARY TO TXGA INDUSTRIAL ELECTRONICS(S.Z)CO.,LTD AND SHOULD NOT BE USED WITHOUT WRITTEN PERMISSION	REV 0 SHEET NO. 1/1		

X-ON Electronics

Largest Supplier of Electrical and Electronic Components

Click to view similar products for [D-Sub Standard Connectors](#) category:

Click to view products by [TXGA](#) manufacturer:

Other Similar products are found below :

[015-0339-000](#) [015-0341-000](#) [015-0349-000](#) [015-0350-000](#) [015-8544-011](#) [015-8755-001](#) [017041-0005](#) [020419-0104](#) [609-25P](#) [609-9P](#) [CT0-24-10SC](#) [CT0-36-3PC](#) [CT0E20-8PS](#) [CT0F16S-1PS](#) [CT0TA16-11SXCA232](#) [CT1E20-19SS](#) [CT2-10SL-3SC](#) [CT2-14S-2PCA34](#) [CT2-18-11PCAU](#) [CT2-22-19SC](#) [CT2-36-5PC](#) [CT6-10SL-3SC](#) [CT6-10SL-4SC](#) [CT6-14S-2SC](#) [CT6-16-12SC](#) [CT6-18-10PSA206](#) [CT6-18-10PSA232](#) [CT6-18-11PXSA206](#) [CT6-18-11PXSA232](#) [CT6-22-10PS](#) [CT6-24-5PC](#) [CT6-9767-18-8-18-4SS](#) [CT6E14S-5SC](#) [CT6E14SA7SC](#) [CT6E20-14SS](#) [CT6E22-14PC](#) [CT6E22-14PS](#) [CT6E22-19PS](#) [CT6E22-22PS](#) [CT6E24-10SC](#) [CT6F16S-1SC](#) [CT6FA10SL-4PS](#) [CT6LA20-19PC](#) [CT6M20-19SS](#) [CT6NSB4-20-8SS](#) [CT6TC14S-6SCAU](#) [CT6TC14S-7PS](#) [6STD15SCT99S40X](#) [6STF09PCM05B70X](#) [D20420-80](#)