

| | | | | | |
|-----|-----------|-------------|------|--------|------|
| REV | LOCATIONS | DESCRIPTION | DATE | REVSER | APPD |
| | | | | | |

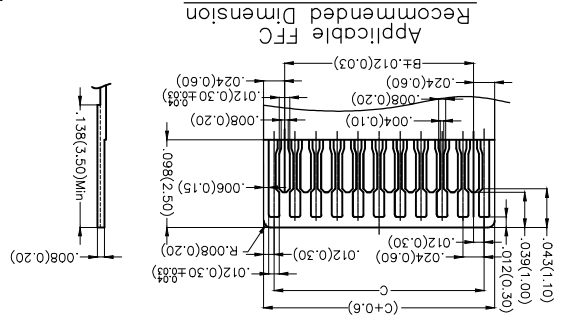
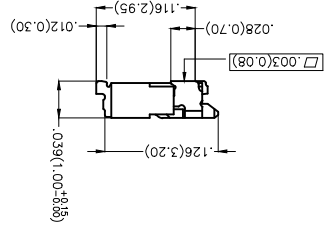
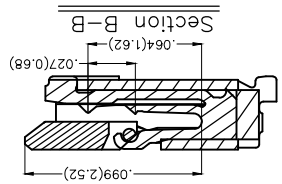
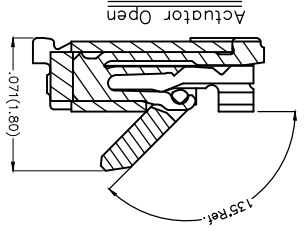
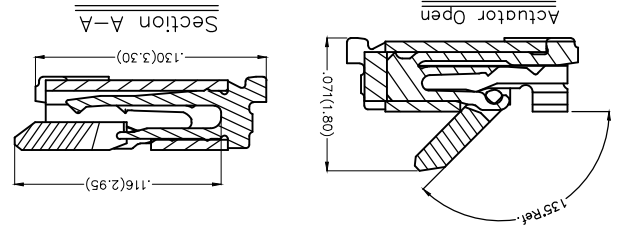
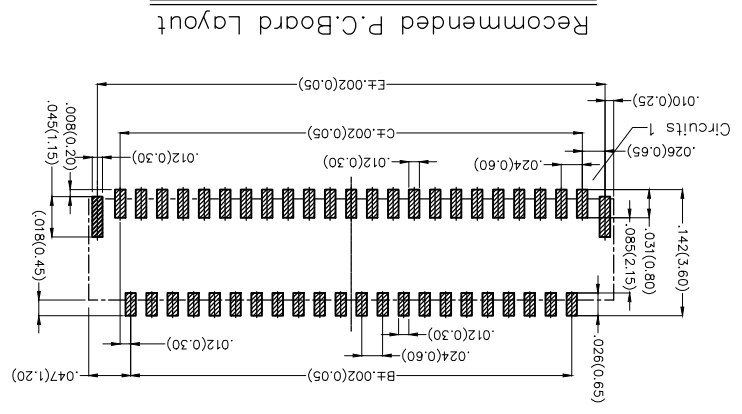
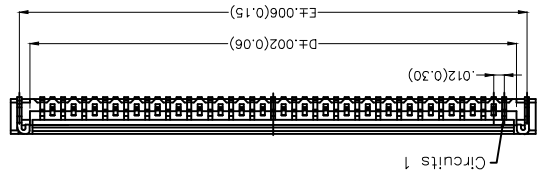
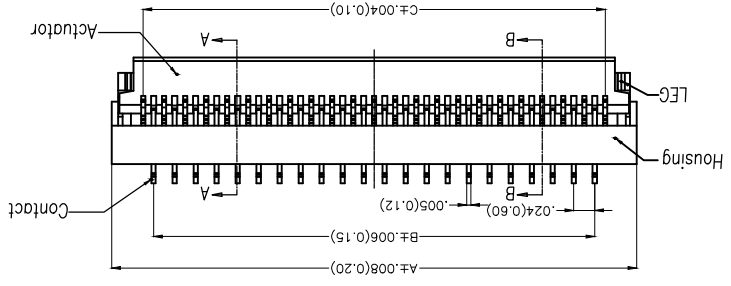

SPECIFICATIONS

Electrical
 Current Rating: 0.2A AC(rms)/DC
 Voltage Rating: 50V AC(rms)/DC
 Contact Resistance: 20 mΩ Max
 Insulation Resistance: 50 MΩ Min
 Withstanding Voltage: 200V AC r.m.s.
 Temperature Range—Operating: -25°C~+85°C
 Material and Plating
 Housing: LCP UL 94V-0
 Actuator: LCP UL 94V-0
 Terminal: Phosphor Bronze/ Gold Plated
 Stopper: Phosphor Bronze/ Tin Plated

| Circuits | Part No. | Dimensions(In/mm) | | | | |
|----------|----------------------|-------------------|-------------|-------------|-------------|-------------|
| | | A | B | C | D | E |
| 13 | FFC03001-13SBB114W5M | 2.36(6.0) | 1.42(3.60) | 1.18(3.00) | 1.69(4.30) | 1.93(4.90) |
| 15 | FFC03001-15SBB114W5M | 2.36(6.0) | 1.65(4.20) | 1.93(4.90) | 2.17(5.50) | 2.87(7.30) |
| 21 | FFC03001-21SBB114W5M | 3.07(7.80) | 2.13(5.40) | 2.36(6.00) | 2.64(6.70) | 3.35(7.90) |
| 23 | FFC03001-23SBB114W5M | 3.30(8.40) | 2.36(6.00) | 2.60(6.60) | 2.87(7.30) | 3.35(7.90) |
| 25 | FFC03001-25SBB114W5M | 3.54(9.00) | 2.60(6.60) | 2.83(7.20) | 3.11(7.90) | 3.35(8.50) |
| 29 | FFC03001-29SBB114W5M | 4.02(10.20) | 3.31(8.40) | 3.58(9.10) | 3.82(9.70) | 3.82(9.70) |
| 31 | FFC03001-31SBB114W5M | 4.25(10.80) | 3.31(8.40) | 3.54(9.00) | 3.82(9.70) | 4.06(10.30) |
| 35 | FFC03001-35SBB114W5M | 4.72(12.00) | 3.78(9.60) | 4.02(10.20) | 4.26(10.90) | 4.53(11.50) |
| 39 | FFC03001-39SBB114W5M | 5.20(13.20) | 4.25(10.80) | 4.49(11.40) | 4.76(12.10) | 5.00(12.70) |
| 41 | FFC03001-41SBB114W5M | 5.43(13.80) | 4.49(11.40) | 4.72(12.00) | 5.00(12.70) | 5.24(13.30) |
| 45 | FFC03001-45SBB114W5M | 5.90(15.00) | 4.96(12.60) | 5.20(13.20) | 5.47(13.90) | 5.71(14.50) |
| 51 | FFC03001-51SBB114W5M | 6.61(16.80) | 5.67(14.40) | 5.91(15.00) | 6.18(15.70) | 6.42(16.30) |

Ordering Information

FFC 030 01 - XX S B 1 4 W5 M
 1 2 3 4 5 6 7 8 9 10 11 12

1 Category 2 Series Number 3 Distinction No. 4 Circuits 5 Assemble Layout 6 Entry Angle
 7 Contact Position 8 ZIF 9 Plating 10 Material-Resin 11 Color-Resin 12 Packaging
 B-Bottom 1-ZIF 1-Gold Plated 4-LCP W5-Housing:Natural, M-Reel

| | | | | | | | | | | | |
|---------------------------|--------------|--------------|-------|--------|-----------|------|----------|----------------------|----------|---------------|--|
| THIRD ANGLE PROJECTION | DESIGN UNITS | X±.012(0.30) | X±.75 | FRANK | 28/JUN/13 | DATE | PART NO. | FFC03001-XXSBB114W5M | ITEM NO. | FFC03001 | Leader Of Industry |
| | SCALE | 5:1 | A4 | CHERRY | 28/JUN/13 | DATE | TITLE | Bottom contact SMT | REV 0 | SHEET NO. 1/2 | THIS DRAWING CONTAINS INFORMATION THAT IS PROPRIETARY TO TXGA INDUSTRIAL ELECTRONICS(S)Z)CO.,LTD AND SHOULD NOT BE USED WITHOUT WRITTEN PERMISSION |

| REV | LOCATIONS | DESCRIPTION | DATE | REVISER | APPD |
|-----|-----------|-------------|------|---------|------|
| | | | | | |

Note:

1. 10 sprocket hole cumulative tolerance ± 0.2
2. Carrier camber is within 1.0mm in 250mm
3. Material: White Conductive polystyrene Alloy 100% recyclable
4. All dimensions meet EIA-481-5 requirements
5. Peel off force of cover tape & carrier tape: $20g \sim 130g (0.2N \sim 1.3N)$
6. Component load per 15" reel: 5,000 pcs

| Circuits | Dimensions (in/mm) | |
|----------|--------------------|------------|
| | A | B |
| 13-25 | 6.30(16.0) | 2.95(7.5) |
| 27-51 | 9.45(24.0) | 4.53(11.5) |

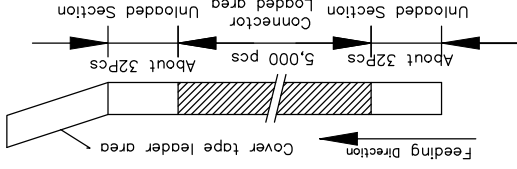

Unloaded Section Loaded area Unloaded Section

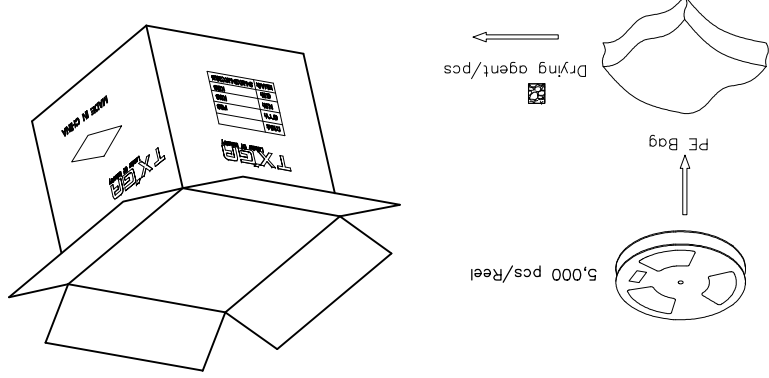
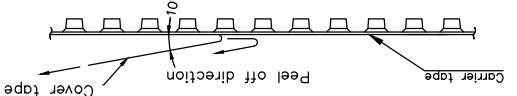

| THIRD ANGLE PROJECTION | | GENERAL TOLERANCES (UNLESS SPECIFIED) | | APPROVE BY | DATE | PART NO. | ITEM NO. |
|--|---------------|---------------------------------------|----------|------------|-----------|--|---------------|
| | | X.±.012(0.30) | X.±.5 | FRANK | 28/JUN/13 | FFC03001-XXSBB14WSM | FFC03001 |
| DESIGN UNITS | Inch (metric) | X.XX±.008(0.20) | X.±.2 | JACOB | 28/JUN/13 | FPC/FCC connector 0.3mm Bottom contact SMT | |
| SCALE | 5:1 A4 | X.XX±.006(0.15) | X.X±.1 | DRAWN BY | DATE | TITLE | |
| | | X.XXX±.004(0.10) | .XXX±0.5 | CHEERY | 28/JUN/13 | FPC/FCC connector 0.3mm Bottom contact SMT | |
| THIS DRAWING CONTAINS INFORMATION THAT IS PROPRIETARY TO TXGA INDUSTRIAL ELECTRONICS(Z)CO.,LTD AND SHOULD NOT BE USED WITHOUT WRITTEN PERMISSION | | | | | | | |
| | | | | | | REV 0 | SHEET NO. 2/2 |

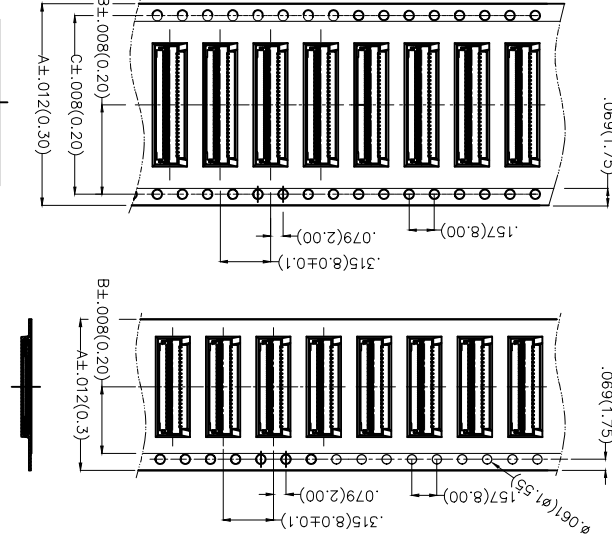
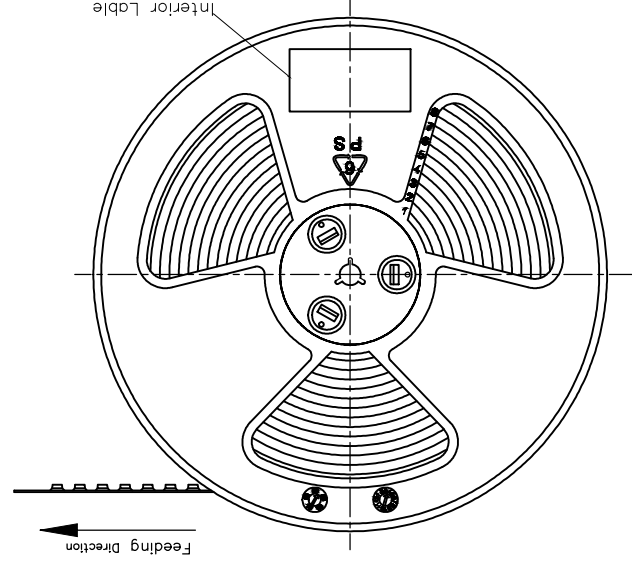

Feeding Direction

Feeding Direction

X-ON Electronics

Largest Supplier of Electrical and Electronic Components

Click to view similar products for [FFC & FPC Connectors](#) category:

Click to view products by [TXGA](#) manufacturer:

Other Similar products are found below :

[HFW11R-1STE1H1LF](#) [FH29B-100S-0.2SHW\(99\)](#) [FA5S008HP1](#) [FH29B-120S-0.2SHW\(99\)](#) [FH29B-80S-0.2SHW\(99\)](#) [FHS-16](#) [FPH-2022G](#)
[52610-1075](#) [52610-1275](#) [52610-1934](#) [XF3M\(1\)-1415-1B-R100](#) [501864-3091-TR225](#) [0525594033](#) [086210010340800](#) [086222026001800](#)
[52271-2869-CUT-TAPE](#) [62674-201121DLF](#) [62684-36210E9ALF](#) [52610-1675](#) [52746-1671-TR250](#) [10051922-2810EHLF](#) [6-520415-9](#)
[BD021-09A-A1-0350-0200-0550-LD](#) [SFV6R-1STE9HLF](#) [XF3M-2915-1B-R100](#) [1658549-1](#) [62674-221121ALF](#) [46214008010800](#)
[046298003000883](#) [151660622](#) [842-816-2630-035](#) [AYF530665TA](#) [AYF351525](#) [046296011930846+](#) [AYF352325A](#) [046254020000800+](#)
[FH19C-13S-0.5SH\(99\)](#) [FH39J-51S-0.3SHW\(99\)](#) [AYF355125A](#) [AYF530365TA](#) [FH29B-44S-0.2SHW\(99\)](#) [SFW5R-2STAE9LF](#) [AYF351125A](#)
[AYF350725A](#) [62684-502100AHLF](#) [FH39-61S-0.3SHW\(99\)](#) [AYF414035A](#) [10064555-172520HLF](#) [AYF212335A](#) [504754-2500](#)