

REV	LOCATIONS	DESCRIPTION	DATE	REVISER	APPD

**SPECIFICATIONS**

Electrical  
 Current Rating: 0.5A AC(rms)/DC  
 Voltage Rating: 50V AC(rms)/DC  
 Contact Resistance: 20 mΩ Max  
 Insulation Resistance: 500 MΩ MIN  
 Withstanding Voltage: 200V AC r.m.s.  
 Temperature Range: -25°C~+85°C  
 Material and Plating  
 Housing: PA6T UL 94V-0  
 Contact: Phosphor Bronze/Gold Plater/Tin Plated

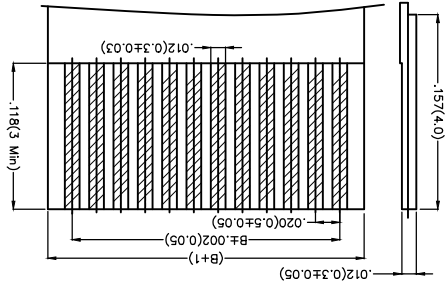

Applicable FFC  
 Recommended Dimension

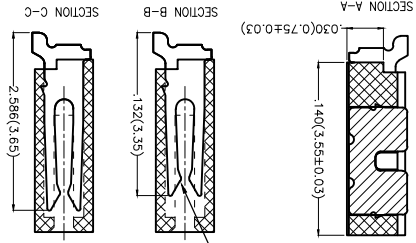

Contact Type  
 (Double Contact)

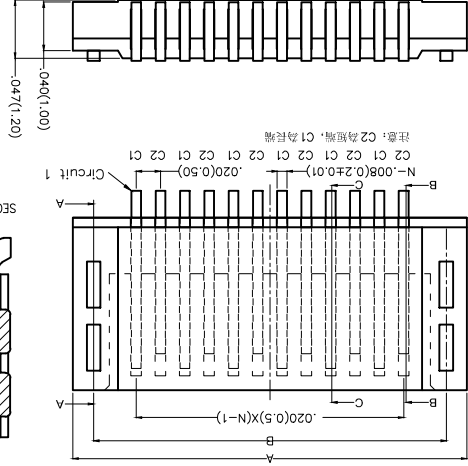

注意: C2 为短路, C1 为开路

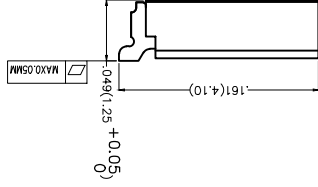
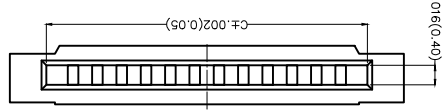

1	Category	2	Series Number	3	Distinction No.	4	Circuits	5	Assemble Layout	6	Entry Angle
7	FFC-FFC	2	050-Pitch0.50mm	3	18	4	XX	5	S-SMT	6	B-90° Angle
7	Contact Type	8	ZIF	9	Plating	10	Material-Resin	11	Color-Resin	12	Packaging
7	D-Double Contact	8	Z-NON ZIF	9	1-Gold Plated 2-Tin Plated	10	4-PA6T	11	W5-Natural	12	M-Reel

Ordering Information  
 FFC 050 18 - XX S B D 2 X 4 W5 M

GENERAL TOLERANCES (UNLESS SPECIFIED)	APPROVE BY	DATE	PART NO.	ITEM NO.
FRANK	18/JUN/13	FFC05018-XXSBD2X4W5M	FFC05018	
CHECKED BY	DATE	TITLE		
JACOB	18/JUN/13	FFC/FFC connector 0.5mm Double contact SMT		
DRAWN BY	DATE			
CHERRY	18/JUN/13	THIS DRAWING CONTAINS INFORMATION THAT IS PROPRIETARY TO TXGA INDUSTRIAL ELECTRONICS(S)ZC, LTD AND SHOULD NOT BE USED WITHOUT WRITTEN PERMISSION		



THIRD ANGLE PROJECTION	DESIGN UNITS	SCALE
(Symbol)	X.±.012(0.30) X.±.008(0.20) X.±.006(0.15) X.XXX±.004(0.10)	A4 1:1

Recommended P.C.Board Layout

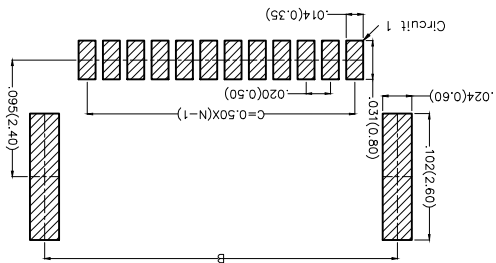

REV	LOCATIONS	DESCRIPTION	DATE	REVISER	APPD

A

B

C

D

E

F

Circuits		Part No.			Dimensions(in/mm)		
(n)		A	B	C			
4	FFC05018-04SBD214W5M	.161(4.10)	.128(3.25)	.102(2.60)			
6	FFC05018-06SBD214W5M	.201(5.10)	.167(4.25)	.142(3.60)			
8	FFC05018-08SBD214W5M	.240(6.10)	.207(5.25)	.181(4.60)			
10	FFC05018-10SBD214W5M	.280(7.10)	.246(6.25)	.220(5.60)			
12	FFC05018-12SBD214W5M	.319(8.10)	.285(7.25)	.260(6.60)			
14	FFC05018-14SBD214W5M	.358(9.10)	.325(8.25)	.299(7.60)			
15	FFC05018-15SBD214W5M	.378(9.60)	.344(8.75)	.319(8.10)			
16	FFC05018-16SBD214W5M	.398(10.10)	.364(9.25)	.339(8.60)			
18	FFC05018-18SBD214W5M	.437(11.10)	.404(10.25)	.378(9.60)			
20	FFC05018-20SBD214W5M	.476(12.10)	.443(11.25)	.417(10.60)			
22	FFC05018-22SBD214W5M	.516(13.10)	.482(12.25)	.457(11.60)			

Note: Contact Tin Plated

APPROVE BY	FRANK	DATE	18/JUN/13	PART NO.	FFC05018	ITEM NO.	FFC05018
CHECKED BY	JACOB	DATE	18/JUN/13	TITLE	FFC/FCC connector 0.5mm	REV 0	SHEET NO.2/3
DRAWN BY	CHEERY	DATE	18/JUN/13	THIS DRAWING CONTAINS INFORMATION THAT IS PROPRIETARY TO TXGA INDUSTRIAL ELECTRONICS(SZ)CO.,LTD AND SHOULD NOT BE USED WITHOUT WRITTEN PERMISSION			
GENERAL TOLERANCES (UNLESS SPECIFIED)		X.±.012(0.30)		DESIGN UNITS		Inch (metric)	
X.XX±.006(0.15)		X.XX±.008(0.20)		X.XX±.006(0.15)		SCALE	
X.XX±.05		X.XX±.05		X.XX±.004(0.10)		SIZE	
A4		A4		1:1		THIRD ANGLE PROJECTION	

F

8

7

6

5

4

3

2

1

A

B

C

D

E

F

REV	LOCATIONS	DESCRIPTION	DATE	REVISER	APPD

Note:

- 10 sprocket hole cumulative tolerance±0.2
- Carrier comb is within 1.0mm in 250mm
- Material: White Conductive polystyrene Alloy 100% recyclable
- All dimensions meet EIA-481-3 requirements
- Peel off force of cover tape&carrier tape: 20g~130g(0.2N~1.3N)
- Component load per 13" reel: 3,000 pcs

Circuits	Dimensions(in/mm)	
	A	B
4~12	630(16.0)	295(7.50)
13~24	945(24.0)	453(11.50)
25~36	1,260(32.0)	561(14.25)
37~45	1,732(44.0)	797(20.25)

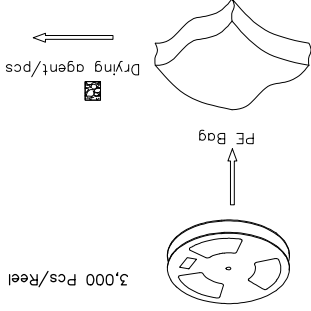
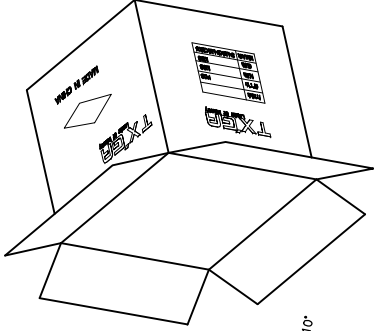
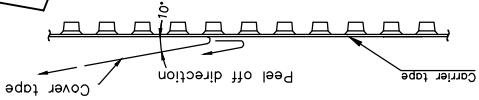
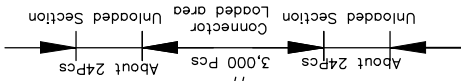
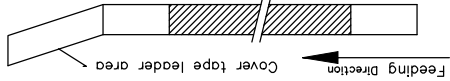

THIRD ANGLE		DESIGN UNITS		SCALE	
	(UNLESS SPECIFIED)	X.±.012(0.30)	X.±.008(0.20)	X.±.006(0.15)	X.±.004(0.10)
APPROVE BY	FRANK	CHECKED BY	JACOB	DRAWN BY	CHEERY
DATE	18/JUN/13	DATE	18/JUN/13	DATE	18/JUN/13
PART NO.	FFC05018	ITEM NO.	FFC05018	TITLE	
FPC/FPC connector 0.5mm		Double contact SMT		REV 0	SHEET NO. 3/3

GENERAL TOLERANCES (UNLESS SPECIFIED)

APPROVE BY FRANK DATE 18/JUN/13

CHECKED BY JACOB DATE 18/JUN/13

DRAWN BY CHEERY DATE 18/JUN/13

SCALE 5:1 A4

DESIGN UNITS X.±.006(0.15) X.±.008(0.20) X.±.012(0.30)

THIRD ANGLE (UNLESS SPECIFIED)

THIS DRAWING CONTAINS INFORMATION THAT IS PROPRIETARY TO TXGA INDUSTRIAL ELECTRONICS(SZ)CO.,LTD AND SHOULD NOT BE USED WITHOUT WRITTEN PERMISSION

TXGA  
Leader Of Industry

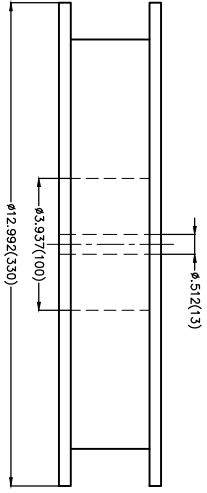
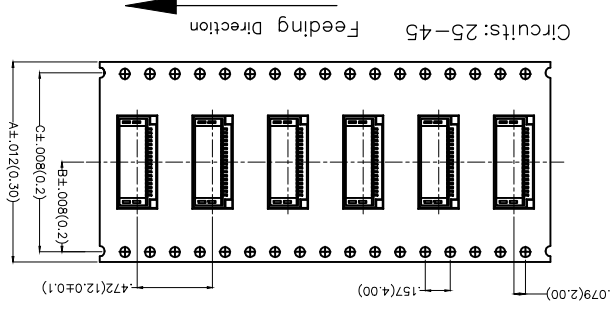
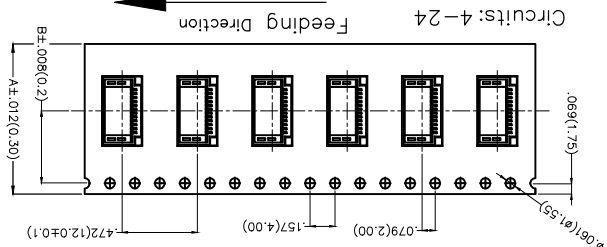
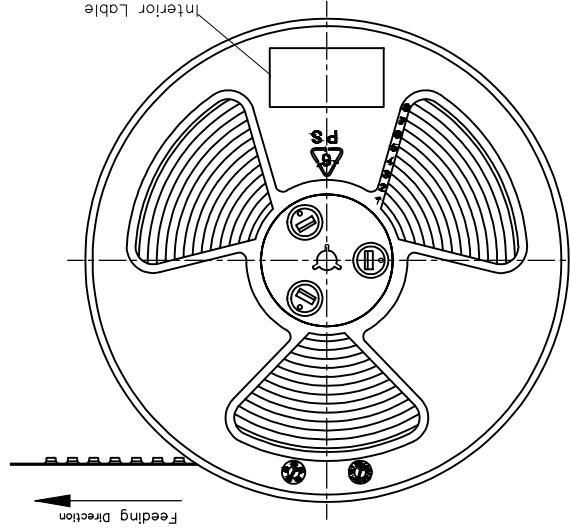

## X-ON Electronics

Largest Supplier of Electrical and Electronic Components

*Click to view similar products for [FFC & FPC Connectors](#) category:*

*Click to view products by [TXGA](#) manufacturer:*

Other Similar products are found below :

[HFW11R-1STE1H1LF](#) [FH29B-100S-0.2SHW\(99\)](#) [FA5S008HP1](#) [FH29B-120S-0.2SHW\(99\)](#) [FH29B-80S-0.2SHW\(99\)](#) [FHS-16](#) [FPH-2022G](#)  
[52610-1075](#) [52610-1275](#) [52610-1934](#) [XF3M\(1\)-1415-1B-R100](#) [501864-3091-TR225](#) [0525594033](#) [086210010340800](#) [086222026001800](#)  
[52271-2869-CUT-TAPE](#) [62674-201121DLF](#) [62684-36210E9ALF](#) [52610-1675](#) [52746-1671-TR250](#) [10051922-2810EHLF](#) [6-520415-9](#)  
[BD021-09A-A1-0350-0200-0550-LD](#) [SFV6R-1STE9HLF](#) [XF3M-2915-1B-R100](#) [1658549-1](#) [62674-221121ALF](#) [46214008010800](#)  
[046298003000883](#) [151660622](#) [842-816-2630-035](#) [AYF530665TA](#) [AYF351525](#) [046296011930846+](#) [AYF352325A](#) [046254020000800+](#)  
[FH19C-13S-0.5SH\(99\)](#) [FH39J-51S-0.3SHW\(99\)](#) [AYF355125A](#) [AYF530365TA](#) [FH29B-44S-0.2SHW\(99\)](#) [SFW5R-2STAE9LF](#) [AYF351125A](#)  
[AYF350725A](#) [62684-502100AHLF](#) [FH39-61S-0.3SHW\(99\)](#) [AYF414035A](#) [10064555-172520HLF](#) [AYF212335A](#) [504754-2500](#)