

1 2 3 4 5 6 7 8

| REV | LOCATIONS   | DESCRIPTION                           | DATE      | REVISER | APPD   |
|-----|-------------|---------------------------------------|-----------|---------|--------|
| 1   | $\triangle$ | 1. Material change, 2. Add dimensions | 15/APR/20 | KATE    | CHERRY |

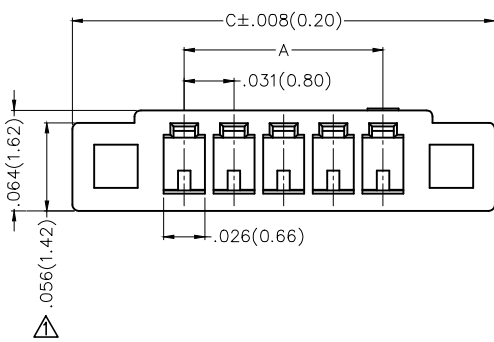
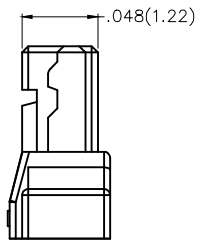
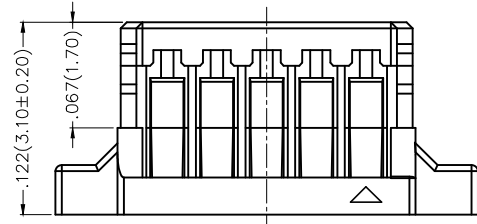
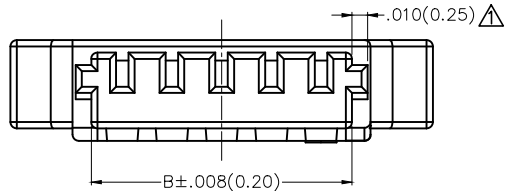

Electrical  
 Temperature Range—Operating: -25°C~+85°C  
 Material and Plating  
 $\triangle$  Housing: PA46 (UL 94V-0)  
 Applicable Terminal: FT08001  
 Mates With: FWF08001, FWF08002 Series

### Ordering Information

FHG 080 02 — S XX M 6 W5 B  
 1 2 3 4 5 6 7 8 9

|   |                         |   |                                   |   |                                      |   |                            |   |                       |
|---|-------------------------|---|-----------------------------------|---|--------------------------------------|---|----------------------------|---|-----------------------|
| 1 | Category<br>FHG—Housing | 2 | Series Number<br>080—Pitch 0.80mm | 3 | Distinction No.<br>02                | 4 | Row Option<br>S—Single Row |   |                       |
| 5 | Circuits<br>XX          | 6 | Type<br>M—Male                    | 7 | Material—Resin<br>6—PA46 $\triangle$ | 8 | Color—Resin<br>W5—Natural  | 9 | Packaging<br>B—PE Bag |

| Circuits (n) | Part No. $\triangle$ | Dimensions(in/mm) |            |             | Circuits (n) | Part No. $\triangle$ | Dimensions(in/mm) |             |             |
|--------------|----------------------|-------------------|------------|-------------|--------------|----------------------|-------------------|-------------|-------------|
|              |                      | A                 | B          | C           |              |                      | A                 | B           | C           |
| 2            | FHG08002—S02M6W5B    | .031(0.80)        | .071(1.80) | .173(4.40)  | 10           | FHG08002—S10M6W5B    | .283(7.20)        | .323(8.20)  | .425(10.80) |
| 3            | FHG08002—S03M6W5B    | .063(1.60)        | .102(2.60) | .205(5.20)  | 11           | FHG08002—S11M6W5B    | .315(8.00)        | .354(9.00)  | .457(11.60) |
| 4            | FHG08002—S04M6W5B    | .094(2.40)        | .134(3.40) | .236(6.00)  | 12           | FHG08002—S12M6W5B    | .346(8.80)        | .386(9.80)  | .488(12.40) |
| 5            | FHG08002—S05M6W5B    | .126(3.20)        | .165(4.20) | .268(6.80)  | 13           | FHG08002—S13M6W5B    | .378(9.60)        | .417(10.60) | .520(13.20) |
| 6            | FHG08002—S06M6W5B    | .157(4.00)        | .197(5.00) | .299(7.60)  | 14           | FHG08002—S14M6W5B    | .409(10.40)       | .449(11.40) | .551(14.00) |
| 7            | FHG08002—S07M6W5B    | .189(4.80)        | .228(5.80) | .331(8.40)  | 15           | FHG08002—S15M6W5B    | .441(11.20)       | .480(12.20) | .583(14.80) |
| 8            | FHG08002—S08M6W5B    | .220(5.60)        | .260(6.60) | .362(9.20)  | 16           | FHG08002—S16M6W5B    | .472(12.00)       | .512(13.00) | .614(15.60) |
| 9            | FHG08002—S09M6W5B    | .252(6.40)        | .291(7.40) | .394(10.00) | 20           | FHG08002—S20M6W5B    | .598(15.20)       | .638(16.20) | .740(18.80) |

|  |                                       |                 |                     |                      |                               |  |                        |
|--|---------------------------------------|-----------------|---------------------|----------------------|-------------------------------|--|------------------------|
| <br>THIRD ANGLE PROJECTION   | GENERAL TOLERANCES (UNLESS SPECIFIED) |                 | APPROVE BY<br>FRANK | DATE<br>04/JUN/15    | PART NO.<br>FHG08002—SXXM6W5B | ITEM NO.<br>FHG08002                           | <br>Leader Of Industry |
|  | DESIGN UNITS<br>Inch (metric)         | X.±.012(0.30)   | X.±5'               | CHECKED BY<br>CHERRY | DATE<br>04/JUN/15             | TITLE<br>Wire to Board<br>Pitch 0.8mm(Housing) |                        |
| SCALE<br>5:1   | SIZE<br>A4                            | X.XX±.006(0.15) | .XX'±1'             | DRAWN BY<br>KATE     | DATE<br>04/JUN/15             | REV 1  | SHEET NO. 1/1          |
| THIS DRAWING CONTAINS INFORMATION THAT IS PROPRIETARY TO TXGA INDUSTRIAL ELECTRONICS(S.Z)CO.,LTD AND SHOULD NOT BE USED WITHOUT WRITTEN PERMISSION |                                       |                 |                     |                      |                               |  |                        |

1 2 3 4 5 6 7 8

## X-ON Electronics

Largest Supplier of Electrical and Electronic Components

*Click to view similar products for [Headers & Wire Housings](#) category:*

*Click to view products by [TXGA](#) manufacturer:*

Other Similar products are found below :

[0015917161](#) [0022155065](#) [57102-F02-18ULF](#) [58102-G61-06LF](#) [582553-1](#) [01.001.5753.1](#) [0050291907](#) [02.125.8002.8](#) [609-3404](#) [61062-3](#)  
[CSU011177004](#) [622-0430](#) [622-3653LF](#) [63453-116](#) [636-1030](#) [636-1427](#) [636-3427](#) [636-4007](#) [641938-9](#) [65495-038](#) [65692-001LF](#) [65781-018](#)  
[65781-047](#) [65817-010LF](#) [65817-015LF](#) [67095-007LF](#) [67601157](#) [68631-112](#) [68645-018](#) [699319-000](#) [70.362.1628.0](#) [70-4210](#) [70-4226B](#) [70-](#)  
[4853B](#) [71.350.2428.0](#) [733-134](#) [733-162](#) [760-3052](#) [MHR-64-VUAL](#) [80.063.4001.1](#) [800-90-001-10-001000](#) [801-43-002-10-013000](#)  
[801-43-006-10-002000](#) [803-43-024-10-001000](#) [803-93-012-10-001000](#) [8-1437020-4](#) [819-22-004-30-001101](#) [820-22-006-30-001101](#)  
[820-22-008-30-001101](#) [821-22-002-10-001101](#)