

REV	LOCATIONS	DESCRIPTION	DATE	REVISER	APPD

Electrical
 Temperature Range—Operating: -25°C~+85°C
 Material
 Housing:PA66 (UL 94V-0)
 Applicable Terminal: FT12501
 Mates With (Housing): FHG12508 Series
 Mates With(Water): FWF12504,FWF12505,FWF12506,FWF12507 Series

Circuits (n)	Part No.	Dimensions(n/mm)	
		A	B

16	FHG12502-S16M2W1B	.738(18.75)	.856(21.75)
15	FHG12502-S15M2W1B	.689(17.50)	.807(20.50)
14	FHG12502-S14M2W1B	.640(16.25)	.757(19.25)
13	FHG12502-S13M2W1B	.591(15.00)	.709(18.00)
12	FHG12502-S12M2W1B	.541(13.75)	.659(16.75)
11	FHG12502-S11M2W1B	.492(12.50)	.610(15.50)
10	FHG12502-S10M2W1B	.443(11.25)	.561(14.25)
9	FHG12502-S09M2W1B	.394(10.00)	.512(13.00)
8	FHG12502-S08M2W1B	.344(8.75)	.463(11.75)
7	FHG12502-S07M2W1B	.295(7.50)	.413(10.50)
6	FHG12502-S06M2W1B	.246(6.25)	.364(9.25)
5	FHG12502-S05M2W1B	.197(5.00)	.315(8.00)
4	FHG12502-S04M2W1B	.147(3.75)	.266(6.75)
3	FHG12502-S03M2W1B	.098(2.50)	.217(5.50)
2	FHG12502-S02M2W1B	.049(1.25)	.167(4.25)

Ordering Information

FHG 125 02 - S XX M 2 W1 B
 1 2 3 4 5 6 7 8 9
 125 02 - S XX M 2 W1 B

1	Category	FHG-Housing
2	Series Number	125-Pitch1.25mm
3	Distinction No.	02
4	Row Option	S-Single Row
5	Circuits	XX
6	Entry Type	M-Male
7	Material-Resin	2-PA66
8	Color-Resin	W1-White
9	Packaging	B-PE Bag

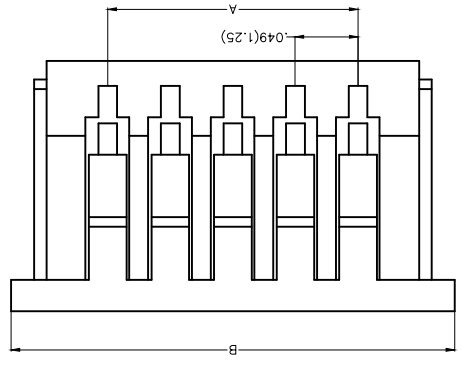
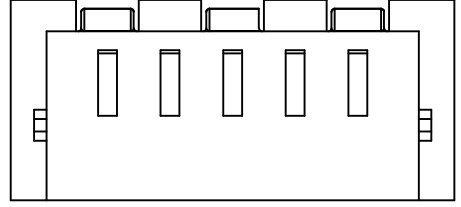
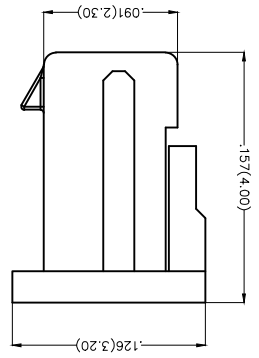

THIRD ANGLE PROJECTION	DESIGN UNITS	X.X±.012(0.30)	X.±.5	DATE	25/JUN/13	APPROVE BY	FRANK	DATE	25/JUN/13	PART NO.	FHG12502-SXXM2W1B	ITEM NO.	FHG12502
	INCH (metric)	X.X±.008(0.20)	X.±.2	CHECKED BY	JACOB	DATE	25/JUN/13	TITLE	Wire to Board	Pitch 1.25mm(Housing)	REV 0	SHEET NO. 1/1	
SCALE	SIZE	A4	X.XXX±.004(0.10)	XXX±0.5	DRAWN BY	CERRY	DATE	25/JUN/13	ELECTRONICS(Z)CO.,LTD AND SHOULD NOT BE USED WITHOUT WRITTEN PERMISSION	THIS DRAWING CONTAINS INFORMATION THAT IS PROPRIETARY TO TXGA INDUSTRIAL	8		



X-ON Electronics

Largest Supplier of Electrical and Electronic Components

Click to view similar products for [Headers & Wire Housings](#) category:

Click to view products by [TXGA](#) manufacturer:

Other Similar products are found below :

[95000-104TRLF](#) [10135584-644402LF](#) [DF62W-EP2022PCA](#) [95000-106TRLF](#) [DF62W-2022SCA](#) [DF62W-EP2022PC](#) [2203348](#) [DF62W-2022SC](#) [1084018](#) [1029039](#) [1084017](#) [802-10-012-10-002000](#) [1112640](#) [1112639](#) [891-007-9SS-BST1T](#) [000-34000](#) [0008550134](#) [0009482033](#) [0009507031](#) [57102-F02-18ULF](#) [57102-S06-03LF](#) [57202-S52-04LF](#) [PCN6-15S-2.5E](#) [0039019024](#) [58102-G61-06LF](#) [582553-1](#) [0009485154](#) [0009508121](#) [0022285053](#) [0050291907](#) [018731A](#) [LY20-4P-DT1-P1E-BR](#) [02.125.8002.8](#) [60101931](#) [60598-1 \(Cut Strip\)](#) [M1625-3R/100](#) [61062-3](#) [61082-181009](#) [CSU011177004](#) [636-1427](#) [638009-1](#) [641938-9](#) [641991-4](#) [644168-1](#) [644827-2](#) [647662-1](#) [65039-019ELF](#) [65692-001LF](#) [65781-018](#) [65781-047](#)