

REV	LOCATIONS	DESCRIPTION	DATE	REVISER	APPD
1		Tolerance change	29/JUN/20	KATE	CHERRY

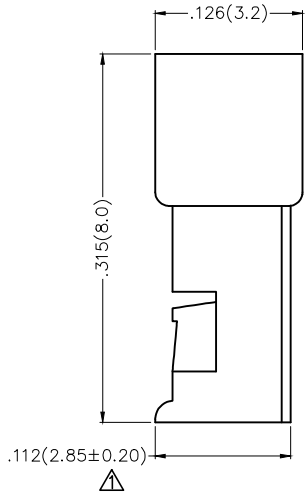
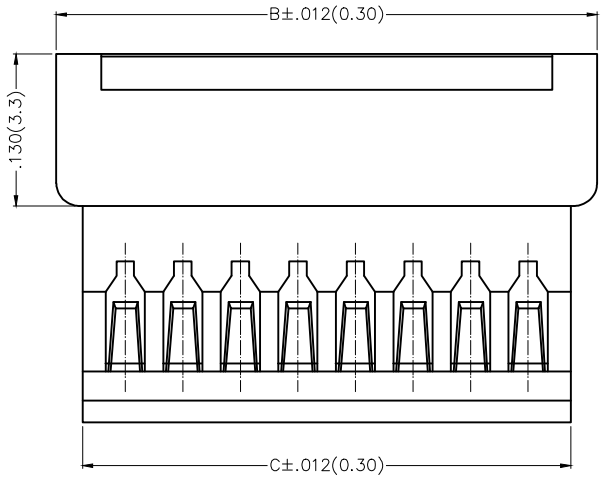
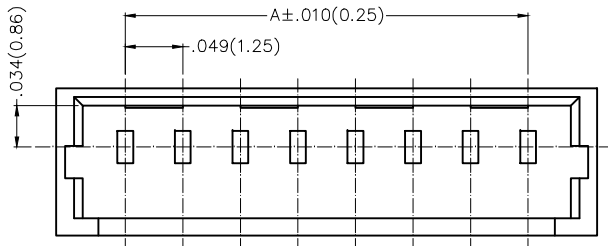

Notes

- Electrical
 Current Rating: 1A AC/DC
 Voltage Rating: 125V AC/DC
 Contact Resistance: 20mΩ Max
 Insulation Resistance: 100MΩ Min
 Withstanding Voltage: 250V AC/minute
 Temperature Range-Operating: -25°C~+85°C
- Material
 PA66, UL94V-0, White
- Applicable Terminal: FT12509-M
- Mates With: FHG12502 Series

Ordering Information

FHG 125 08 — S XX F 2 W1 B
 1 2 3 4 5 6 7 8 9

1	Category	2	Series Number	3	Distinction No.	4	Contact Alignment		
	FHG-Housing		125-Pitch1.25mm		08		S-Single Row		
5	Circuits	6	Type	7	Material-Resin	8	Color-Resin	9	Packaging
	XX		F-Female		2-PA66		W1-White		B-PE Bag

Circuits (n)	Part No.	Dimensions(in/mm)			Circuits (n)	Part No.	Dimensions(in/mm)		
		A	B	C			A	B	C
2	FHG12508-S02F2W1B	.049(1.25)	.173(4.40)	.122(3.10)	8	FHG12508-S08F2W1B	.344(8.75)	.469(11.90)	.417(10.60)
3	FHG12508-S03F2W1B	.098(2.50)	.222(5.65)	.171(4.35)	9	FHG12508-S09F2W1B	.394(10.00)	.518(13.15)	.467(11.85)
4	FHG12508-S04F2W1B	.148(3.75)	.272(6.90)	.220(5.60)	10	FHG12508-S10F2W1B	.443(11.25)	.567(14.40)	.516(13.10)
5	FHG12508-S05F2W1B	.197(5.00)	.321(8.15)	.270(6.85)	11	FHG12508-S11F2W1B	.492(12.50)	.616(15.65)	.565(14.35)
6	FHG12508-S06F2W1B	.246(6.25)	.370(9.60)	.319(8.10)	12	FHG12508-S12F2W1B	.541(13.75)	.665(16.90)	.614(15.60)
7	FHG12508-S07F2W1B	.295(7.50)	.419(10.65)	.368(9.35)					

	GENERAL TOLERANCES (UNLESS SPECIFIED)		APPROVE BY	DATE	PART NO. FHG12508-SXXF2W1B	ITEM NO. FHG12508	
	X.±0.12(0.30)	X.±5'	FRANK	18/JUN/13			
DESIGN UNITS Inch (metric)	X.X±.008(0.20)	X.±2'	CHECKED BY	DATE	TITLE Wire to Board Pitch 1.25mm(Housing)		REV 1 SHEET NO. 1/1
SCALE 5:1	X.XX±.006(0.15)	.XX'±1'	CHERRY	18/JUN/13	THIS DRAWING CONTAINS INFORMATION THAT IS PROPRIETARY TO TXGA INDUSTRIAL ELECTRONICS(S.Z)CO.,LTD AND SHOULD NOT BE USED WITHOUT WRITTEN PERMISSION		
	X.XXX±.004(0.10)	.XXX'±0.5'	DRAWN BY	DATE			
			KATE	18/JUN/13			

X-ON Electronics

Largest Supplier of Electrical and Electronic Components

Click to view similar products for [Headers & Wire Housings](#) category:

Click to view products by [TXGA](#) manufacturer:

Other Similar products are found below :

[0015917161](#) [0022155065](#) [57102-F02-18ULF](#) [58102-G61-06LF](#) [582553-1](#) [01.001.5753.1](#) [0050291907](#) [02.125.8002.8](#) [609-3404](#) [61062-3](#)
[CSU011177004](#) [622-0430](#) [622-3653LF](#) [63453-116](#) [636-1030](#) [636-1427](#) [636-3427](#) [636-4007](#) [641938-9](#) [65495-038](#) [65692-001LF](#) [65781-018](#)
[65781-047](#) [65817-010LF](#) [65817-015LF](#) [67095-007LF](#) [67601157](#) [68631-112](#) [68645-018](#) [699319-000](#) [70.362.1628.0](#) [70-4210](#) [70-4226B](#) [70-](#)
[4853B](#) [71.350.2428.0](#) [733-134](#) [733-162](#) [760-3052](#) [MHR-64-VUAL](#) [80.063.4001.1](#) [800-90-001-10-001000](#) [801-43-002-10-013000](#)
[801-43-006-10-002000](#) [803-43-024-10-001000](#) [803-93-012-10-001000](#) [8-1437020-4](#) [819-22-004-30-001101](#) [820-22-006-30-001101](#)
[820-22-008-30-001101](#) [821-22-002-10-001101](#)