

REV	LOCATIONS	DESCRIPTION	DATE	REVISER	APPD

Electrical
 Current Rating: 2.0A AC/DC
 Voltage Rating: 100V AC/DC
 Contact Resistance: 10mΩ Max
 Insulation Resistance: 1000MΩ Min
 Withstanding Voltage: 800V AC/minute
 Temperature Range-Operating: -25°C~+85°C
Material
 Housing: P66 (UL 94V-0)
 Applicable Terminal: FT20001
 Mates With(Water): FWF20001,FWF20002,FWF20003,FWF20004,
 FWF20014,FWF20015,FWF20016Series

Circuits	Part No.	Dimensions(In/mm)
2	FHG2001-S02M2WB	.228(5.80)
3	FHG2001-S03M2WB	.307(7.80)
4	FHG2001-S04M2WB	.386(9.80)
5	FHG2001-S05M2WB	.465(11.80)
6	FHG2001-S06M2WB	.544(13.80)
7	FHG2001-S07M2WB	.622(15.80)
8	FHG2001-S08M2WB	.701(17.80)
9	FHG2001-S09M2WB	.779(19.80)
10	FHG2001-S10M2WB	.858(21.80)
11	FHG2001-S11M2WB	.937(23.80)
12	FHG2001-S12M2WB	1.016(25.80)
13	FHG2001-S13M2WB	1.094(27.80)
14	FHG2001-S14M2WB	1.173(29.80)
15	FHG2001-S15M2WB	1.252(31.80)
16	FHG2001-S16M2WB	1.331(33.80)

Ordering Information

FHG 200 01 - S XX M 2 W1 B
 1 2 3 4 5 6 7 8 9

- 1 Category FHG-Housing
- 2 Series Number 200-Pitch2.0mm
- 3 Distinction No. 01
- 4 Row Option Single Row
- 5 Circuits XX
- 6 Entry Type M-Male
- 7 Material-Resin 2-PA66
- 8 Color-Resin W1-White
- 9 Packaging B-PE Bag

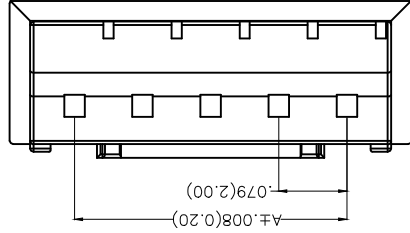
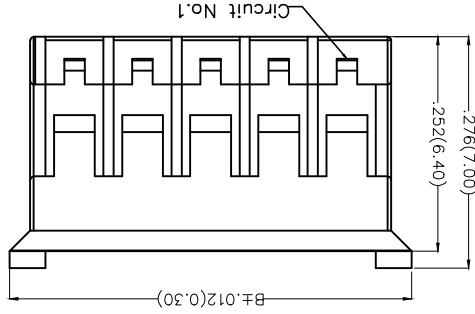
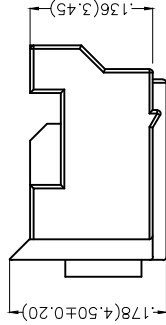

THIRD ANGLE	PROJECTION

GENERAL TOLERANCES (UNLESS SPECIFIED)	APPROVE BY	DATE	PART NO.	ITEM NO.
X.±.012(0.30)	FRANK	25/JUN/13	FHG20001-SXXM2WB	
X.X±.008(0.20)	CHECKED BY	DATE	WIRE TO BOARD	
X.XX±.006(0.15)	JACOB	25/JUN/13	Fitch 2.0mm(Housing)	
X.XXX±.004(0.10)	DRAWN BY	DATE	REV 0	
.XXX±.0.5	CHERRY	25/JUN/13	SHEET NO. 1/1	

SCALE	SIZE	THIS DRAWING CONTAINS INFORMATION THAT IS PROPRIETARY TO TXGA INDUSTRIAL ELECTRONICS(SZ)CO.,LTD AND SHOULD NOT BE USED WITHOUT WRITTEN PERMISSION		
5:1	A4			
DESIGN UNITS	Inch (metric)			
X.±.012(0.30)	X.±.7			
X.X±.008(0.20)	X.X±.1			
X.XXX±.004(0.10)	X.XXX±.0.5			



X-ON Electronics

Largest Supplier of Electrical and Electronic Components

Click to view similar products for [Headers & Wire Housings](#) category:

Click to view products by [TXGA](#) manufacturer:

Other Similar products are found below :

[95000-104TRLF](#) [10135584-644402LF](#) [DF62W-EP2022PCA](#) [95000-106TRLF](#) [DF62W-2022SCA](#) [DF62W-EP2022PC](#) [2203348](#) [DF62W-2022SC](#) [1084018](#) [1029039](#) [1084017](#) [802-10-012-10-002000](#) [1112640](#) [1112639](#) [891-007-9SS-BST1T](#) [000-34000](#) [0008550134](#) [0009482033](#) [0009507031](#) [57102-F02-18ULF](#) [57102-S06-03LF](#) [57202-S52-04LF](#) [PCN6-15S-2.5E](#) [0039019024](#) [58102-G61-06LF](#) [582553-1](#) [0009485154](#) [0009508121](#) [0022285053](#) [0050291907](#) [018731A](#) [LY20-4P-DT1-P1E-BR](#) [02.125.8002.8](#) [60101931](#) [60598-1 \(Cut Strip\)](#) [M1625-3R/100](#) [61062-3](#) [61082-181009](#) [CSU011177004](#) [636-1427](#) [638009-1](#) [641938-9](#) [641991-4](#) [644168-1](#) [644827-2](#) [647662-1](#) [65039-019ELF](#) [65692-001LF](#) [65781-018](#) [65781-047](#)