

REV	LOCATIONS	DESCRIPTION	DATE	REVSER	APPD

Electrical  
 Temperature Range—Operating: -25°C~+85°C  
 Material  
 Housing: PBT (UL 94V-0)  
 Applicable Terminal: FT25402  
 Mates With: WF25404, WF25405Series

Circuits	Part No.	Dimensions(In/mm)	
		A	B
2	FHG25402-S02M2K6B	.100(2.54)	.200(5.08)
3	FHG25402-S03M2K6B	.200(5.08)	.300(7.62)
4	FHG25402-S04M2K6B	.300(7.62)	.400(10.16)
5	FHG25402-S05M2K6B	.400(10.16)	.500(12.70)
6	FHG25402-S06M2K6B	.500(12.70)	.600(15.24)
7	FHG25402-S07M2K6B	.600(15.24)	.700(17.78)
8	FHG25402-S08M2K6B	.700(17.78)	.800(20.32)
9	FHG25402-S09M2K6B	.800(20.32)	.900(22.86)
10	FHG25402-S10M2K6B	.900(22.86)	1.000(25.40)
11	FHG25402-S11M2K6B	1.000(25.40)	1.100(27.94)
12	FHG25402-S12M2K6B	1.100(27.94)	1.299(32.99)

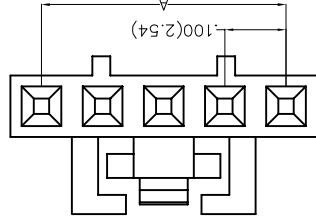
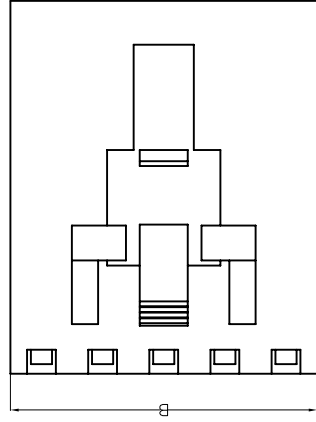
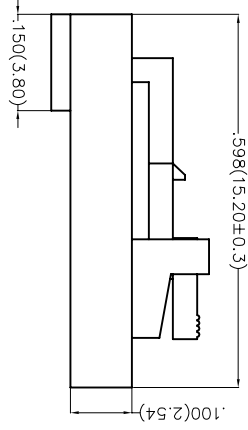

FHG 254 02 - S XX M 2 K6 B  
 1 2 3 4 5 6 7 8 9

Ordering Information

- 1 | Category | FHG-Housing
- 2 | Series Number | 254-Pitch2.54mm
- 3 | Distinction No. | 02
- 4 | Row Option | Single Row
- 5 | Circuits | XX
- 6 | Entry Type | M-Male
- 7 | Material-Resin | 2-PBT
- 8 | Color-Resin | K6-Black
- 9 | Packaging | B-PE Bag

THIRD ANGLE PROJECTION	DESIGN UNITS	X.XX±.012(0.30)	X.XX±.008(0.20)	X.XX±.006(0.15)	X.XX±.004(0.10)
	SCALE	5:1	A4	A4	A4

GENERAL TOLERANCES (UNLESS SPECIFIED)	APPROVE BY	DATE	PART NO.	ITEM NO.
FRANK	25/JUN/13	FHG25402-SXXM2K6B	FHG25402	
CHECKED BY	DATE	TITLE	Wire to Board	
JACOB	25/JUN/13	Pitch 2.54mm(Housing)	REV 0	
DRAWN BY	DATE	THIS DRAWING CONTAINS INFORMATION THAT IS PROPRIETARY TO TXGA INDUSTRIAL ELECTRONICS(SZ)CO.,LTD AND SHOULD NOT BE USED WITHOUT WRITTEN PERMISSION		
CHERRY	25/JUN/13	SHEET NO. 1/1		



## X-ON Electronics

Largest Supplier of Electrical and Electronic Components

*Click to view similar products for [Headers & Wire Housings](#) category:*

*Click to view products by [TXGA](#) manufacturer:*

Other Similar products are found below :

[95000-104TRLF](#) [10135584-644402LF](#) [DF62W-EP2022PCA](#) [95000-106TRLF](#) [DF62W-2022SCA](#) [DF62W-EP2022PC](#) [2203348](#) [DF62W-2022SC](#) [1084018](#) [1029039](#) [1084017](#) [802-10-012-10-002000](#) [1112640](#) [1112639](#) [891-007-9SS-BST1T](#) [000-34000](#) [0008550134](#) [0009482033](#) [0009507031](#) [57102-F02-18ULF](#) [57102-S06-03LF](#) [57202-S52-04LF](#) [PCN6-15S-2.5E](#) [0039019024](#) [58102-G61-06LF](#) [582553-1](#) [0009485154](#) [0009508121](#) [0022285053](#) [0050291907](#) [018731A](#) [LY20-4P-DT1-P1E-BR](#) [02.125.8002.8](#) [60101931](#) [60598-1 \(Cut Strip\)](#) [M1625-3R/100](#) [61062-3](#) [61082-181009](#) [CSU011177004](#) [636-1427](#) [638009-1](#) [641938-9](#) [641991-4](#) [644168-1](#) [644827-2](#) [647662-1](#) [65039-019ELF](#) [65692-001LF](#) [65781-018](#) [65781-047](#)