

REV	LOCATIONS	DESCRIPTION	DATE	REVISER	APPD
1	△	Size changes	12/MAY/21	KATE	CHERRY

Electrical  
 Temperature Range—Operating: -25°C~+85°C  
 Material  
 Housing:PBT( UL 94V-0)  
 Applicable Terminal: FT25402  
 Mates With: FWF25404,FWF25405 Series

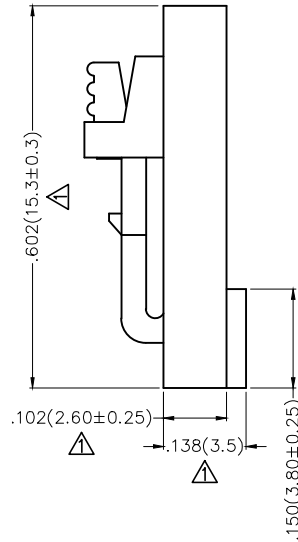

Circuits (n)	Part No.	Dimensions(in/mm)	
		A	B
2	FHG25402-S02M2K6B	.100(2.54)	.200(5.08)
3	FHG25402-S03M2K6B	.200(5.08)	.300(7.62)
4	FHG25402-S04M2K6B	.300(7.62)	.400(10.16)
5	FHG25402-S05M2K6B	.400(10.16)	.500(12.70)
6	FHG25402-S06M2K6B	.500(12.70)	.600(15.24)
7	FHG25402-S07M2K6B	.600(15.24)	.700(17.78)
8	FHG25402-S08M2K6B	.700(17.78)	.800(20.32)
9	FHG25402-S09M2K6B	.800(20.32)	.900(22.86)
10	FHG25402-S10M2K6B	.900(22.86)	1.000(25.40)
11	FHG25402-S11M2K6B	1.000(25.40)	1.100(27.94)
12	FHG25402-S12M2K6B	1.100(27.94)	1.200(30.48)

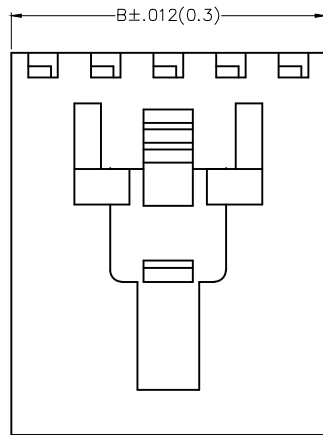
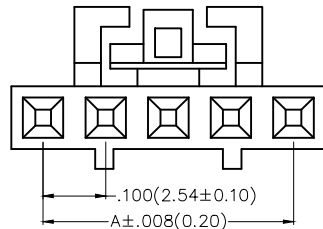

### Ordering Information

FHG 254 02 — S XX M 2 K6 B  
 1 2 3 4 5 6 7 8 9

1	Category FHG—Housing	2	Series Number 254—Pitch2.54mm	3	Distinction No. 02	4	Row Option Single Row	5	Circuits XX
6	Entry Type M—Male	7	Material—Resin 2—PBT	8	Color—Resin K6—Black	9	Packaging B—PE Bag		

THIRD ANGLE PROJECTION		GENERAL TOLERANCES (UNLESS SPECIFIED)		APPROVE BY	DATE	PART NO.	ITEM NO.	TXGA Leader Of Industry
DESIGN UNITS Inch (metric)	SCALE	SIZE	X.±.012(0.30)	FRANK	25/JUN/13	FHG25402-SXXM2K6B	FHG25402	
	5:1	A4	X.X±.008(0.20)	CHECKED BY	DATE	TITLE Wire to Board Pitch 2.54mm(Housing)		
				X.XX±.006(0.15)	JACOB	25/JUN/13	THIS DRAWING CONTAINS INFORMATION THAT IS PROPRIETARY TO TXGA INDUSTRIAL ELECTRONICS(S.Z)CO.,LTD AND SHOULD NOT BE USED WITHOUT WRITTEN PERMISSION	
			X.XXX±.004(0.10)	DRAWN BY	DATE			
			X.XX±1*	CHERRY	25/JUN/13			
			X.XX±0.5*					

## X-ON Electronics

Largest Supplier of Electrical and Electronic Components

*Click to view similar products for [Headers & Wire Housings](#) category:*

*Click to view products by [TXGA](#) manufacturer:*

Other Similar products are found below :

[0015917161](#) [0022155065](#) [57102-F02-18ULF](#) [58102-G61-06LF](#) [582553-1](#) [01.001.5753.1](#) [0050291907](#) [02.125.8002.8](#) [609-3404](#) [61062-3](#)  
[CSU011177004](#) [622-0430](#) [622-3653LF](#) [63453-116](#) [636-1030](#) [636-1427](#) [636-3427](#) [636-4007](#) [641938-9](#) [65495-038](#) [65692-001LF](#) [65781-018](#)  
[65781-047](#) [65817-010LF](#) [65817-015LF](#) [67095-007LF](#) [67601157](#) [68631-112](#) [68645-018](#) [699319-000](#) [70.362.1628.0](#) [70-4210](#) [70-4226B](#) [70-](#)  
[4853B](#) [71.350.2428.0](#) [733-134](#) [733-162](#) [760-3052](#) [MHR-64-VUAL](#) [80.063.4001.1](#) [800-90-001-10-001000](#) [801-43-002-10-013000](#)  
[801-43-006-10-002000](#) [803-43-024-10-001000](#) [803-93-012-10-001000](#) [8-1437020-4](#) [819-22-004-30-001101](#) [820-22-006-30-001101](#)  
[820-22-008-30-001101](#) [821-22-002-10-001101](#)