

| | | | | | |
|-----|-----------|-------------|------|----------|------|
| REV | LOCATIONS | DESCRIPTION | DATE | REVERSER | APPD |
| | | | | | |

Electrical
 Temperature Range-Operating: -40°C~+105°C
 Housing: PA66(UL 94V-0)
 Applicable Terminal: FT30001
 Mates With: FHG30003Series

| Circuits (n) | Part No. | Dimensions(mm) | |
|-----------------|-------------------|----------------|--------------|
| | | A | B |
| 2 | FHG30001-D02M2K6B | — | .152(3.85) |
| 4 | FHG30001-D04M2K6B | .118(3.00) | .270(6.85) |
| 6 | FHG30001-D06M2K6B | .236(6.00) | .368(9.85) |
| 8 | FHG30001-D08M2K6B | .354(9.00) | .506(12.85) |
| 10 | FHG30001-D10M2K6B | .472(12.00) | .624(15.85) |
| 12 | FHG30001-D12M2K6B | .591(15.00) | .742(18.85) |
| 14 | FHG30001-D14M2K6B | .709(18.00) | .860(21.85) |
| 16 | FHG30001-D16M2K6B | .827(21.00) | .978(24.85) |
| 18 | FHG30001-D18M2K6B | .945(24.00) | 1.096(27.85) |
| 20 | FHG30001-D20M2K6B | 1.063(27.00) | 1.215(30.85) |
| 22 | FHG30001-D22M2K6B | 1.181(30.00) | 1.333(33.85) |
| 24 | FHG30001-D24M2K6B | 1.299(33.00) | 1.451(36.85) |

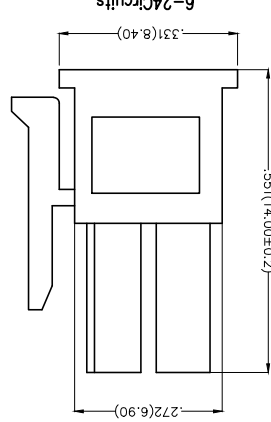
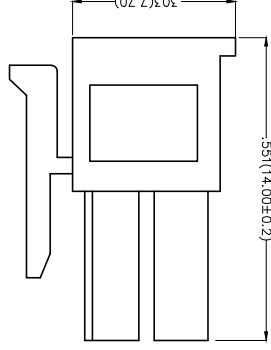
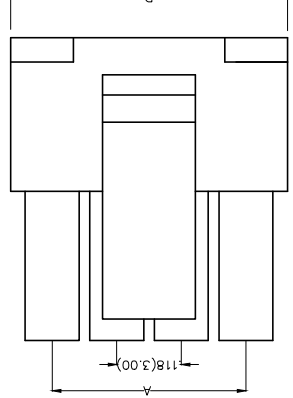
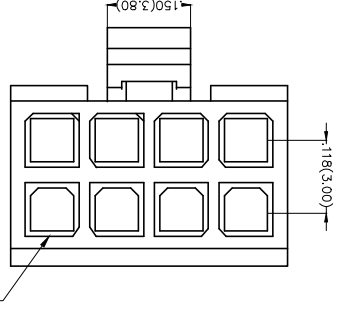

Ordering Information

FHG 300 01 - D XX M 2 K 6 B
 1 2 3 4 5 6 7 8 9

- 1 Category FHG-Housing
- 2 Series Number 300-Pitch3.0mm
- 3 Distinction No. 01
- 4 Row Option D-Double Row
- 5 Circuits XX
- 6 Entry Type M-Male
- 7 Material-Resin 2-PA66
- 8 Color-Resin K6-Black
- 9 Packaging B-PE Bag

| | | | | | | | | | | | | | |
|------------------------|---------------|----------------|-----------------|------------|-----------|--------------------|----------|--------|-----------|-----------|--------------------------------------------------------------------------------------------------------------------------------------------------|----------|---------------|
| THIRD ANGLE PROJECTION | DESIGN UNITS | X.±.012(0.30) | X.±.5 | DATE | 25/JUN/13 | APPROVE BY | FRANK | DATE | 25/JUN/13 | PART NO. | FHG30001-DXXM2K6B | ITEM NO. | FHG30001 |
| | INCH (metric) | X.X±.008(0.20) | X.±.2 | CHECKED BY | JACOB | (UNLESS SPECIFIED) | | DATE | 25/JUN/13 | TITLE | Wire to Board Pitch 3.0mm(Housing) | REV 0 | SHEET NO. 1/1 |
| SCALE | SIZE | A4 | X.XX±.004(0.10) | XXX±0.5 | DATE | 25/JUN/13 | DRAWN BY | CHEERY | DATE | 25/JUN/13 | THIS DRAWING CONTAINS INFORMATION THAT IS PROPRIETARY TO TXGA INDUSTRIAL ELECTRONICS(Z)CO.,LTD AND SHOULD NOT BE USED WITHOUT WRITTEN PERMISSION | | |



Leader Of Industry

X-ON Electronics

Largest Supplier of Electrical and Electronic Components

Click to view similar products for [Headers & Wire Housings](#) category:

Click to view products by [TXGA](#) manufacturer:

Other Similar products are found below :

[95000-104TRLF](#) [10135584-644402LF](#) [DF62W-EP2022PCA](#) [95000-106TRLF](#) [DF62W-2022SCA](#) [DF62W-EP2022PC](#) [2203348](#) [DF62W-2022SC](#) [1084018](#) [1029039](#) [1084017](#) [802-10-012-10-002000](#) [1112640](#) [1112639](#) [891-007-9SS-BST1T](#) [000-34000](#) [0008550134](#) [0009482033](#) [0009507031](#) [57102-F02-18ULF](#) [57102-S06-03LF](#) [57202-S52-04LF](#) [PCN6-15S-2.5E](#) [0039019024](#) [58102-G61-06LF](#) [582553-1](#) [0009485154](#) [0009508121](#) [0022285053](#) [0050291907](#) [018731A](#) [LY20-4P-DT1-P1E-BR](#) [02.125.8002.8](#) [60101931](#) [60598-1 \(Cut Strip\)](#) [M1625-3R/100](#) [61062-3](#) [61082-181009](#) [CSU011177004](#) [636-1427](#) [638009-1](#) [641938-9](#) [641991-4](#) [644168-1](#) [644827-2](#) [647662-1](#) [65039-019ELF](#) [65692-001LF](#) [65781-018](#) [65781-047](#)