

REV	1	LOCATIONS	▽
DATE	02/JUL/19	DESCRIPTION	Size change
REVSER	FRANK	DATE	02/JUL/19
APPD	FRANK	REVSER	APPD

Electrical
 Temperature Range—Operating: -40°C~+105°C

Material
 Housing: PA66 UL 94V-0)
 Applicable Terminal: FT42001
 Mates With: FWF42001,FWF42002,FWF42003,FWF42004Series.

Circuits (n)	Part No.	Dimensions(in/mm)	
		A	B
2	FHG42001-D02M2TB	—	.213(5.40)
4	FHG42001-D04M2TB	.165(4.20)	.379(9.60)
6	FHG42001-D06M2TB	.331(8.40)	.543(13.80)
8	FHG42001-D08M2TB	.496(12.60)	.709(18.00)
10	FHG42001-D10M2TB	.661(16.80)	.874(22.20)
12	FHG42001-D12M2TB	.827(21.00)	1.039(26.40)
14	FHG42001-D14M2TB	.992(25.20)	1.205(30.60)
16	FHG42001-D16M2TB	1.157(29.40)	1.377(35.00)√
18	FHG42001-D18M2TB	1.323(33.60)	1.535(39.00)
20	FHG42001-D20M2TB	1.488(37.80)	1.700(43.20)
22	FHG42001-D22M2TB	1.654(42.00)	1.866(47.40)
24	FHG42001-D24M2TB	1.819(46.20)	2.031(51.60)

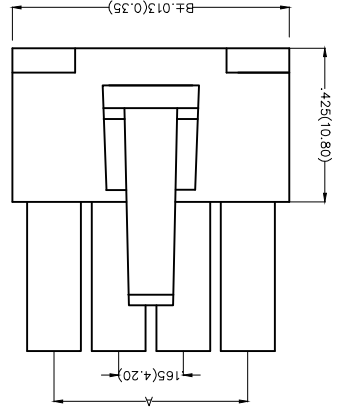
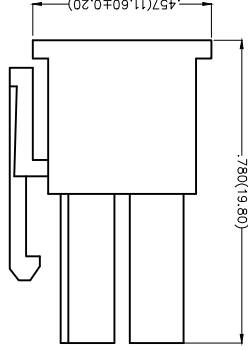
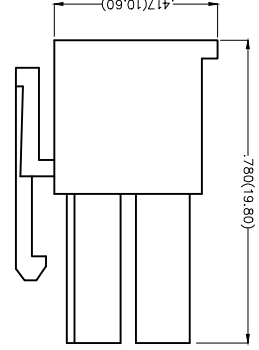
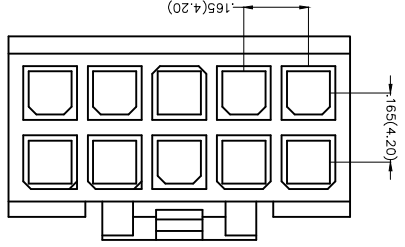

Ordering Information

FHG 420 01 - D XX M 2 / T B
 1 2 3 4 5 6 7 8 9

- 1 Category FHG-Housing
- 2 Series Number 420-Pitch4.2mm
- 3 Distinction No. 01
- 4 Row Option Double Row
- 5 Circuits XX
- 6 Entry Type M-Male
- 7 Material-Resin 2-PA66
- 8 Color-Resin T-Transparent
- 9 Packaging B-PE Bag

THIRD ANGLE PROJECTION

GENERAL TOLERANCES (UNLESS SPECIFIED)

DATE	02/JUL/19
APPROVE BY	FRANK
CHECKED BY	JACOB
DATE	02/JUL/19
DRAWN BY	Aubrey
DATE	02/JUL/19

DESIGN UNITS	Inch (metric)
SCALE	5:1
SIZE	A4
GENERAL TOLERANCES (UNLESS SPECIFIED)	X±.012(0.30)
	X±.008(0.20)
	X±.006(0.15)
	X±.004(0.10)
	XXX±0.5°

THIS DRAWING CONTAINS INFORMATION THAT IS PROPRIETARY TO TXGA INDUSTRIAL ELECTRONICS(S)Z)CO.,LTD AND SHOULD NOT BE USED WITHOUT WRITTEN PERMISSION



PART NO. FHG42001-DXXM2TB
 ITEM NO. FHG42001
 TITLE Wire to Board
 Pitch 4.2mm(Housing)
 REV 1 SHEET NO. 1/1

X-ON Electronics

Largest Supplier of Electrical and Electronic Components

Click to view similar products for [Headers & Wire Housings](#) category:

Click to view products by [TXGA](#) manufacturer:

Other Similar products are found below :

[95000-104TRLF](#) [10135584-644402LF](#) [DF62W-EP2022PCA](#) [95000-106TRLF](#) [DF62W-2022SCA](#) [DF62W-EP2022PC](#) [2203348](#) [DF62W-2022SC](#) [1084018](#) [1029039](#) [1084017](#) [802-10-012-10-002000](#) [1112640](#) [1112639](#) [891-007-9SS-BST1T](#) [000-34000](#) [0008550134](#) [0009482033](#) [0009507031](#) [57102-F02-18ULF](#) [57102-S06-03LF](#) [57202-S52-04LF](#) [PCN6-15S-2.5E](#) [0039019024](#) [58102-G61-06LF](#) [582553-1](#) [0009485154](#) [0009508121](#) [0022285053](#) [0050291907](#) [018731A](#) [LY20-4P-DT1-P1E-BR](#) [02.125.8002.8](#) [60101931](#) [60598-1 \(Cut Strip\)](#) [M1625-3R/100](#) [61062-3](#) [61082-181009](#) [CSU011177004](#) [636-1427](#) [638009-1](#) [641938-9](#) [641991-4](#) [644168-1](#) [644827-2](#) [647662-1](#) [65039-019ELF](#) [65692-001LF](#) [65781-018](#) [65781-047](#)