

Recommended P.C.Board Layout

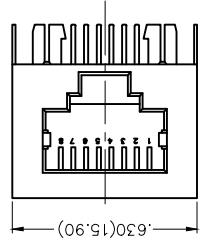
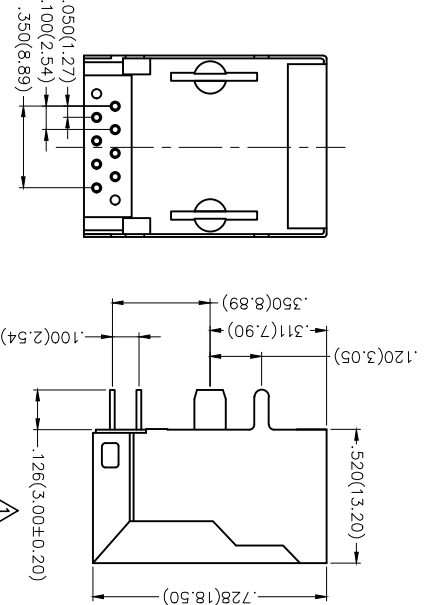
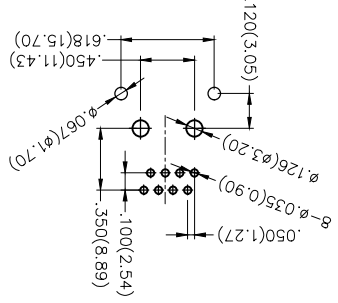

SCALE	5:1	A4	GENERAL TOLERANCES (UNLESS SPECIFIED)	APPROVE BY	DATE	PART NO.	ITEM NO.
DESIGN UNITS	Inch (metric)	X.XX±.006(0.15)	X.XX±.012(0.30)	FRANK	1/AUG/13	FRJ45010-11XXK6K02D0	FRJ45010
THIRD ANGLE PROJECTION		X.XX±.004(0.10)	X.XX±.05	CHEERY	1/AUG/13		
		X.XX±.006(0.15)	X.XX±.1	JACOB	1/AUG/13		

1	Category	FRJ45-RJ45 Connector
2	Distinction No.	010
3	Ports options	1-1 Port
4	Plating	1-Gold Plated
5	Thickness of plating	00-Gold flash 03-3μ Custom plate available
6	Color-Resin	K6-Black
7	Packaging	K-Tray
8	Contact type	2-Round pin
9	distinction type	D-D type

Ordering Information  
 FRJ45 010 - 1 1 XX K6 K 0 2 D 0

**SPECIFICATIONS**  
 Electrical Performances  
 Current Rating: 1.5A AC(rms)/DC  
 Voltage Rating: 125V AC(rms)/DC  
 Contact Resistance: 30 mΩ Max  
 Insulation Resistance: 500 MΩ MIN  
 Withstanding Voltage: 1000V AC r.m.s  
 Temperature Range: -40°C~+85°C  
 Material and Plating  
 Housing: PBT UL 94V-0  
 Contact: Phosphor Bronze/Gold Plated  
 Shell: Copper Alloy/Nickel Plated

REV	1	LOCATIONS	
DESCRIPTION	1. Dimension: Change 3.2 into 3.00±0.20mm		
DATE	01/JUN/18	REVERSE	APPD
DATE		REVERSE	APPD



THIS DRAWING CONTAINS INFORMATION THAT IS PROPRIETARY TO TXGA INDUSTRIAL ELECTRONICS(SZ)CO.,LTD AND SHOULD NOT BE USED WITHOUT WRITTEN PERMISSION  
 DATE 1/AUG/13  
 DRAWN BY JACOB  
 CHECKED BY CHEERY  
 APPROVE BY FRANK  
 DATE 1/AUG/13  
 DATE 1/AUG/13  
 DATE 1/AUG/13  
 DATE 1/AUG/13  
 REV 1  
 SHEET NO. 1/1

## X-ON Electronics

Largest Supplier of Electrical and Electronic Components

*Click to view similar products for [Modular Connectors](#) / [Ethernet Connectors](#) category:*

*Click to view products by [TXGA](#) manufacturer:*

Other Similar products are found below :

[RJE231881317T](#) [MP1010RX-1000](#) [MP44RX-1000](#) [GAX-3-66](#) [GAX-8-62](#) [93606-0253](#) [GD-A-44](#) [GDCX-PA-66-50](#) [GDCX-PN-64](#) [GDCX-PN-66](#) [GDCX-PN-66-50](#) [GDLX-A-66](#) [GDLX-A-88](#) [GDLX-N-66](#) [GDLX-S-88K](#) [GDTX-S-88-50](#) [GDX-PA-1010](#) [GLX-N-1010M-BLK](#) [GLX-N-44M](#) [GLX-S-88M-BLK](#) [GMX-N-1010](#) [GMX-S-1010](#) [GMX-S-66](#) [GMX-SMT2-N-1010](#) [GMX-SMT2-N-64-50](#) [GMX-SMT2-S6-88](#) [GMX-SMT4-N-88](#) [GPX-2-64](#) [GRT1-BT1-5](#) [GSGX-N-2-88](#) [GSX-NS2-88-3.05](#) [GSX-NS2-88-3.05-50](#) [GSX-NS-88-3.05-30](#) [GSX-NS-88-3.05-50](#) [GSX-NS-88-3.68](#) [1-1775629-2](#) [GWLX-S-88-GR](#) [GWLX-S9-88-YG](#) [1300500326](#) [1300500227](#) [1300530003](#) [1300570002](#) [1324640-4](#) [RJ11FTVC2G](#) [RJ11FTVC2N](#) [RJFTVX2SA1G](#) [132764-001](#) [1400000](#) [1413176](#) [1413235](#)