

REV	LOCATIONS	DESCRIPTION	DATE	REVISER	APPD

Electrical
 Current Rating: 1.0A AC(rms)/DC
 Voltage Rating: 125V AC(rms)/DC
 Contact Resistance: 20 mΩ Max
 Insulation Resistance: 100 MΩ MIN
 Withstanding Voltage: 250V AC r.m.s
 Temperature Range—Operating: -25°C~+85°C
 Material and Plating
 Housing: PA9T (UL 94V-0)
 Contact Pin: Brass/ Tin plated
 Solder Tab: Copper alloy/ Tin plated

Circuits (n)	Part No.	Dimensions(in/mm)		
		A	B	C
2	FWF12514-S02B24W5M	.049(1.25)	.226(5.75)	.087(2.20)
3	FWF12514-S03B24W5M	.098(2.50)	.276(7.00)	.130(3.30)
4	FWF12514-S04B24W5M	.147(3.75)	.325(8.25)	.179(4.55)
5	FWF12514-S05B24W5M	.197(5.00)	.374(9.50)	.179(4.55)
6	FWF12514-S06B24W5M	.246(6.25)	.423(10.75)	.258(6.55)
7	FWF12514-S07B24W5M	.295(7.50)	.472(12.00)	.258(6.55)
8	FWF12514-S08B24W5M	.344(8.75)	.522(13.25)	.258(6.55)
9	FWF12514-S09B24W5M	.394(10.00)	.571(14.50)	.258(6.55)
10	FWF12514-S10B24W5M	.443(11.25)	.620(15.75)	.337(8.55)
11	FWF12514-S11B24W5M	.492(12.50)	.669(17.00)	.337(8.55)
12	FWF12514-S12B24W5M	.541(13.75)	.719(18.25)	.337(8.55)

Ordering Information

1	2	3	4	5	6	7	8	9	10
FWF 125 14 - S XX B 2 4 W5 M	Series Number	Distinction No.	Row Option	Color-Resin	Material-Resin	Plating	Entry Angle	Category	Package
14 - S	125-Pitch1.25mm	14	S-Single Row	WS-White	4-PA9T	2-Tin Plated	B-90° Angle	FWF-Water	M-Reel
XX	14	14	XX	WS	4-PA9T	2-Tin Plated	B-90° Angle	FWF-Water	XX

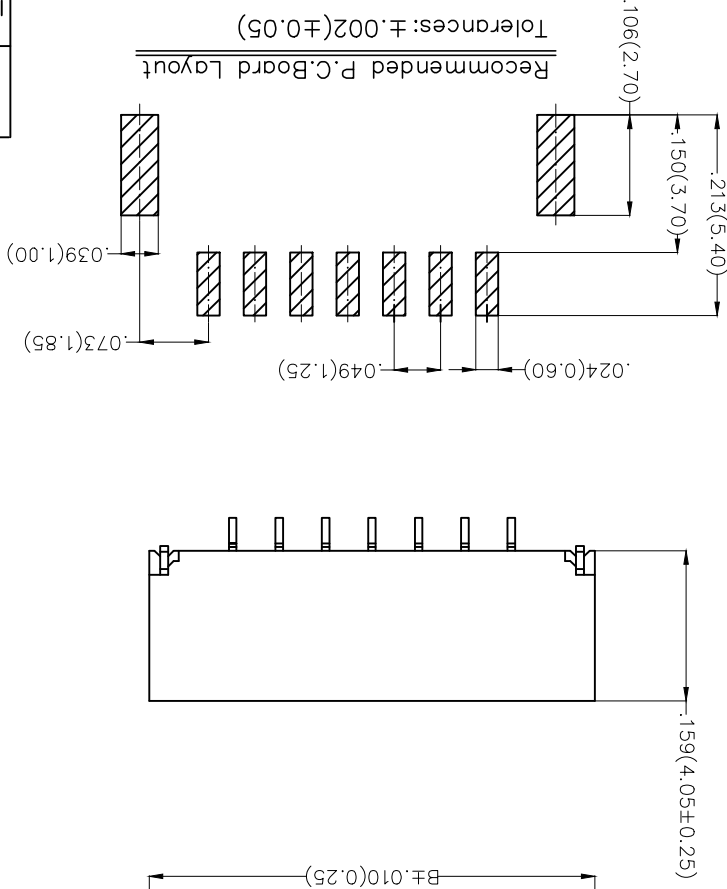
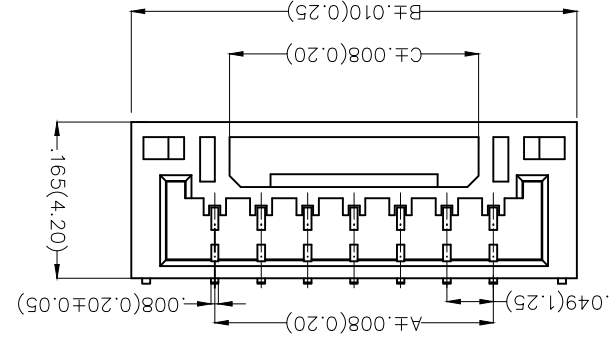
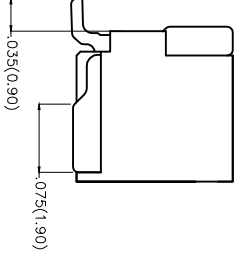

APPROVE BY	DATE	PART NO.	ITEM NO.
FRANK	8/JUL/13	FWF12514-SXXB24W5M	FWF12514
CHECKED BY	DATE	TITLE	REV
JACOB	8/JUL/13	Wire to Board (Water) Pitch 1.25mm 90° Angle (SMT)	0
DRAWN BY	DATE	THIS DRAWING CONTAINS INFORMATION THAT IS PROPRIETARY TO TXGA INDUSTRIAL ELECTRONICS(SZ)CO.,LTD AND SHOULD NOT BE USED WITHOUT WRITTEN PERMISSION	
CHERRY	8/JUL/13	SHEET NO. 1/2	



TXGA
Leader Of Industry

REV 0
SHEET NO. 1/2

SCALE
5:1
A4

DESIGN UNITS
Inch (metric)

THIRD ANGLE PROJECTION

GENERAL TOLERANCES (UNLESS SPECIFIED)
X±.5
X.X±.008(0.20)
X.XXX±.004(0.10)

Recommended P.C. Board Layout
Tolerances: ±.002(±0.05)

THIRD ANGLE	PROJECTION	DESIGN UNITS	SCALE
		Inch (metric)	5:1
		X.XX±.008(0.20)	A4
		X.XX±.006(0.15)	

GENERAL TOLERANCES (UNLESS SPECIFIED)	APPROVE BY	DATE	PART NO.
X.±.012(0.30)	FRANK	8/JUL/13	FWF12514-SXXB24W5M
X.±.7	CHECKED BY	DATE	TITLE
X.±.1	JACOB	8/JUL/13	Wire to Board (Water)
X.XX±.004(0.10)	DRAWN BY	DATE	Pitch 1.25mm 90° Angle (SMT)
.XXX±.0.5	CHERRY	8/JUL/13	REV 0

THIS DRAWING CONTAINS INFORMATION THAT IS PROPRIETARY TO TXGA INDUSTRIAL ELECTRONICS(SZ)CO.,LTD AND SHOULD NOT BE USED WITHOUT WRITTEN PERMISSION

ITEM NO. FWF12514

Leader Of Industry

TXGA

SHEET NO. 2/2

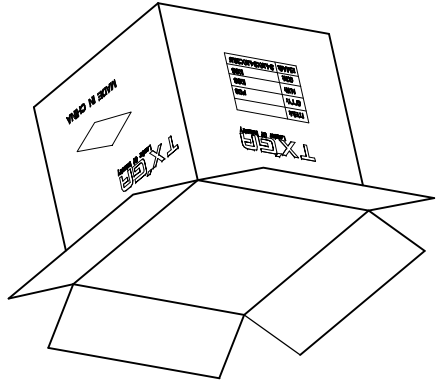
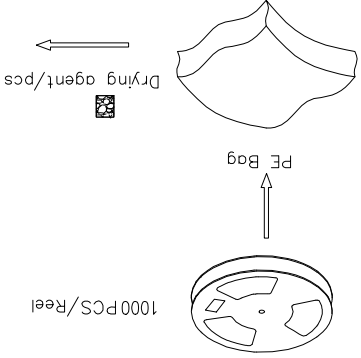
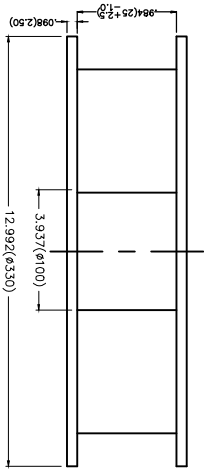
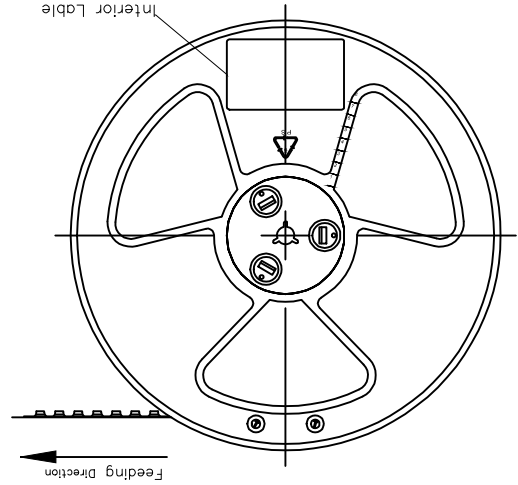
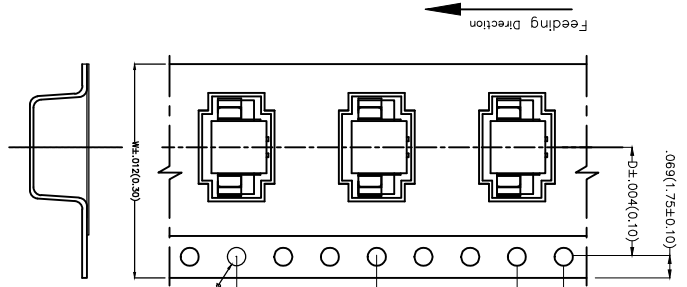

Drills (in)	Dimensions(in/mm)	Drills (in)	Dimensions(in/mm)
2	.295(7.50)	10	.559(14.20)
3	.295(7.50)	11	.559(14.20)
4	.453(11.50)	12	.559(14.20)
5	.453(11.50)		.945(24.00)
6	.453(11.50)		.945(24.00)
7	.559(14.20)		1.260(32.00)
8	.559(14.20)		1.260(32.00)
9	.559(14.20)		1.260(32.00)

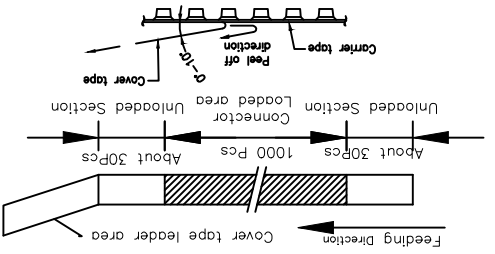

- Note:
1. 10 sprocket hole cumulative tolerance±0.2
 2. Carrier camber is within 1.0mm in 100mm
 3. Material: White Conductive polystyrene Alloy 100% recyclable
 4. All dimensions meet EIA-481-3 requirements
 5. Component load per 13" reel: 1000 pcs

REV	LOCATIONS	DESCRIPTION	DATE	REVISER	APPD

X-ON Electronics

Largest Supplier of Electrical and Electronic Components

Click to view similar products for [Headers & Wire Housings](#) category:

Click to view products by [TXGA](#) manufacturer:

Other Similar products are found below :

[95000-104TRLF](#) [10135584-644402LF](#) [DF62W-EP2022PCA](#) [95000-106TRLF](#) [DF62W-2022SCA](#) [DF62W-EP2022PC](#) [2203348](#) [DF62W-2022SC](#) [1084018](#) [1029039](#) [1084017](#) [802-10-012-10-002000](#) [1112640](#) [1112639](#) [891-007-9SS-BST1T](#) [000-34000](#) [0008550134](#) [0009482033](#) [0009507031](#) [57102-F02-18ULF](#) [57102-S06-03LF](#) [57202-S52-04LF](#) [PCN6-15S-2.5E](#) [0039019024](#) [58102-G61-06LF](#) [582553-1](#) [0009485154](#) [0009508121](#) [0022285053](#) [0050291907](#) [018731A](#) [LY20-4P-DT1-P1E-BR](#) [02.125.8002.8](#) [60101931](#) [60598-1 \(Cut Strip\)](#) [M1625-3R/100](#) [61062-3](#) [61082-181009](#) [CSU011177004](#) [636-1427](#) [638009-1](#) [641938-9](#) [641991-4](#) [644168-1](#) [644827-2](#) [647662-1](#) [65039-019ELF](#) [65692-001LF](#) [65781-018](#) [65781-047](#)