

REV	LOCATIONS	DESCRIPTION	DATE	REVISER	APPD

**Electrical**  
 Current Rating: 3.0A AC(rms)/DC  
 Voltage Rating: 250V AC(rms)/DC  
 Contact Resistance: 20 mΩ Max  
 Insulation Resistance: 1000 MΩ MIN  
 Withstanding Voltage: 1000V AC r.m.s  
 Temperature Range-Operating: -25°C~+85°C  
 Material and Plating  
 Housing: P66 (UL 94V-2)  
 Contact Pin: Brass  
 Plating: Tin Plated

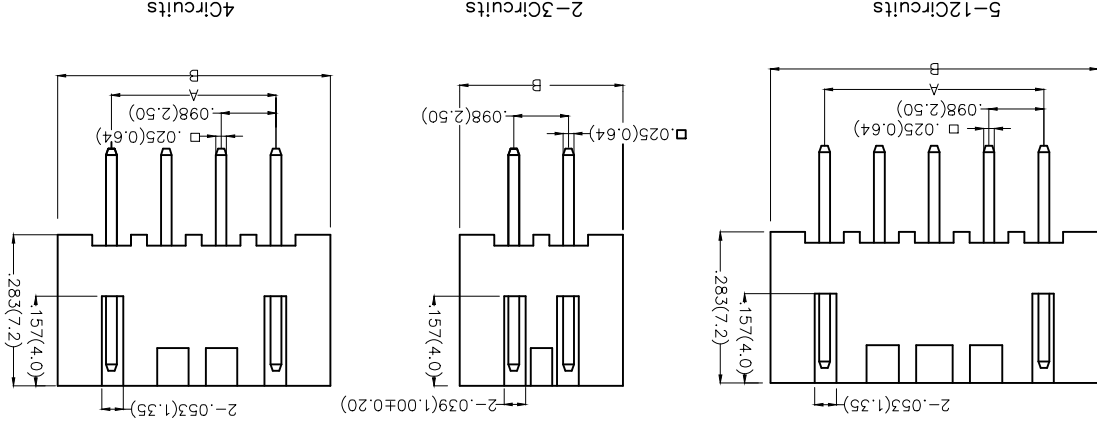
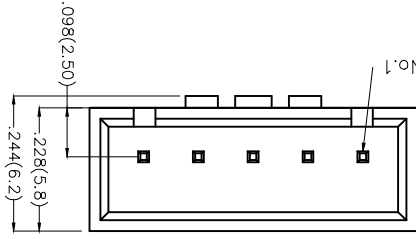
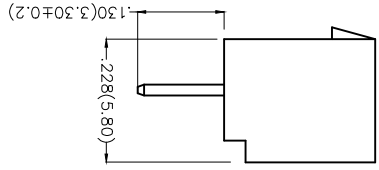

### Ordering Information

1	Category	FWF-Water
2	Series Number	250-Pitch 2.5mm
3	Distinction No.	12
4	Row Option	S-Single Row
5	Circuits	XX
6	Entry Angle	S-180° Vertical
7	Plating	2-Tin Plated
8	Material-Resin	2-P66
9	Color-Resin	W1-White R1-Red N1-Green ... U1-Blue
10	Packaging	B-PE Bag

DATE	01/MAY/14
CHECKED BY	FRANK
APPROVE BY	JACOB
DATE	01/MAY/14
DRAWN BY	CHEERY
SCALE	5:1
SIZE	A4

**TXGR**  
 Leader Of Industry

GENERAL TOLERANCES (UNLESS SPECIFIED)	X.±.12(0.30)
DESIGN UNITS	Inch (metric)
THIRD ANGLE PROJECTION	
GENERAL TOLERANCES (UNLESS SPECIFIED)	X.±.12(0.30)
CHECKED BY	FRANK
DATE	01/MAY/14
PART NO.	FWF25012-SXXS22XXB
ITEM NO.	FWF25012
TITLE	Wire to Board (Water) Pitch 2.5mm 180° Vertical (DIP)
REV 0	SHEET NO. 1/2
THIS DRAWING CONTAINS INFORMATION THAT IS PROPRIETARY TO TXGA INDUSTRIAL ELECTRONICS(SZ)CO.,LTD AND SHOULD NOT BE USED WITHOUT WRITTEN PERMISSION	

Recommended P.C.Board Layout

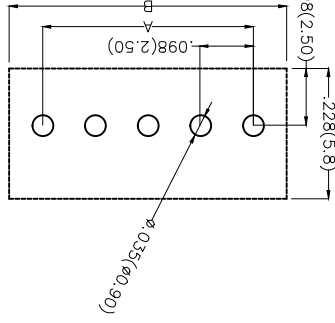

REV	LOCATIONS	DESCRIPTION	DATE	REVISER	APPD

Circuits (n)	Part No.	Dimensions(in/mm)	
		A	B
2	FWF25012-S02S22XXB	.098(2.50)	.295(7.50)
3	FWF25012-S03S22XXB	.197(5.00)	.394(10.00)
4	FWF25012-S04S22XXB	.295(7.50)	.492(12.50)
5	FWF25012-S05S22XXB	.394(10.00)	.591(15.00)
6	FWF25012-S06S22XXB	.492(12.50)	.689(17.50)
7	FWF25012-S07S22XXB	.591(15.00)	.787(20.00)
8	FWF25012-S08S22XXB	.689(17.50)	.886(22.50)
9	FWF25012-S09S22XXB	.787(20.00)	.984(25.00)
10	FWF25012-S10S22XXB	.886(22.50)	1.083(27.50)
11	FWF25012-S11S22XXB	.984(25.00)	1.181(30.00)
12	FWF25012-S12S22XXB	1.083(27.50)	1.279(32.50)



THIRD ANGLE PROJECTION

DESIGN UNITS  
Inch (metric)

SCALE  
SIZE  
5:1  
A4

GENERAL TOLERANCES  
(UNLESS SPECIFIED)

X.±.012(0.30)

X.±.008(0.20)

X.XX±.004(0.10)

APPROVE BY  
FRANK

CHECKED BY  
X.±.5

DRAWN BY  
CHERRY

JACOB

DATE  
01/MAY/14

DATE  
01/MAY/14

DATE  
01/MAY/14

01/MAY/14

PART NO.

FWF25012-SXXS22XXB

ITEM NO.

FWF25012

DATE

DATE

DATE

Wire to Board (Water)

Pitch 2.5mm 180° Vertical (DIP)

THIS DRAWING CONTAINS INFORMATION THAT IS PROPRIETARY TO TXGA INDUSTRIAL ELECTRONICS(SZ)CO.,LTD AND SHOULD NOT BE USED WITHOUT WRITTEN PERMISSION

**TXGA**  
Leader Of Industry

REV 0

SHEET NO. 2/2

8

## X-ON Electronics

Largest Supplier of Electrical and Electronic Components

*Click to view similar products for [Headers & Wire Housings](#) category:*

*Click to view products by [TXGA](#) manufacturer:*

Other Similar products are found below :

[95000-104TRLF](#) [10135584-644402LF](#) [DF62W-EP2022PCA](#) [95000-106TRLF](#) [DF62W-2022SCA](#) [DF62W-EP2022PC](#) [2203348](#) [DF62W-2022SC](#) [1084018](#) [1029039](#) [1084017](#) [802-10-012-10-002000](#) [1112640](#) [1112639](#) [891-007-9SS-BST1T](#) [000-34000](#) [0008550134](#) [0009482033](#) [0009507031](#) [57102-F02-18ULF](#) [57102-S06-03LF](#) [57202-S52-04LF](#) [PCN6-15S-2.5E](#) [0039019024](#) [58102-G61-06LF](#) [582553-1](#) [0009485154](#) [0009508121](#) [0022285053](#) [0050291907](#) [018731A](#) [LY20-4P-DT1-P1E-BR](#) [02.125.8002.8](#) [60101931](#) [60598-1 \(Cut Strip\)](#) [M1625-3R/100](#) [61062-3](#) [61082-181009](#) [CSU011177004](#) [636-1427](#) [638009-1](#) [641938-9](#) [641991-4](#) [644168-1](#) [644827-2](#) [647662-1](#) [65039-019ELF](#) [65692-001LF](#) [65781-018](#) [65781-047](#)