

REV	LOCATIONS	DESCRIPTION	DATE	REVISER	APPD

Electrical
 Current Rating: 3.0A AC(rms)/DC
 Voltage Rating: 250V AC(rms)/DC
 Contact Resistance: 20 mΩ Max
 Insulation Resistance: 1000 MΩ MIN
 Withstanding Voltage: 1000V AC r.m.s
 Temperature Range—Operating: -25°C~+85°C
 Material and Plating
 Housing: PA66 (UL 94V-2) White
 Contact Pin: Brass
 Plating: Tin Plated

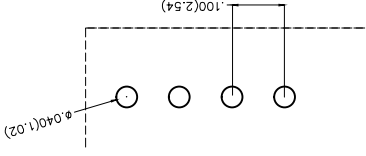
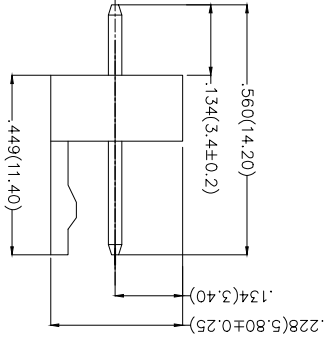
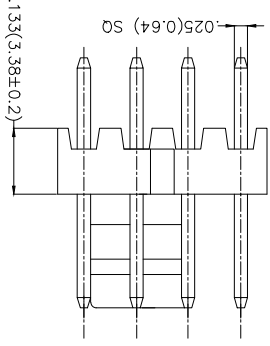
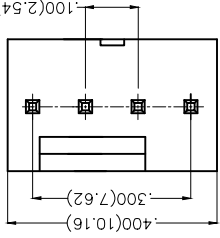

Recommended P.C. Board Layout

THIRD ANGLE PROJECTION	DESIGN UNITS	SCALE
	Inch (metric)	5:1
GENERAL TOLERANCES (UNLESS SPECIFIED)	X ±.012(0.30)	A4
	X ±.008(0.20)	X.XX ±.004(0.10)
	X ±.006(0.15)	X.XX ±.004(0.10)

DATE	APPROVE BY	DATE	DRAWN BY
8/JUL/13	FRANK	8/JUL/13	JACOB
DATE	CHECKED BY	DATE	CHERRY
8/JUL/13	X ±.008(0.20)	8/JUL/13	X ±.006(0.15)
DATE	DATE	8/JUL/13	X ±.004(0.10)

ITEM NO.	PART NO.
FWF25410	FWF25410-S04S22WB
TITLE	Wire to Board (Water)
	Pitch 2.54mm 180° Vertical (DIP)

TXGA
 Leader Of Industry

THIS DRAWING CONTAINS INFORMATION THAT IS PROPRIETARY TO TXGA INDUSTRIAL ELECTRONICS(SZ)CO.,LTD AND SHOULD NOT BE USED WITHOUT WRITTEN PERMISSION
 SHEET NO. 1/1
 REV 0

X-ON Electronics

Largest Supplier of Electrical and Electronic Components

Click to view similar products for [Headers & Wire Housings](#) category:

Click to view products by [TXGA](#) manufacturer:

Other Similar products are found below :

[95000-104TRLF](#) [10135584-644402LF](#) [DF62W-EP2022PCA](#) [95000-106TRLF](#) [DF62W-2022SCA](#) [DF62W-EP2022PC](#) [2203348](#) [DF62W-2022SC](#) [1084018](#) [1029039](#) [1084017](#) [802-10-012-10-002000](#) [1112640](#) [1112639](#) [891-007-9SS-BST1T](#) [000-34000](#) [0008550134](#) [0009482033](#) [0009507031](#) [57102-F02-18ULF](#) [57102-S06-03LF](#) [57202-S52-04LF](#) [PCN6-15S-2.5E](#) [0039019024](#) [58102-G61-06LF](#) [582553-1](#) [0009485154](#) [0009508121](#) [0022285053](#) [0050291907](#) [018731A](#) [LY20-4P-DT1-P1E-BR](#) [02.125.8002.8](#) [60101931](#) [60598-1 \(Cut Strip\)](#) [M1625-3R/100](#) [61062-3](#) [61082-181009](#) [CSU011177004](#) [636-1427](#) [638009-1](#) [641938-9](#) [641991-4](#) [644168-1](#) [644827-2](#) [647662-1](#) [65039-019ELF](#) [65692-001LF](#) [65781-018](#) [65781-047](#)