

Recommended P.C.Board Layout

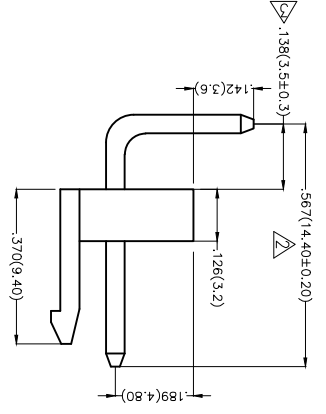
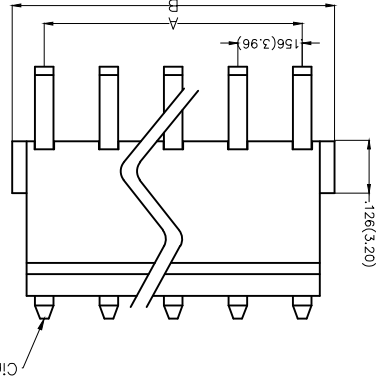
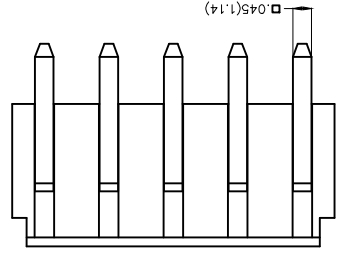
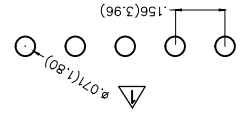

Electrical
 Current Rating: 7A AC(rms)/DC
 Voltage Rating: 250V AC(rms)/DC
 Contact Resistance: 10 mΩ Max
 Insulation Resistance: 1000 MΩ MIN
 Withstanding Voltage: 1500V AC r.m.s
 Temperature Range—Operating: -25°C~+85°C
 Material and Plating
 Housing: PA6T (UL 94V-0)/PA66 (UL 94V-0)
 Contact Pin: Brass
 Plating: Tin Plated

Ordering Information

FWF 396 02 - S XX B 2 X XX B
 1 2 3 4 5 6 7 8 9 10

- 1 Category FWF-Wafer
- 2 Series Number 396-Pitch 3.96mm
- 3 Distinction No. 02
- 4 Row Option S-Single Row
- 5 Circuits XX
- 6 Entry Angle B-90° Angle
- 7 Plating 2-Tin Plated
- 8 Material-Resin 4-PA6T
- 9 Color-Resin W1-White
- 10 Packaging B-PE Bag

THIRD ANGLE PROJECTION	DESIGN UNITS Inch (metric)	SCALE 5:1	A4
GENERAL TOLERANCES (UNLESS SPECIFIED)	DATE 19/SEP/15	APPROVE BY FRANK	DATE 19/SEP/15
DATE 19/SEP/15	ITEM NO. FWF39602	TITLE Wire to Board (Wafer) Pitch 3.96mm 90° Angle (DIP)	REV 3 SHEET NO. 1/2
DATE 19/SEP/15	CHECKED BY CHERRY	DATE 19/SEP/15	THIS DRAWING CONTAINS INFORMATION THAT IS PROPRIETARY TO TXGA INDUSTRIAL ELECTRONICS(Z)CO.,LTD AND SHOULD NOT BE USED WITHOUT WRITTEN PERMISSION
DATE 19/SEP/15	DRAWN BY JACOB	DATE 19/SEP/15	
DATE 19/SEP/15	XXXX±.004(0.10)	XXXX±.05	
DATE 19/SEP/15	XXXX±.006(0.15)	XXXX±.1	
DATE 19/SEP/15	XXXX±.008(0.20)	XXXX±.2	
DATE 19/SEP/15	XXXX±.012(0.30)	XXXX±.5	

REV	LOCATIONS	DESCRIPTION	DATE	REVISER	APPD
1		Dimension: 0.065(1.65) Change to 0.071(1.80)	20150919	CHERRY	FAN
2		Dimension: .587(14.90) Change to .567(14.40)	20171127	VERNON	
3		Add dimension	26/APR/19	KATE	FRANK



X-ON Electronics

Largest Supplier of Electrical and Electronic Components

Click to view similar products for [Headers & Wire Housings](#) category:

Click to view products by [TXGA](#) manufacturer:

Other Similar products are found below :

[95000-104TRLF](#) [10135584-644402LF](#) [DF62W-EP2022PCA](#) [95000-106TRLF](#) [DF62W-2022SCA](#) [DF62W-EP2022PC](#) [2203348](#) [DF62W-2022SC](#) [1084018](#) [1029039](#) [1084017](#) [802-10-012-10-002000](#) [1112640](#) [1112639](#) [891-007-9SS-BST1T](#) [000-34000](#) [0008550134](#) [0009482033](#) [0009507031](#) [57102-F02-18ULF](#) [57102-S06-03LF](#) [57202-S52-04LF](#) [PCN6-15S-2.5E](#) [0039019024](#) [58102-G61-06LF](#) [582553-1](#) [0009485154](#) [0009508121](#) [0022285053](#) [0050291907](#) [018731A](#) [LY20-4P-DT1-P1E-BR](#) [02.125.8002.8](#) [60101931](#) [60598-1 \(Cut Strip\)](#) [M1625-3R/100](#) [61062-3](#) [61082-181009](#) [CSU011177004](#) [636-1427](#) [638009-1](#) [641938-9](#) [641991-4](#) [644168-1](#) [644827-2](#) [647662-1](#) [65039-019ELF](#) [65692-001LF](#) [65781-018](#) [65781-047](#)