

Recommended P.C.Board Layout

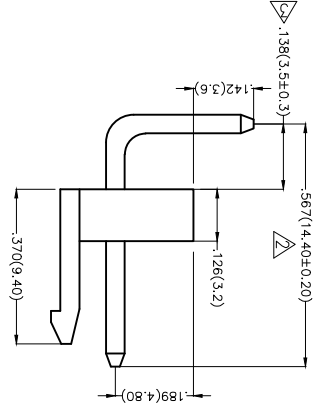
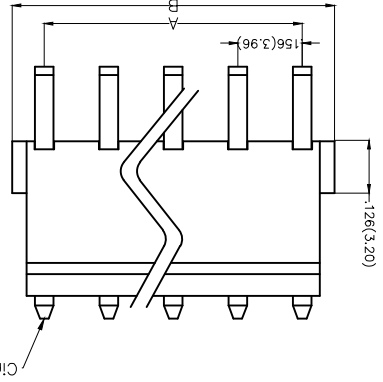
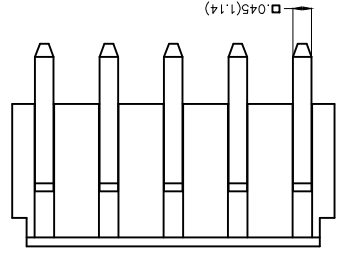
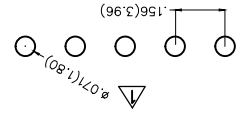

Electrical
 Current Rating: 7A AC(rms)/DC
 Voltage Rating: 250V AC(rms)/DC
 Contact Resistance: 10 mΩ Max
 Insulation Resistance: 1000 MΩ MIN
 Withstanding Voltage: 1500V AC r.m.s
 Temperature Range—Operating: -25°C~+85°C
 Material and Plating
 Housing: PA6T (UL 94V-0)/PA66 (UL 94V-0)
 Contact Pin: Brass
 Plating: Tin Plated

Ordering Information

FWF 396 02 - S XX B 2 X XX B

1	Category	FWF-Wafer
2	Series Number	396-Pitch 3.96mm
3	Distinction No.	02
4	Row Option	S-Single Row
5	Circuits	XX
6	Entry Angle	B-90° Angle
7	Plating	2-Tin Plated
8	Material-Resin	4-PA6T 2-PA66
9	Color-Resin	W1-White W5-White
10	Packaging	B-PE Bag

THIRD ANGLE PROJECTION	DESIGN UNITS	X.X±.012(0.30)	X.±.5	FRANK	DATE	19/SEP/15	PART NO.	FWF39602-SXXB2XXXB	ITEM NO.	FWF39602
	SCALE	5:1	A4	DATE	19/SEP/15	CHERRY	TITLE	Wire to Board (Wafer)	REV 3	SHEET NO. 1/2
GENERAL TOLERANCES (UNLESS SPECIFIED)	APPROVE BY	FRANK	DATE	19/SEP/15	CHECKED BY	CHERRY	DATE	19/SEP/15	DRAWN BY	JACOB

REV	LOCATIONS	DESCRIPTION	DATE	REVISER	APPD
1		Dimension: 0.055(1.65) Change to 0.071(1.80)	20150919	CHERRY	FAN
2		Dimension: .587(14.90) Change to .567(14.40)	20171127	VERNON	
3		Add dimension	26/APR/19	KATE	FRANK

THIS DRAWING CONTAINS INFORMATION THAT IS PROPRIETARY TO TXGA INDUSTRIAL ELECTRONICS(Z)CO.,LTD AND SHOULD NOT BE USED WITHOUT WRITTEN PERMISSION



X-ON Electronics

Largest Supplier of Electrical and Electronic Components

Click to view similar products for [Headers & Wire Housings](#) category:

Click to view products by [TXGA](#) manufacturer:

Other Similar products are found below :

[95000-104TRLF](#) [10135584-644402LF](#) [DF62W-EP2022PCA](#) [95000-106TRLF](#) [DF62W-2022SCA](#) [DF62W-EP2022PC](#) [2203348](#) [DF62W-2022SC](#) [1084018](#) [1029039](#) [1084017](#) [802-10-012-10-002000](#) [1112640](#) [1112639](#) [891-007-9SS-BST1T](#) [000-34000](#) [0008550134](#) [0009482033](#) [0009507031](#) [57102-F02-18ULF](#) [57102-S06-03LF](#) [57202-S52-04LF](#) [PCN6-15S-2.5E](#) [0039019024](#) [58102-G61-06LF](#) [582553-1](#) [0009485154](#) [0009508121](#) [0022285053](#) [0050291907](#) [018731A](#) [LY20-4P-DT1-P1E-BR](#) [02.125.8002.8](#) [60101931](#) [60598-1 \(Cut Strip\)](#) [M1625-3R/100](#) [61062-3](#) [61082-181009](#) [CSU011177004](#) [636-1427](#) [638009-1](#) [641938-9](#) [641991-4](#) [644168-1](#) [644827-2](#) [647662-1](#) [65039-019ELF](#) [65692-001LF](#) [65781-018](#) [65781-047](#)