

Recommended P.C.Board Layout

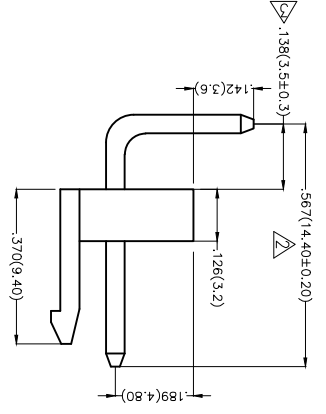
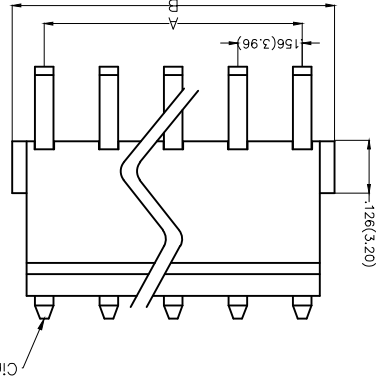
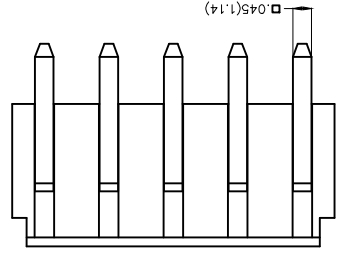
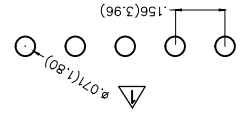

Electrical
 Current Rating: 7A AC(rms)/DC
 Voltage Rating: 250V AC(rms)/DC
 Contact Resistance: 10 mΩ Max
 Insulation Resistance: 1000 MΩ MIN
 Withstanding Voltage: 1500V AC r.m.s
 Temperature Range—Operating: -25°C~+85°C
 Material and Plating
 Housing: PA6T (UL 94V-0)/PA66 (UL 94V-0)
 Contact Pin: Brass
 Plating: Tin Plated

Ordering Information

FWF 396 02 - S XX B 2 X XX B

- 1 Category FWF-Wafer
- 2 Series Number 396-Pitch 3.96mm
- 3 Distinction No. 02
- 4 Row Option S-Single Row
- 5 Circuits XX
- 6 Entry Angle B-90° Angle
- 7 Plating 2-Tin Plated
- 8 Material-Resin 4-PA6T
- 9 Color-Resin W1-White
- 10 Packaging B-PE Bag

THIRD ANGLE PROJECTION		GENERAL TOLERANCES (UNLESS SPECIFIED)		APPROVE BY	DATE	PART NO.	ITEM NO.
X ±.012(0.30)		X ±.008(0.20)		FRANK	19/SEP/15	FWF39602-SXXB2XXXB	FWF39602
X ±.006(0.15)		X ±.004(0.10)		CHECKED BY	DATE	TITLE	
X ±.01		X ±.004(0.10)		CHERRY	19/SEP/15	Wire to Board (Water)	
X ±.004(0.10)		X ±.002(0.05)		DRAWN BY	DATE	Pitch 3.96mm 90° Angle (DIP)	
A4		A4		JACOB	19/SEP/15	REV 3	
SCALE 5:1		SCALE 5:1				SHEET NO. 1/2	

THIS DRAWING CONTAINS INFORMATION THAT IS PROPRIETARY TO TXGA INDUSTRIAL ELECTRONICS(Z)CO.,LTD AND SHOULD NOT BE USED WITHOUT WRITTEN PERMISSION



REV	LOCATIONS	DESCRIPTION	DATE	REVISER	APPD
1		Dimension: 0.055(1.65) Change to 0.071(1.80)	20150919	CHERRY	FAN
2		Dimension: .587(14.90) Change to .567(14.40)	20171127	VERNON	
3		Add dimension	26/APR/19	KATE	FRANK

REV	LOCATIONS	DESCRIPTION	DATE	REVISER	APPD

Material and Plating : Housing PA66 UL94V-0 , Tin Plated.		Dimensions(in/mm)		Part No.	
Circuits	(n)	A		B	
		in	mm	in	mm
2	2	.156(3.96)	.311(7.92)	FWF39602-S02B22W1B	FWF39602-S02B24W5B
3	3	.468(11.88)	.311(7.92)	FWF39602-S03B22W1B	FWF39602-S03B24W5B
4	4	.468(11.88)	.624(15.84)	FWF39602-S04B22W1B	FWF39602-S04B24W5B
5	5	.780(19.80)	.624(15.84)	FWF39602-S05B22W1B	FWF39602-S05B24W5B
6	6	.780(19.80)	.935(23.76)	FWF39602-S06B22W1B	FWF39602-S06B24W5B
7	7	1.091(27.72)	.935(23.76)	FWF39602-S07B22W1B	FWF39602-S07B24W5B
8	8	1.247(31.68)	1.091(27.72)	FWF39602-S08B22W1B	FWF39602-S08B24W5B
9	9	1.403(35.64)	1.247(31.68)	FWF39602-S09B22W1B	FWF39602-S09B24W5B
10	10	1.559(39.60)	1.403(35.64)	FWF39602-S10B22W1B	FWF39602-S10B24W5B
11	11	1.559(39.60)	1.715(43.56)	FWF39602-S11B22W1B	FWF39602-S11B24W5B
12	12	1.715(43.56)	1.871(47.52)	FWF39602-S12B22W1B	FWF39602-S12B24W5B

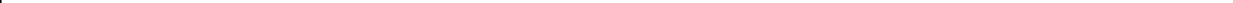

 THIRD ANGLE PROJECTION	X ±.012(0.30) X.XX±.006(0.15)	X ±.5	CHECKED BY FRANK	DATE 19/SEP/15	PART NO. FWF39602-SXXB2XXXB	ITEM NO. FWF39602	
	X.XX±.008(0.20) X.XX±.004(0.10)	X ±.2	CHERRY	DATE 19/SEP/15	TITLE Wire to Board (Water) Pitch 3.96mm 90° Angle (DIP)		
	X.XX±.006(0.15) X.XX±.004(0.10)	X ±.1	JACOB	DATE 19/SEP/15	THIS DRAWING CONTAINS INFORMATION THAT IS PROPRIETARY TO TXGA INDUSTRIAL ELECTRONICS(SZ)CO.,LTD AND SHOULD NOT BE USED WITHOUT WRITTEN PERMISSION		
SCALE 5:1 A4	DESIGN UNITS Inch (metric)	SIZE A4	GENERAL TOLERANCES (UNLESS SPECIFIED)				
				DRAWN BY JACOB		SHEET NO. 2/2	
				APPROVE BY FRANK		REV 3	
				DATE 19/SEP/15		Leader Of Industry TXGA	

A B C D E F

X-ON Electronics

Largest Supplier of Electrical and Electronic Components

Click to view similar products for [Headers & Wire Housings](#) category:

Click to view products by [TXGA](#) manufacturer:

Other Similar products are found below :

[95000-104TRLF](#) [10135584-644402LF](#) [DF62W-EP2022PCA](#) [95000-106TRLF](#) [DF62W-2022SCA](#) [DF62W-EP2022PC](#) [2203348](#) [DF62W-2022SC](#) [1084018](#) [1029039](#) [1084017](#) [802-10-012-10-002000](#) [1112640](#) [1112639](#) [891-007-9SS-BST1T](#) [000-34000](#) [0008550134](#) [0009482033](#) [0009507031](#) [57102-F02-18ULF](#) [57102-S06-03LF](#) [57202-S52-04LF](#) [PCN6-15S-2.5E](#) [0039019024](#) [58102-G61-06LF](#) [582553-1](#) [0009485154](#) [0009508121](#) [0022285053](#) [0050291907](#) [018731A](#) [LY20-4P-DT1-P1E-BR](#) [02.125.8002.8](#) [60101931](#) [60598-1 \(Cut Strip\)](#) [M1625-3R/100](#) [61062-3](#) [61082-181009](#) [CSU011177004](#) [636-1427](#) [638009-1](#) [641938-9](#) [641991-4](#) [644168-1](#) [644827-2](#) [647662-1](#) [65039-019ELF](#) [65692-001LF](#) [65781-018](#) [65781-047](#)