

PBT

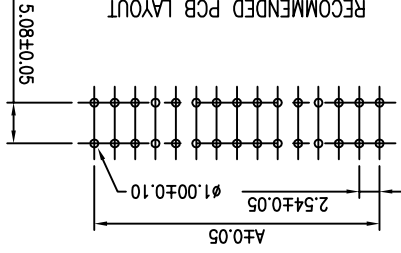

MATERIAL  
HOUSING: HIGH TEMPERATURE THERMOPLASTIC, UL94V-0  
COLOR: BLACK  
CONTACT: COPPER ALLOY  
FINISH: SELECTIVE GOLD PLATING ON CONTACT AREA  
100" MIN. TIN PLATING ON SOLDERTAILS  
50" MIN. NICKEL UNDERPLATED OVERALL

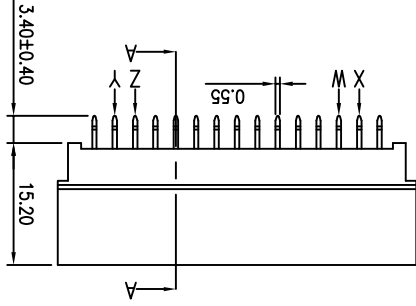
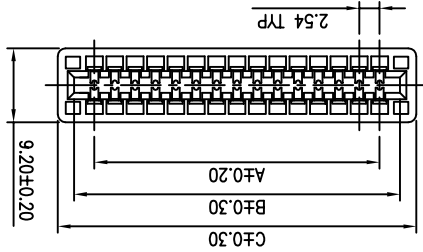
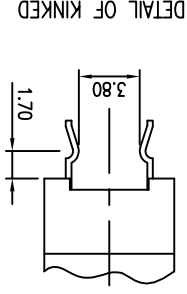
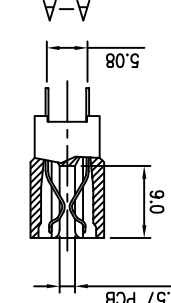

ACCEPTED 1.57 PCB

PART NO. SERIES NO. SA XX X L XX SA  
TAIL TYPE  
D: NO KINK  
02: 2 PAIR KINKS  
04: 4 PAIR KINKS  
CONTACT AREA PLATING  
01: 1" GOLD  
0: 1" GOLD  
L: LEAD FREE, BRIGHT

NO OF POS	DIM A	DIM B	DIM C	KINKED	NO OF POS	DIM A	DIM B	DIM C	KINKED
2X3=6	5.08	10.16	14.22	---	2X26=52	63.50	68.58	72.64	XY
2X4=8	7.62	12.70	16.76	---	2X27=54	66.04	71.12	75.18	XY
2X5=10	10.16	15.24	19.30	---	2X28=56	68.58	73.66	77.72	XY
2X6=12	12.70	17.78	21.84	---	2X29=58	71.12	76.20	80.26	XY
2X7=14	15.24	20.32	24.38	---	2X30=60	73.66	78.74	82.80	XY
2X8=16	17.78	22.86	26.92	---	2X31=62	76.20	81.28	85.34	WZ
2X9=18	20.32	25.40	29.46	XY	2X32=64	78.74	83.82	87.88	WXYZ
2X10=20	22.86	27.94	32.00	XY	2X33=66	81.28	86.36	90.42	WXYZ
2X11=22	25.40	30.48	34.54	XY	2X34=68	83.82	88.90	92.96	WXYZ
2X12=24	27.94	33.02	37.08	XY	2X35=70	86.36	91.44	95.50	WXYZ
2X13=26	30.48	35.56	39.62	WXYZ	2X36=72	88.90	93.98	98.04	WXYZ
2X14=28	33.02	38.10	42.16	XY	2X37=74	91.44	96.52	100.58	WXYZ
2X15=30	35.56	40.64	44.70	XY	2X38=76	93.98	99.06	103.12	WXYZ
2X16=32	38.10	43.18	47.24	XY	2X39=78	96.52	101.60	105.66	WXYZ
2X17=34	40.64	45.72	49.78	XY	2X40=80	99.06	104.14	108.20	WXYZ
2X18=36	43.18	48.26	52.32	WXYZ	2X41=82	101.60	106.68	110.74	WXYZ
2X19=38	45.72	50.80	54.86	XY	2X42=84	104.14	109.22	113.28	WXYZ
2X20=40	48.26	53.34	57.40	XY	2X43=86	106.68	111.76	115.82	WXYZ
2X21=42	50.80	55.88	59.94	XY	2X44=88	109.22	114.30	118.36	WXYZ
2X22=44	53.34	58.42	62.48	XY	2X45=90	111.76	116.84	120.90	WXYZ
2X23=46	55.88	60.96	65.02	XY	2X46=92	114.30	119.38	123.44	WXYZ
2X24=48	58.42	63.50	67.56	XY	2X47=94	116.84	121.92	125.98	WXYZ
2X25=50	60.96	66.04	70.10	XY	2X48=96	119.38	124.46	128.52	WXYZ

**Umax** 东莞市友贸实业有限公司  
DONGGUAN UMAXCONN ENTERPRISE LIMITED

TITLE:

CARDEDGE SLOT, 2.54mm PITCH

TOLERANCE	
LINEAR	X.±
ANGLES	X.±

APPD:	Jason	MAT'L:	DWG NO.	SA00007001
CHKD:	Schumi	FINISH:	UNITS	MM
DRWN:	Miji	Q'TY:	SCALE	1:1
REV		SHEET		REV

DATE	NAME	ECON NO.	REV	ECN NO.
.XXX±0.10	.XXX±	.XX±	.XX±	.XX±0.20
.XX±	.X±	.X±	.X±	.X±0.30
.X±	.X±	.X±	.X±	.X±0.40

1	2	3	4	5	6	7	8
CUSTOMER							

## X-ON Electronics

Largest Supplier of Electrical and Electronic Components

*Click to view similar products for [Headers & Wire Housings](#) category:*

*Click to view products by [UMAX](#) manufacturer:*

Other Similar products are found below :

[95000-104TRLF](#) [10135584-644402LF](#) [DF62W-EP2022PCA](#) [95000-106TRLF](#) [DF62W-2022SCA](#) [DF62W-EP2022PC](#) [2203348](#) [DF62W-2022SC](#) [1084018](#) [1029039](#) [1084017](#) [802-10-012-10-002000](#) [1112640](#) [1112639](#) [891-007-9SS-BST1T](#) [000-34000](#) [0008550134](#) [0009482033](#) [0009507031](#) [57102-F02-18ULF](#) [57102-S06-03LF](#) [57202-S52-04LF](#) [PCN6-15S-2.5E](#) [0039019024](#) [58102-G61-06LF](#) [582553-1](#) [0009485154](#) [0009508121](#) [0022285053](#) [0050291907](#) [018731A](#) [LY20-4P-DT1-P1E-BR](#) [02.125.8002.8](#) [60101931](#) [60598-1 \(Cut Strip\)](#) [M1625-3R/100](#) [61062-3](#) [61082-181009](#) [CSU011177004](#) [636-1427](#) [638009-1](#) [641938-9](#) [641991-4](#) [644168-1](#) [644827-2](#) [647662-1](#) [65039-019ELF](#) [65692-001LF](#) [65781-018](#) [65781-047](#)