

Waterpump pliers

447/1HPP



Profiles



Product features



- material: premium chrome vanadium steel
- drop forged, entirely hardened and tempered
- working surfaces induction hardened
- surface finish: chrome plated according to ISO 1456:2009
- heavy duty double - component handles

Advantages:

- Toothed jaw is designed to ensure optimum grip of an object.
- Jaw aperture adjustable in 10 positions.
- The HPP pliers have a button for fast regulation of the jaw's gap which enables fast and precise adaptation of the jaw to the wanted grip of the work piece.
- Extreme grip strength: The design and shape of the pliers' jaws enable, despite the slim construction, better grip strength of the work piece, which results in stability, work safety, and greater effectiveness.
- Finish: pliers are drop forged from high quality tool steels and heat treated
- Work: due to the slim construction, the jaws enable one-handed work in difficult-to-reach places
- Made of double-component material which reduces slipping of the hand during work and so enable safe and effective transmission of power from the hand to the pliers' jaws

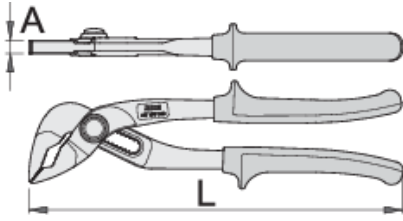
- Ergonomics: handles are designed to fully adjust to the user`s hand and so enable greater handling and work safety



	L	A	Omax	
620172	240	8.5	40	392

* Images of products are symbolic. All dimensions are in mm, and weight in grams. All listed dimensions may vary in tolerance.

Usage (pictures)

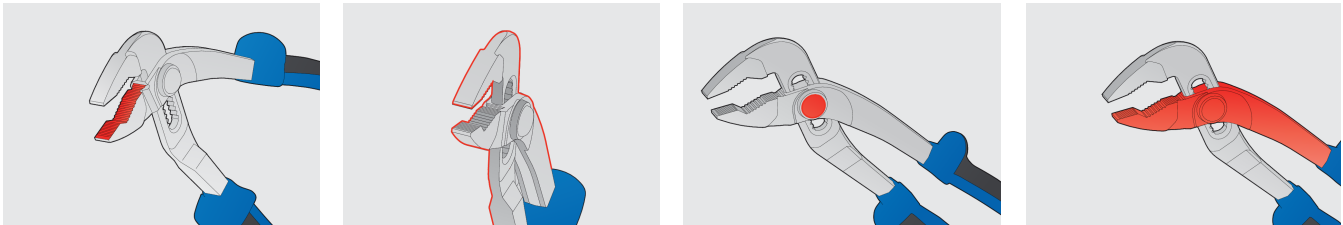

X-ON Electronics

Largest Supplier of Electrical and Electronic Components

Click to view similar products for [Pliers & Tweezers](#) category:

Click to view products by [UNIOR](#) manufacturer:

Other Similar products are found below :

[0026](#) [T0058765801](#) [80](#) [76C](#) [378MN](#) [L4VN](#) [LN54VN](#) [NN7776VN](#) [54CGVN](#) [SN55VN](#) [DRP10N](#) [0036](#) [PN 5050/21D](#) [505BGC](#) [622TX](#)
[43450](#) [8150 CO](#) [8165 CO](#) [32BSA25](#) [5BSAF](#) [017610101](#) [PN 5025](#) [65516300](#) [YT-2469](#) [011640100](#) [010480315](#) [503 618 3](#) [PGT435](#) [T3653](#)
[250](#) [5000522](#) [011770113](#) [011770101](#) [CPE.A4](#) [T3781](#) [189A.17VE](#) [PPR 5003 D](#) [131 010 2](#) [40603GP](#) [011780102](#) [45705](#) [CPES](#) [6151](#)
[181A.18CPE](#) [391A.16VE](#) [181EF.25CPEPB](#) [011640096](#) [CPE.A1PB](#) [SS406-160](#) [192A.18VE](#) [8000 0001 0 0](#)