

# KRE Series

- 5mm height
- Endurance : 1,000 hours at 105°C
- Solvent resistant type (see PRECAUTIONS AND GUIDELINES)
- RoHS Compliant

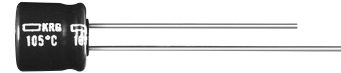

## ◆ SPECIFICATIONS

Items	Characteristics						
Category Temperature Range	-55 to +105°C						
Rated Voltage Range	6.3 to 50V <sub>dc</sub>						
Capacitance Tolerance	±20% (M) (at 20°C, 120Hz)						
Leakage Current	I=0.01CV or 3μA, whichever is greater. Where, I : Max. leakage current (μA), C : Nominal capacitance (μF), V : Rated voltage (V) (at 20°C after 2 minutes)						
Dissipation Factor (tanδ)	Rated voltage (V <sub>dc</sub> )	6.3V	10V	16V	25V	35V	50V
	tanδ (Max.)	0.27	0.23	0.19	0.15	0.13	0.11
Low Temperature Characteristics (Max. Impedance Ratio)	Rated voltage (V <sub>dc</sub> )	6.3V	10V	16V	25V	35V	50V
	Z(-25°C)/Z(+20°C)	3	3	2	2	2	2
	Z(-40°C)/Z(+20°C)	9	7	5	3	3	3
Endurance	The following specifications shall be satisfied when the capacitors are restored to 20°C after the rated voltage is applied for 1,000 hours at 105°C.						
	Capacitance change	≤±20% of the initial value					
	D.F. (tanδ)	≤200% of the initial specified value					
	Leakage current	≤The initial specified value					
Shelf Life	The following specifications shall be satisfied when the capacitors are restored to 20°C after exposing them for 500 hours at 105°C without voltage applied. Before the measurement, the capacitor shall be preconditioned by applying voltage according to Item 4.1 of JIS C 5101-4.						
	Capacitance change	≤±20% of the initial value					
	D.F. (tanδ)	≤200% of the initial specified value					
	Leakage current	≤The initial specified value					

## ◆ DIMENSIONS [mm]

- Terminal Code : E

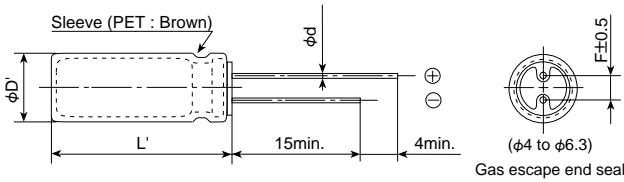

φD	4	5	6.3
φd	0.45	0.45	0.45
F	1.5	2.0	2.5
φD'	φD+0.5max.		
L'	L+1.0max.		

## ◆ PART NUMBERING SYSTEM

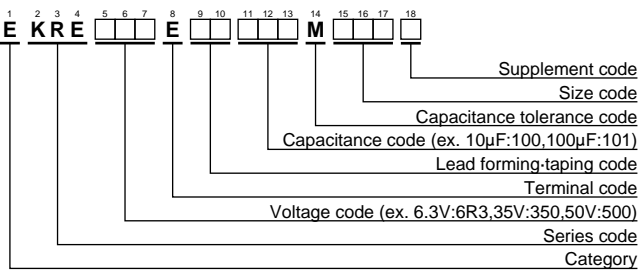

Please refer to "Product code guide (radial lead type)"

## ◆ STANDARD RATINGS

WV (V <sub>dc</sub> )	Cap (μF)	Case size φDXL(mm)	tanδ	Rated ripple current (mArms/105°C, 120Hz)	Part No.
6.3	10	4×5	0.27	12	EKRE6R3E□□100MD05D
	22	4×5	0.27	21	EKRE6R3E□□220MD05D
	47	5×5	0.27	36	EKRE6R3E□□470ME05D
	100	6.3×5	0.27	56	EKRE6R3E□□101MF05D
10	33	5×5	0.23	34	EKRE100E□□330ME05D
16	4.7	4×5	0.19	9.4	EKRE160E□□4R7MD05D
	10	4×5	0.19	16	EKRE160E□□100MD05D
	22	5×5	0.19	30	EKRE160E□□220ME05D
	47	6.3×5	0.19	48	EKRE160E□□470MF05D
25	3.3	4×5	0.15	8.8	EKRE250E□□3R3MD05D
	4.7	4×5	0.15	12	EKRE250E□□4R7MD05D
	33	6.3×5	0.15	45	EKRE250E□□330MF05D

WV (V <sub>dc</sub> )	Cap (μF)	Case size φDXL(mm)	tanδ	Rated ripple current (mArms/105°C, 120Hz)	Part No.
35	2.2	4×5	0.13	7.7	EKRE350E□□2R2MD05D
	3.3	4×5	0.13	11	EKRE350E□□3R3MD05D
	4.7	4×5	0.13	15	EKRE350E□□4R7MD05D
	10	5×5	0.13	25	EKRE350E□□100ME05D
	22	6.3×5	0.13	40	EKRE350E□□220MF05D
50	1.0	4×5	0.11	5.6	EKRE500E□□1R0MD05D
	2.2	4×5	0.11	10	EKRE500E□□2R2MD05D
	3.3	4×5	0.11	14	EKRE500E□□3R3MD05D
	4.7	5×5	0.11	19	EKRE500E□□4R7ME05D
	10	6.3×5	0.11	29	EKRE500E□□100MF05D

□□ : Enter the appropriate lead forming or taping code.  
Note : □ unified to φ4×5.

## X-ON Electronics

Largest Supplier of Electrical and Electronic Components

*Click to view similar products for* [Aluminium Electrolytic Capacitors - Radial Leaded](#) *category:*

*Click to view products by* [United Chemicon](#) *manufacturer:*

Other Similar products are found below :

[LXY50VB4.7M-5X11](#) [B41041A2687M8](#) [B41041A7226M8](#) [B41044A7157M6](#) [EPA-201ELL151MM25S](#) [NCD681K10KVY5PF](#) [KM4700/16](#)  
[KME50VB100M-8X11.5](#) [SG220M1CSA-0407](#) [ES5107M016AE1DA](#) [ESRL25V330](#) [ESX472M16B](#) [SZ010M1500A5S-1015](#) [227RZS050M](#)  
[476CKH100MSA](#) [477CKR100M](#) [KME25VB100M-6.3X11](#) [XRL50V22](#) [052687X](#) [107CKR010M](#) [EKMA500ELL4R7ME07D](#) [NRE-](#)  
[S560M16V6.3X7TBSTF](#) [RGA221M1CTA-0611G](#) [ERZA630VHN182UP54N](#) [UPL1A331MPH](#) [MAL214658821E3](#)  
[SK106M016AC3KAKPLP](#) [SK107M025AE3EAKPLP](#) [B43827A1106M8](#) [B41022A5686M6](#) [EKMA160EC3101MF07D](#)  
[ESMG160ETD221MF11D](#) [EKZH160ETD152MJ20S](#) [EKMA350ELL100ME07D](#) [ESMG160ETD101ME11D](#) [EGXF500ELL561ML15S](#)  
[SK107M025AE3KAKPLP](#) [EKMG350ETD471MJ16S](#) [MEA562M2W--D130](#) [35YXA330MEFC10X12.5](#) [RGA221M2ABK-1320G](#)  
[ERR1HM1R0D11OT](#) [ERR1CM222W20OT](#) [TM1081EMF202RB](#) [RXQ271M2EBK-1836](#) [RXW103M1CBK-1840](#) [B41896C5278M](#)  
[B41851A8107M000](#) [EKMA160ETD470MF07D](#) [UHW1J102MHD6](#)