

PROPRIETARY AND CONFIDENTIAL
 THE INFORMATION CONTAINED IN THIS DRAWING IS THE SOLE PROPERTY OF VECTOR
 ELECTRONICS & TECH., INC. ANY REPRODUCTION IN PART OR AS A WHOLE WITHOUT
 THE WRITTEN PERMISSION OF VECTOR ELECTRONICS & TECH., INC. IS PROHIBITED.

REVISIONS				
ZONE	REV	DESCRIPTION	DATE	APPROVED
ALL	A	REDRAWN	05/04/12	
	B	ADDED FP52A5HP, FP10A5HP, AND FP15A5HP	02/23/15	
	C	PART NO TABULATION MOUNTING HOLE DIMENSIONS ARE SEPARATED USING "LMHE" AND "RMHE"	07/19/16	
	D	ADDED FP68A4HP	08/28/17	
	E	ADDED FP52A4HP-SS, FP52A5HP-SS	09/10/19	
	F	ADDED "-SS" TO ALL PART NOS	02/05/20	

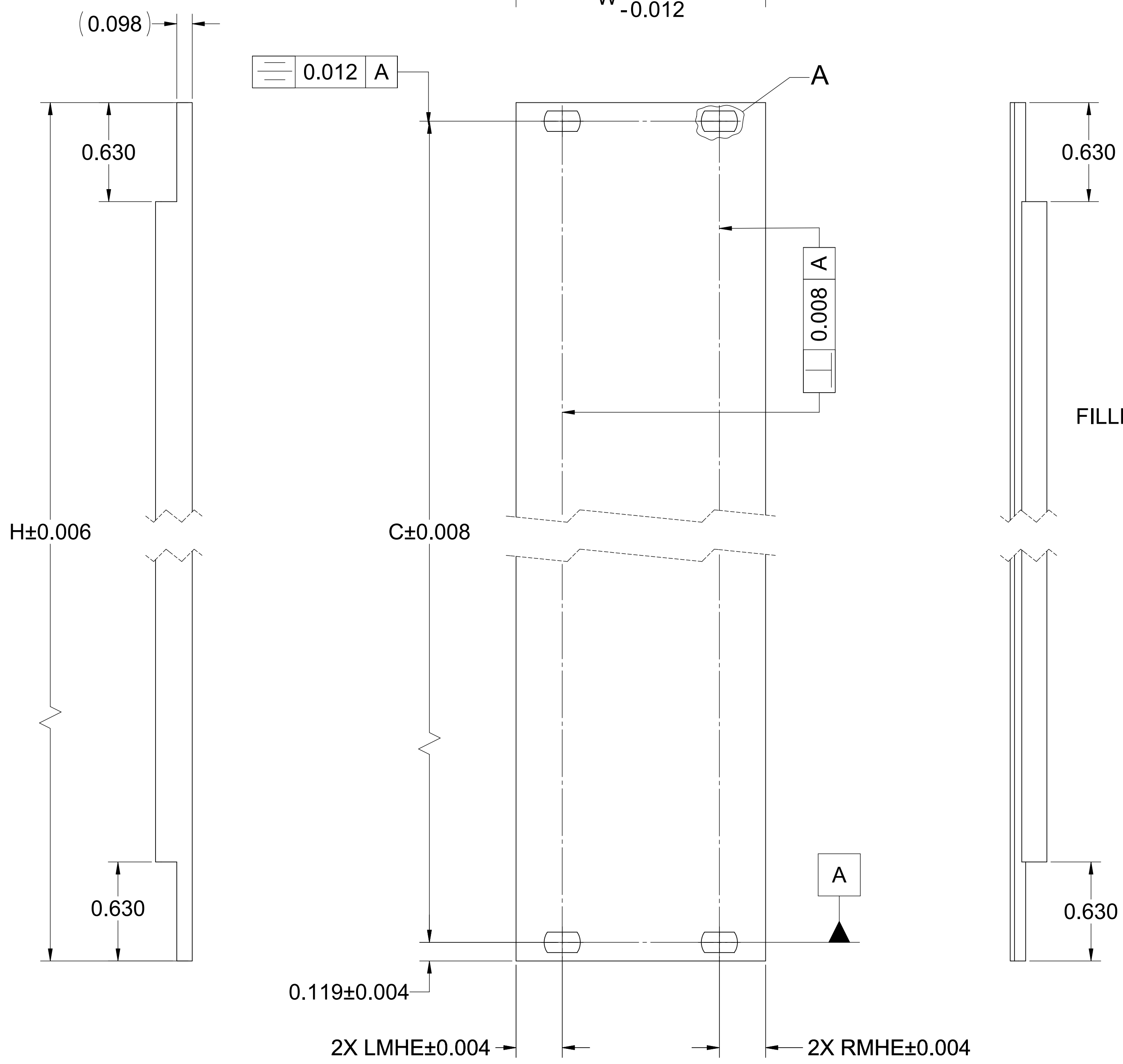
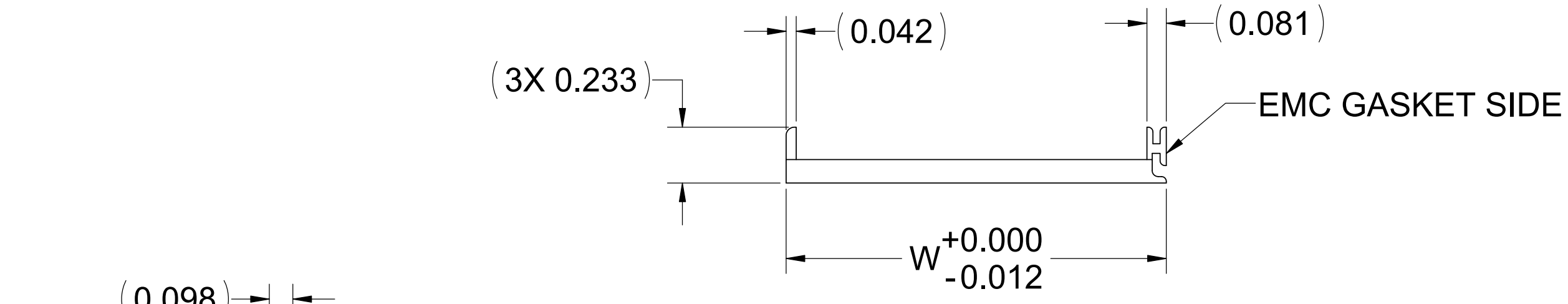
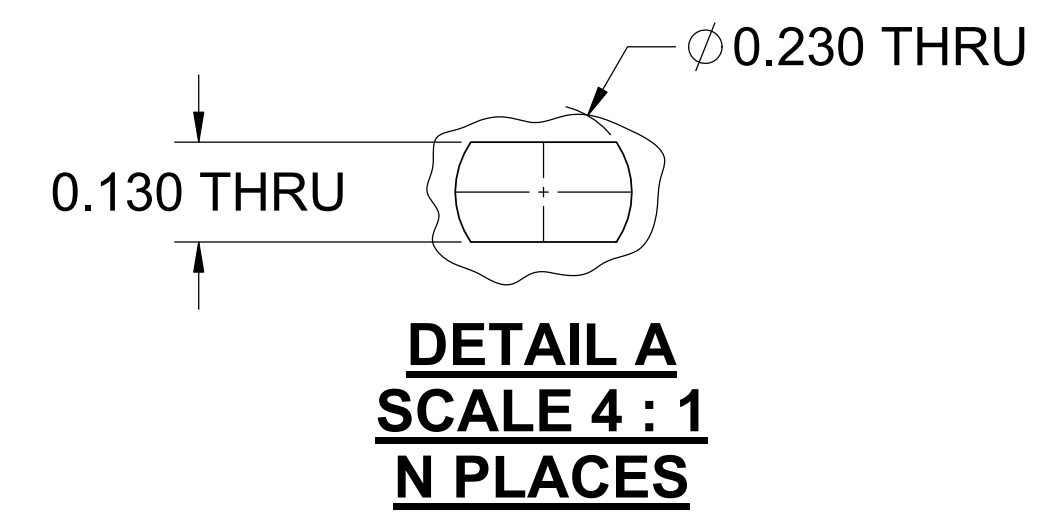

RETAINER SLEEVE, POLYMAIDE, BLACK, P/N 94300008
 (FOR PART NUMBERS WITH "-SS"
 INSTALL 94300005, METAL, SS, PRESS FIT, SLEEVE IN PLACE OF 94300008)
 M2.5 X 0.45 X 11mm CAPTIVE SCREW, STEEL, P/N 95000002B
 (N PLACES)

EMC GASKET, BeCu WITH BRIGHT NICKEL, P/N 93400015B

PART NO	DESCRIPTION	HEIGHT "H"	WIDTH "W"	CENTER "C"	LEFT MOUNTING HOLE "LMHE"	RIGHT MOUNTING HOLE "RMHE"	PLACES "N"
FP52A4HP	3U X 4HP	5.060	0.788	4.823	0.294	-	2
FP52A5HP	3U X 5HP, VPX	5.060	0.988	4.823	0.445	-	2
1406-1015-18	3U X 5HP	5.060	0.988	4.823	0.494	-	2
FP52A8HP	3U X 8HP	5.060	1.588	4.823	0.294	0.294	4
FP52A12HP	3U X 12HP	5.060	2.388	4.823	0.294	0.294	4
FP68A4HP	4U X 4HP	6.810	0.788	6.573	0.294	-	2
FP10A4HP	6U X 4HP	10.310	0.788	10.073	0.294	-	2
FP10A5HP	6U X 5HP, VPX	10.310	0.988	10.073	0.445	-	2
1406-1016-29	6U X 5HP	10.310	0.988	10.073	0.494	-	2
FP10A8HP	6U X 8HP	10.310	1.588	10.073	0.294	0.294	4
FP10A12HP	6U X 12HP	10.310	2.388	10.073	0.294	0.294	4
FP15A4HP	9U X 4HP	15.560	0.788	15.323	0.294	-	2
FP15A5HP	9U X 5HP, VPX	15.560	0.988	15.323	0.445	-	2
FP15A8HP	9U X 8HP	15.560	1.588	15.323	0.294	0.294	4
FP15A12HP	9U X 12HP	15.560	2.388	15.323	0.294	0.294	4

SHOWN FILLER PANEL ASSEMBLY ADD SUFFIX "-SS" TO PART NO FOR FILLER PANELS WITH METAL PRESS-FIT SLEEVES, INSTEAD OF PLASTIC SLEEVES. FOR EXAMPLE FP52A4HP-SS.

"-SS" SUFFIX PART NUMBERS WITH PRESS-FIT METAL SLEEVES.
 WITHOUT "-SS" SUFFIX PART NUMBERS WITH PLASTIC SLEEVES.

- 5. FURNISHED UNASSEMBLED
- 4. FINISH : CLEAR CHEM FILM, IAW MIL-DTL-5541, CLASS 3, TYPE II
- 3. LIGHT GRAIN FRONT SURFACE IN DIRECTION OF MATERIAL GRAIN (AS SHOWN) USING 180 GRIT
- 2. MATERIAL : ALUMINUM EXTRUSION, 6063-T5
 MAKE FROM P/N # M4211-XX
- 1. REMOVE ALL BURRS, SHARP EDGES & SURFACE SCRATCHES

NOTES : UNLESS OTHERWISE SPECIFIED

UNLESS OTHERWISE SPECIFIED	
DIMENSIONS ARE IN INCHES	
TOLERANCES:	
DEC X.X	±0.1
DEC X.XX	±0.03
DEC X.XXX	±0.010
FRACTIONS	±0.050
ANGLES	±1°
GD & T	ASME Y14.5-2009
MATERIAL	2
FINISH	4

APPROVALS	NAME	DATE
DRAWN	TRUSHAR	05/04/12
CHECKED		
ENGINEER		
QA		
THIRD ANGLE PROJECTION		

VECTOR ELECTRONICS & TECHNOLOGY, INC. 11115 VANOWEN ST., NORTH HOLLYWOOD, CA 91605 www.vectorelect.com

3U, 6U, 9U EMC FILLER PANEL

SIZE D DWG. NO. FPXXAXHP REV F

SCALE: 2:1 CAGE CODE: 82893 SHEET 1 OF 1

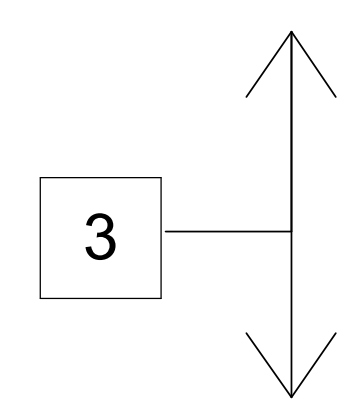

5

X-ON Electronics

Largest Supplier of Electrical and Electronic Components

Click to view similar products for [Screws & Fasteners](#) category:

Click to view products by [Vector](#) manufacturer:

Other Similar products are found below :

[5721-1440-1/4-SS](#) [593503FX](#) [0098.0094](#) [0098.9206](#) [0098.9219](#) [0098.9262](#) [596-2114-013](#) [59781-6](#) [0098.0026](#) [0098.9210](#) [0098.9212](#) [60227-01](#) [60227-04](#) [60227-08](#) [60687-01](#) [LOCK WASHER Black](#) [618-00001](#) [62153-03](#) [62153-11](#) [M316-KSSTMCZ100](#) [M3440-SS](#) [M3442-SS](#) [M3448-SS](#) [6292-1](#) [6-306105-9](#) [6-306131-4](#) [690432-1](#) [699161-000](#) [7230-3](#) [7244](#) [7248-1](#) [7248-2](#) [73542-02](#) [CAPTIVE SHORT THUMBSCREW](#) [745564-1](#) [F1209](#) [751-00001](#) [7680](#) [809704-1](#) [8700](#) [8860220](#) [9047](#) [9521](#) [992326-6](#) [992763-3](#) [1-18024-0](#) [1-18028-2](#) [A168P1](#) [A495P1](#) [1-24921-1](#) [125416-1](#) [1260](#)