

产品图片	Features 产品特性	Application 应用
 <p>SOP4</p>	<ul style="list-style-type: none"> ●Contact Form 触点形式 1b ●Load Voltage 输出电压 400V ●Load Current 输出电流 0.12A ●Low Off-State Leakage Current 漏电流 10μA 	<ul style="list-style-type: none"> ●Automatic Test Equipment 自动检测设备 ●Telephone Equipment 通信设备 ●Sensing Equipment 传感设备 ●Security Equipment 安全设备 ●I/O Modules I/O 模块 ●Modem 调制解调器

Type 种类

Output rating 输出额定		Marking model 标 刻型号	Part No. 订货型号
Load voltage 负载电压	Load current 负 载电流		
400V	0.12A	BCY414S	BCY414S

Dimensions 外形尺寸

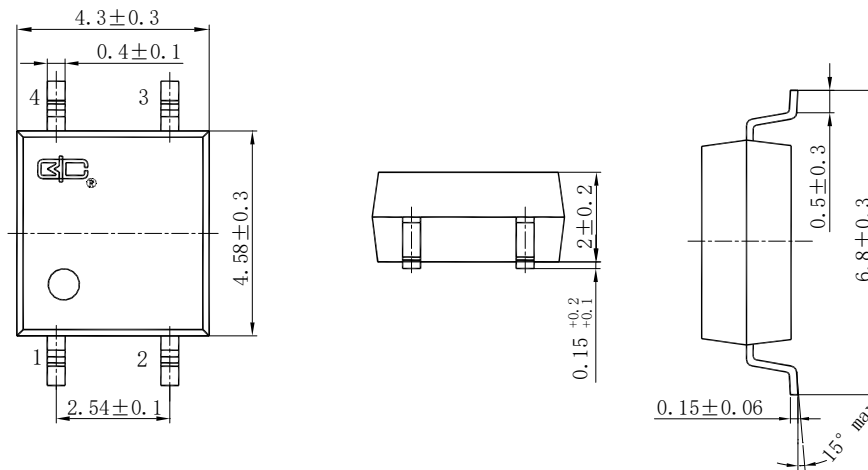

Terminal Identification 引脚标识

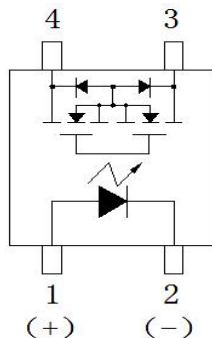

Wiring Diagram 接线图

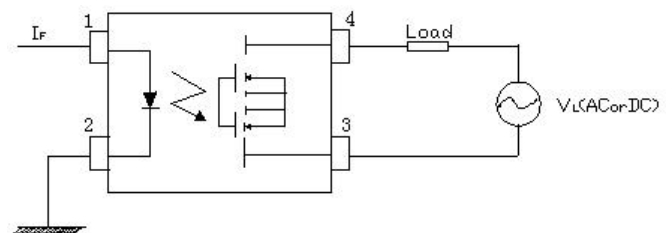



Technical parameters 技术参数 (Ambient Temperature 25°C)

I/O Absolute Maximum Ratings 输入输出电气参数最大值

Item 项目	Symbol 符号	BCY414S		
Operating Temperature 工作温度	T_{OPR}	-40°C~+85°C		
Storage Temperature 储存温度	T_{STG}	-40°C~+100°C		
Input 输入	Continuous LED Current 工作电流	MAX. 最大值	I_F	50mA
	Peak LED Current LED 峰值电流 (f=100Hz, Duty=1%)	MAX. 最大值	I_{FP}	500mA
	LED Reverse Voltage 反向电压	MAX. 最大值	V_R	5V
	Input Power Dissipation 输入功耗	MAX. 最大值	P_{IN}	75mW
Output 输出	Load Voltage 输出电压	MAX. 最大值	V_L	400V (AC peak or DC)
	Load Current 输出电流	MAX. 最大值	I_L	0.12A
	Peak Load Current 峰值输出电流 (100ms, 1shot)	MAX. 最大值	I_{PEAK}	0.3A
	Output Power Dissipation 输出功耗	MAX. 最大值	P_{OUT}	500mW
Total Power Dissipation 总功耗	MAX. 最大值	P_T	550mW	
I/O Breakdown Voltage 输入输出间隔离电压	MAX. 最大值	$V_{I/O}$	1500Vrms	

Electrical Specifications 输入输出电气参数

Item 项目	Symbol 符号	BCY414S	Conditions 条件		
Input 输入	LED Forward Voltage 正向电压	TYP. 典型值	V_F	1.2V	$I_F=10mA$
		MAX. 最大值		1.4V	
	Operation LED Current 接通电流	TYP. 典型值	$I_{F ON}$	0.5mA	
		MAX. 最大值		3mA	
Recovery LED Voltage 关断电压	MIN. 最小值	$V_{F OFF}$	0.5V		
Output 输出	On-Resistance 导通电阻	TYP. 典型值	R_{ON}	20Ω	$I_F=5mA, I_L=50mA,$ within 1 sec.
		MAX. 最大值		50Ω	
	Off-State Leakage Current 漏电流	MAX. 最大值	I_{LEAK}	10μA	$I_F=5mA, V_L=Rating$
Output Capacitance 输出端容量	TYP. 典型值	C_{OUT}	165pF	$I_F=5mA, V_L=0V,$ f=1MHz	
Time parameters 时间参数	Turn-On Time 接通时间	TYP. 典型值	T_{ON}	0.02ms	$I_F=5mA, I_L=50mA$
		MAX. 最大值		1ms	
	Turn-Off Time 关断时间	TYP. 典型值	T_{OFF}	0.5ms	
		MAX. 最大值		3ms	
I/O 输入输出	I/O Insulation Resistance 绝缘电阻	MIN. 最小值	$R_{I/O}$	1000MΩ	DC500V
	I/O Capacitance 隔离电容	TYP. 典型值	$C_{I/O}$	0.8pF	f=1MHz



Reference Data 参考数值 (BCY414S)

Load current Vs. Ambient temperature
输出电流-环境温度曲线

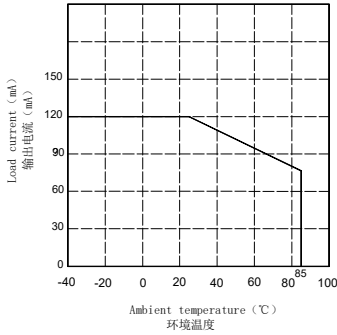

On resistance Vs. Ambient temperature
导通电阻-环境温度曲线

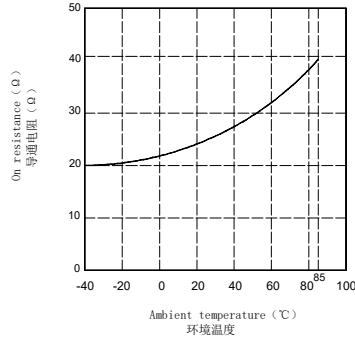

Operate (OFF) time Vs. Ambient temperature
动作时间-环境温度曲线

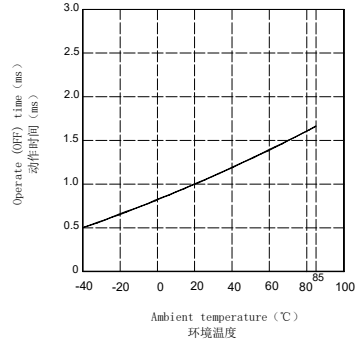

Reverse (ON) time Vs. Ambient temperature
复位时间-环境温度曲线

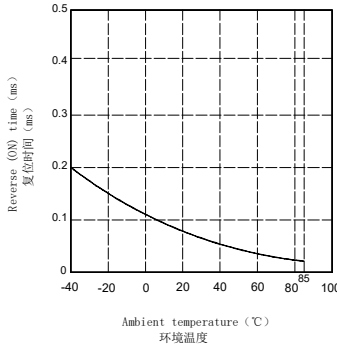

LED operate (OFF) current Vs. Ambient temperature
动作电流-环境温度曲线

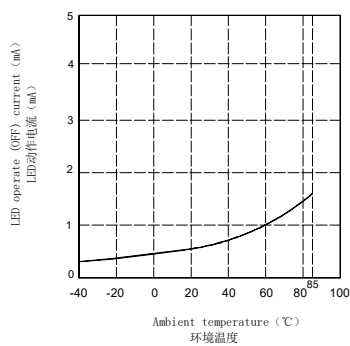

LED turn off current Vs. Ambient temperature
关断电流-环境温度曲线

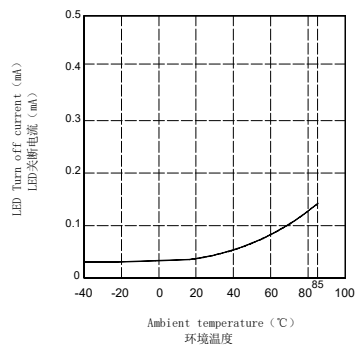

LED forward voltage Vs. Ambient temperature
LED正向电压-环境温度曲线

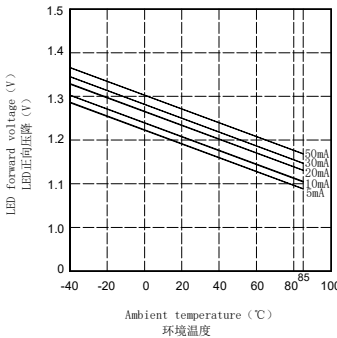

Voltage Vs. current characteristics of output at MOS portion
MOS管输出电压-输出电流曲线

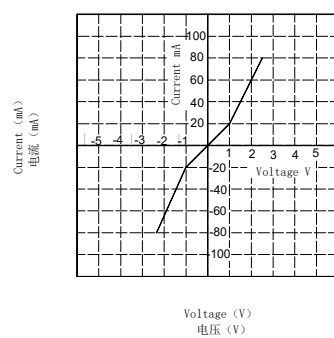

Off state leakage current Vs. Load voltage characteristics
输出漏电流-输出电压曲线

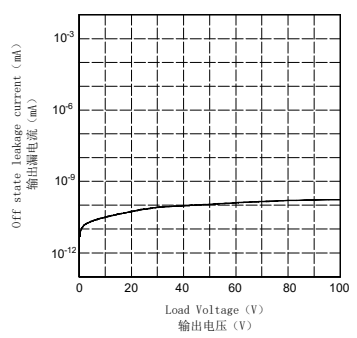

LED forward current Vs. Reverse (ON) time
LED正向(工作)电流-复位时间曲线

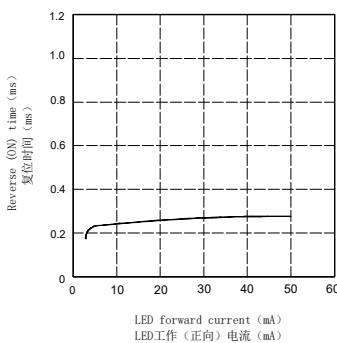

LED forward current Vs. Operate (OFF) time
LED正向(工作)电流-动作时间曲线

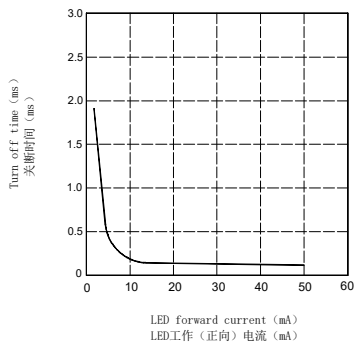

Applied voltage Vs. output capacitance characteristics
输出电压-输出电容曲线

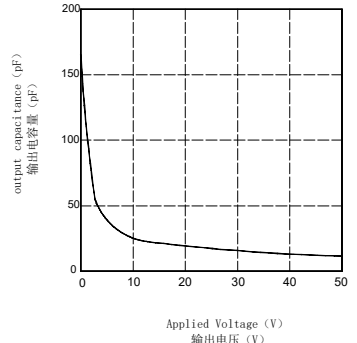

通讯地址: 陕西省西安市国家民用航天产业基地航天中路385号众创广场11层1101.1102.1104室

生产地址: 陕西省宝鸡市陈仓区群力路1号 邮政编码: 721300

电话: (0917)-6293969 18609177833

传 真: (0917)-6293969

X-ON Electronics

Largest Supplier of Electrical and Electronic Components

Click to view similar products for [Solid State Relays - PCB Mount](#) category:

Click to view products by [Vishay](#) manufacturer:

Other Similar products are found below :

[M86F-2W](#) [M90F-2W](#) [M90F-2Y](#) [901-SX](#) [G2-1A07-ST](#) [G2-1A07-TT](#) [G2-1B02-TT](#) [G2-DA06-ST](#) [PLA134S](#) [DS11-1005](#) [AQH3213J](#)
[AQV210EHJ](#) [AQV212J](#) [AQV252GAJ](#) [AQV258AJ](#) [AQY210ST](#) [AQY221N2SJ](#) [AQY221R2SJ](#) [EFR1200480A150](#) [901-7](#) [LCA220](#) [LCB110S](#)
[1618400-5](#) [SR75-1ST](#) [AQV112KLJ](#) [AQV212AJ](#) [AQV238AD01](#) [AQV252GAXJ](#) [AQW414TS](#) [AQY212ST](#) [AQY275AXJ](#) [AQY414SXE01](#)
[G2-1A02-ST](#) [G2-1A03-ST](#) [G2-1A03-TT](#) [G2-1A05-ST](#) [G2-1A06-TT](#) [G2-1A23-TT](#) [G2-1B01-ST](#) [G2-1B01-TT](#) [G2-1B02-ST](#) [G2-DA03-ST](#)
[G2-DA03-TT](#) [G2-DA06-TT](#) [3-1617776-2](#) [CTA2425](#) [TLP3131\(F\)](#) [LBA110S](#) [LBB110S](#) [LCA110LSTR](#)