

## S-11 Double Contact Bayonet Base

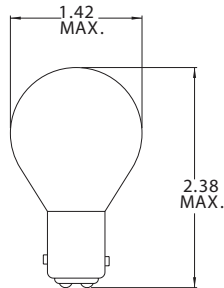

Part Number	Design Voltage	Amps	MSCP	Life Hours	Filament Type
CM1724	6.2	4.50	32.0	400	C-6
CM310	28.0	.90	32.0	300	C-2V
CM312	28.0	1.29	50.0	300	C-2V

## T-3/4 Wire Terminal

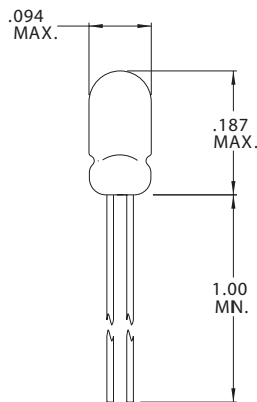

Part Number	Design Voltage	Amps	MSCP	Life Hours	Filament Type
CM7101	1.5	.015	.010	5,000	C-2R
CM28	4.5	.021	.020	5,000	C-2R
CM30	4.5	.021	.020	5,000	C-2R
CM3102	4.5	.022	.020	5,000	C-2R
CM2	5.0	.021	.030	10,000	C-2R
CM6153	5.0	.060	.150	3,000	C-2R
CM6803	5.0	.060	.030	60,000	C-2R
CM6833	5.0	.060	.050	25,000	C-2R
CM7102	5.0	.115	.200	5,000	C-2R
CM7133	5.0	.075	.090	25,000	C-2R
CM7153	5.0	.115	.150	40,000	C-2R
CM8537	5.0	.015	.020	1,000	C-2R
CM8666	5.0	.080	.150	15,000	C-2R

## T-3/4 Micro-Midget Flange Base

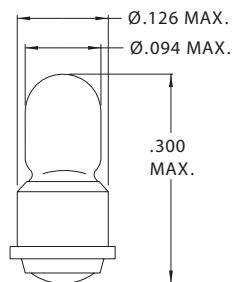

Part Number	Design Voltage	Amps	MSCP	Life Hours	Filament Type
CM3810	1.5	.015	.003	10,000	C-6
CM3811	1.5	.015	.010	5,000	C-6
CM7121	2.5	.110	.001	10,000	C-2R
CM6183	5.0	.060	.150	3,000	C-2
CM7122	5.0	.021	.030	10,000	C-2R
CM7123	5.0	.115	.200	5,000	C-2R
CM8270	5.0	.115	.150	40,000	C-2R

## X-ON Electronics

Largest Supplier of Electrical and Electronic Components

*Click to view similar products for [visual communications manufacturer](#):*

Other Similar products are found below :

[VAOL-3MCE2](#) [7349](#) [139A-403A](#) [25P-607W](#) [LPC\\_127\\_CTP](#) [STD600BLK](#) [CMC01R](#) [CNXBE4218](#) [5314N1](#) [4302H5-5V](#) [1092D3-28V](#)  
[5602F1-5V](#) [CNX718N90005T](#) [VC1510145W3](#) [5110F1-5V](#) [B2A-10PK](#) [6S6/30V-10PK](#) [1091M1-24V](#) [CMD95-21VRC/TR10](#)  
[CNX"C"E"4"1"04](#) [2SB-NWG48H](#) [2SB-NWW48H](#) [7512D2](#) [2191U5-12V](#) [2191L5-12V](#) [CNX\\_310\\_220\\_E\\_4\\_1\\_08](#) [CNX310033X4124](#) [3150-](#)  
[10PK](#) [4304H5](#) [CNX\\_410\\_220\\_X02\\_4\\_1\\_24](#) [4303F5](#) [5400A1](#) [CMD15-21UBC/TR8](#) [LMS\\_113\\_CTP](#) [CTHS15CIC06ALARM](#)  
[CTHS15CIC04ONOFF](#) [STD\\_850\\_BLK](#) [SML\\_190\\_RTP](#) [2110A1](#) [5302H5-5V](#) [5680F7\\_7](#) [CNX722C50024W](#) [DSM7UA30105](#)  
[PML50RGFVW](#) [CNX"482"1"RTP"12](#) [L79D-Y125-W](#) [5300H6](#) [LMC120CTP](#) [2191QL7-24V](#) [5352T1-5VLC](#)