

T-1 3/4 Midget Groove Base

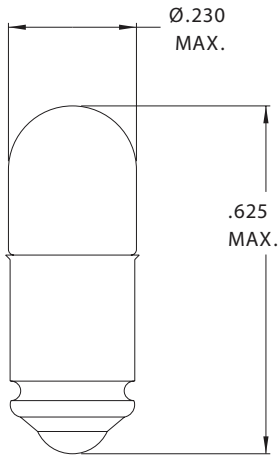

Part Number	Design Voltage	Amps	MSCP	Life Hours	Filament Type
CM698	1.35	.060	.010	500	C-6
CM266	2.50	.350	.210	10,000	C-2R
CM8699	2.50	.200	.220	500	C-2R
CM8704	2.70	.060	.040	6,000	C-2R
CM390	3.00	.015	.004	10,000	C-6
CM8849	3.00	.350	.300	10,000	C-2R
CM7345	4.50	.120	.050	25,000	C-2R
CM3152	5.00	.060	.150	5,000	C-2R
CM7346	5.00	.060	.030	60,000	C-2R
CM7347	5.00	.060	.050	25,000	C-2R
CM7348	5.00	.115	.150	40,000	C-2R
CM7350	5.00	.190	.450	1,000	C-2R
CM337	6.00	.200	.600	1,000	C-2R
CM8705	6.00	.040	.030	10,000	C-2R
CM8706	6.00	.200	.100	50,000	C-2F
CM379	6.30	.200	.400	20,000	C-2F
CM398	6.30	.200	.550	5,000	C-2R
CM7351	6.30	.040	.020	2,000	C-2V
CM7352	6.30	.150	.450	3,000	C-2R
CM8708	6.30	.070	.230	1,000	C-2R
CM397	10.0	.040	.080	5,000	C-2F
CM709	10.0	.140	.002	50,000	C-2F
CM7353	11.0	.022	.030	10,000	C-2F
CM7354	12.0	.040	.120	10,000	C-2F
CM336	14.0	.080	.500	1,500	C-2F
CM386	14.0	.080	.300	15,000	C-2F
CM393	14.0	.100	.500	10,000	C-2F
CM346	18.0	.040	.150	10,000	C-2F
CM457	22.0	.040	.300	2,000	C-2F
CM8177	24.0	.050	.500	1,000	C-2F
CM2350	28.0	.050	.700	1,000	C-2F
CM276	28.0	.060	.340	25,000	C-2F
CM334	28.0	.040	.340	4,000	C-2F
CM388	28.0	.040	.300	7,000	C-2F
CM6035	28.0	.024	.150	4,000	C-2F
CM7355	28.0	.040	.150	10,000	C-2F
CM7356	28.0	.065	.650	5,000	C-2F
CM2250	48.0	.025	.200	5,000	C-2F

X-ON Electronics

Largest Supplier of Electrical and Electronic Components

Click to view similar products for [Lamps category](#):

Click to view products by [Visual Communications manufacturer](#):

Other Similar products are found below :

[5911-086-13](#) [5AB](#) [6180](#) [7009](#) [8623](#) [909](#) [912](#) [1224](#) [1230](#) [DE603](#) [DNW21-DW10/BLA](#) [BF20100-11B](#) [1892](#) [NL177WL2A](#) [NL276C2A](#)
[IFL-LX2162-16T](#) [C2A-T](#) [C9A](#) [301](#) [303](#) [SM2440L](#) [A1C](#) [A2B](#) [19](#) [268](#) [GT-NE6H1225T](#) [CM1820](#) [CM5004WW](#) [303](#) [32-2211T](#) [36EN-2113](#)
[407](#) [4916S1](#) [521-7332](#) [5314N1](#) [5314N2](#) [311](#) [WWT1-EW10/GRN](#) [4925H1](#) [DW07](#) [MS25231-313](#) [5603437](#) [5603851](#) [CM2](#) [7683EBP](#) [8553](#)
[XE135B](#) [WWT2-EW34BLA](#) [5705H7](#) [NL2951WL2G](#)