

40 Series

Ø .250" (6.35mm)

LED Panel Mount Indicator



Built-in long life LED, offer superior construction and longer life flush or raised LED indicator with fresnel lens, single, bi-color and tri-color options, LED voltage 2VDC - 120VAC.

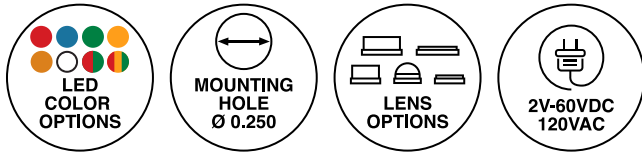

Key Features

- Mounting hole size: .250" (6.35mm)
- Lens type options: hi-hat, flush, hi-dome, wide hi-hat, and wide flush all featured with fresnel pattern lens which provides excellent light focus and assures maximum light output
- Lens color options: red, amber, yellow, green, blue, water clear, and smoke
- Voltage options: 2-60 VDC or 120VAC
- Terminals: bi-pin, straight leads, and wire leads (6" wire leads, 24 AWG)
- Wire leads: 6.0" total length (nominal) / .50" stripped (nominal), red anode/black cathode, 24 AWG TPB UL1061 insulation
- T-1 3/4 (5mm) LED
- LED single color options: red, amber, green, orange, blue, and white
- Bi-color option: red/green
- Tri-color option: red/amber/green
- Mounts with spring retainer and washer (included)
- The C option specifies a pin length of .20"
- Offered with black bezel that enhances the LED contrast
- Available with a variety of LEDs including AlInGaP and InGaN technology for high brightness applications, single color, bi-color and with integrated resistors
- Low power consumption - uses up to 90% less energy than an incandescent indicator
- Suitable for high vibration applications
- LEDs operate significantly cooler than traditional lamps
- For custom cable length, connectors or colors contact VCC
- Compliant with RoHS and REACH

Ordering Data

41 (Hi-Hat Lens)



Example:

41-NKG12H-CGO

41 Series Hi-Hat Lens, Green LED,
Clear Green Lens, 12V with Straight Leads

41W (Hi-Hat Lens)



Example:

41W-NKA12H-CAO

41 Series Hi-Hat Lens, Amber LED,
Clear Amber Lens, 12V with Wire Leads

Part Number	Color	λ_{pk} (nm)	Iv (mcd)	Viewing Angle	Lens Color	Lens Diffusion	Terminals	Voltage/Current	
								Design Vf/If	Max Vf/If
41-NKA120-CAO	Amber	592	3600	15	Amber	Clear	Straight Leads	120VAC/3.5mA	130VAC/4mA
41-NKG120-CGO	Green	520	10000	15	Green	Clear	Straight Leads	120VAC/3.5mA	130VAC/4mA
41-NKR120-CRO	Red	634	3600	15	Red	Clear	Straight Leads	120VAC/3.5mA	130VAC/4mA
41-NWR120-CWO	Red	634	2800	30	Clear	Clear	Straight Leads	120VAC/3.5mA	130VAC/4mA

41-LRG28H-NWO	Red/Green	660/565	90/40	60	Clear	Diffused	Straight Leads	28V/16.5mA	30V/18mA
41-NKA28H-CAO	Amber	592	3600	15	Amber	Clear	Straight Leads	28V/16.5mA	30V/18mA
41-NKG28H-CGO	Green	520	10000	15	Green	Clear	Straight Leads	28V/15mA	30V/17mA
41-NKR28H-CRO	Red	634	3600	15	Red	Clear	Straight Leads	28V/16.5mA	30V/18mA

41-NKA12H-CAO	Amber	592	3600	15	Amber	Clear	Straight Leads	12V/20mA	14V/25mA
41-NKG12H-CGO	Green	520	10000	15	Green	Clear	Straight Leads	12V/15mA	14V/20mA
41-NKR12H-CRO	Red	634	3600	15	Red	Clear	Straight Leads	12V/20mA	14V/25mA

41-NWB5H-NWO	Blue	465	700	45	Clear	Diffused	Straight Leads	5V/15mA	5.5V/23mA
--------------	------	-----	-----	----	-------	----------	----------------	---------	-----------

Part Number	Color	λ_{pk} (nm)	Iv (mcd)	Viewing Angle	Lens Color	Lens Diffusion	Terminals	Voltage/Current	
								Design Vf/If	Max Vf/If

41W-NKA120-CAO	Amber	592	3600	15	Amber	Clear	Wire Leads	120VAC/3.5mA	130VAC/4mA
41W-NKG120-CGO	Green	520	10000	15	Green	Clear	Wire Leads	120VAC/3.5mA	130VAC/4mA
41W-NKR120-CRO	Red	634	3600	15	Red	Clear	Wire Leads	120VAC/3.5mA	130VAC/4mA

41W-NWL48H-CWO	White	-	1800	50	Clear	Clear	Wire Leads	48V/9.5mA	50V/10mA
----------------	-------	---	------	----	-------	-------	------------	-----------	----------

41W-NKA28H-CAO	Amber	592	3600	15	Amber	Clear	Wire Leads	28V/16.5mA	30V/18mA
41W-NKG28H-CGO	Green	520	10000	15	Green	Clear	Wire Leads	28V/15mA	30V/17mA
41W-NKR28H-CRO	Red	634	3600	15	Red	Clear	Wire Leads	28V/16.5mA	30V/18mA

41W-NKA12H-CAO	Amber	592	3600	15	Amber	Clear	Wire Leads	12V/20mA	14V/25mA
41W-NKA12H-CWO	Amber	592	3600	15	Clear	Clear	Wire Leads	12V/20mA	14V/25mA
41W-NKG12H-CGO	Green	520	10000	15	Green	Clear	Wire Leads	12V/15mA	14V/20mA
41W-NKR12H-CRO	Red	634	3600	15	Red	Clear	Wire Leads	12V/20mA	14V/25mA

Ordering Data

Part Number	Color	λ_{pk} (nm)	Iv (mcd)	Viewing Angle	Lens Color	Lens Diffusion	Terminals	Voltage/Current	
								Design Vf/If	Max Vf/If
41W-BA2-SO	Amber	583	16	60	Smoke	-	Wire Leads	2V	-
41W-BG2-SO	Green	565	10	60	Smoke	-	Wire Leads	2V	-
41W-BR2-SO	Red	635	14	60	Smoke	-	Wire Leads	2V	-

C41 (41 Series with pin length of .20")



Example:

C41-BG24H-CGO

41 Series Hi-Hat Lens, Green LED,
Clear Green Lens, 24V

Part Number	Color	λ_{pk} (nm)	Iv (mcd)	Viewing Angle	Lens Color	Lens Diffusion	Terminals	Voltage/Current	
								Design Vf/If	Max Vf/If
C41-BG24H-CGO	Green	565	10	60	Green	Clear	Bi-Pin	24V/17mA	26V/20mA

Ordering Data

44 (Flush Lens)



Example:

44-NKA28H-CAO

44 Series Flush Lens, Amber LED,
Clear Amber Lens, 28V with Straight Leads

44W (Flush Lens)



Example:

44W-NKG120-CGO

44 Series Flush Lens, Green LED,
Clear Green Lens, 120V with Wire Leads

Part Number	Color	λ_{pk} (nm)	Iv (mcd)	Viewing Angle	Lens Color	Lens Diffusion	Terminals	Voltage/Current	
								Design Vf/If	Max Vf/If
44-NKA120-CAO	Amber	592	3600	15	Amber	Clear	Straight Leads	120VAC/3.5mA	130VAC/4mA
44-NKG120-CGO	Green	520	10000	15	Green	Clear	Straight Leads	120VAC/3.5mA	130VAC/4mA
44-NKR120-CRO	Red	634	3600	15	Red	Clear	Straight Leads	120VAC/3.5mA	130VAC/4mA
44-NKA28H-CAO	Amber	592	3600	15	Amber	Clear	Straight Leads	28V/16.5mA	30V/18mA
44-NKG28H-CGO	Green	520	10000	15	Green	Clear	Straight Leads	28V/15mA	30V/17mA
44-NKR28H-CRO	Red	634	3600	15	Red	Clear	Straight Leads	28V/16.5mA	30V/18mA
44-LRG12H-CWO	Red/Green	660/565	90/40	60	Clear	Clear	Straight Leads	12V/20mA	14V/25mA
44-RAG12H-CWO	Red/Amb/Grn	630/565	6/6/6	60	Clear	Clear	Straight Leads	12V/20mA	14V/25mA
44-NKA12H-CAO	Amber	592	3600	15	Amber	Clear	Straight Leads	12V/20mA	14V/25mA
44-NKG12H-CGO	Green	520	10000	15	Green	Clear	Straight Leads	12V/15mA	14V/20mA
44-NKR12H-CRO	Red	634	3600	15	Red	Clear	Straight Leads	12V/20mA	14V/25mA
44-BA2-NAO	Amber	583	16	60	Amber	Diffused	Straight Leads	2V	-
44-BCA2-NAO	Amber	583	100	35	Amber	Diffused	Straight Leads	2V	-
44-BG2-NGO	Green	565	10	60	Green	Diffused	Straight Leads	2V	-

Part Number	Color	λ_{pk} (nm)	Iv (mcd)	Viewing Angle	Lens Color	Lens Diffusion	Terminals	Voltage/Current	
								Design Vf/If	Max Vf/If
44W-NKA120-CAO	Amber	592	3600	15	Amber	Clear	Wire Leads	120VAC/3.5mA	130VAC/4mA
44W-NKG120-CGO	Green	520	10000	15	Green	Clear	Wire Leads	120VAC/3.5mA	130VAC/4mA
44W-NKR120-CRO	Red	634	3600	15	Red	Clear	Wire Leads	120VAC/3.5mA	130VAC/4mA
44W-NKA28H-CAO	Amber	592	3600	15	Amber	Clear	Wire Leads	28V/16.5mA	30V/18mA
44W-NKG28H-CGO	Green	520	10000	15	Green	Clear	Wire Leads	28V/15mA	30V/17mA
44W-NKR28H-CRO	Red	634	3600	15	Red	Clear	Wire Leads	28V/16.5mA	30V/18mA

Ordering Data

Part Number	Color	λ_{pk} (nm)	Iv (mcd)	Viewing Angle	Lens Color	Lens Diffusion	Terminals	Voltage/Current	
								Design Vf/If	Max Vf/If
44W-LRG12H-CWO	Red/Green	660/565	90/40	60	Clear	Clear	Wire Leads	12V/20mA	14V/25mA
44W-RAG12H-CWO	Red/Amb/Grn	630/565	6/6/6	60	Clear	Clear	Wire Leads	12V/20mA	14V/25mA
44W-NKA12H-CAO	Amber	592	3600	15	Amber	Clear	Wire Leads	12V/20mA	14V/25mA
44W-NKG12H-CGO	Green	520	10000	15	Green	Clear	Wire Leads	12V/15mA	14V/20mA
44W-NKR12H-CRO	Red	634	3600	15	Red	Clear	Wire Leads	12V/20mA	14V/25mA

C44 (44 Series with pin length of .20")



Example:

C44-BA24H-NAO

44 Series Flush Lens, Amber LED,
Diffused Amber Lens, 24V

Part Number	Color	λ_{pk} (nm)	Iv (mcd)	Viewing Angle	Lens Color	Lens Diffusion	Terminals	Voltage/Current	
								Design Vf/If	Max Vf/If
C44-BA24H-NAO	Amber	583	16	60	Amber	Diffused	Bi-Pin	24V/17mA	26V/20mA
C44-BG24H-NGO	Green	565	10	60	Green	Diffused	Bi-Pin	24V/17mA	26V/20mA
C44-BR5H-NRO	Red	635	14	60	Red	Diffused	Bi-Pin	5V/22mA	5.5V/28mA

464 (Wide Flush Lens)



Example:

464W-BCG2-NGO-R-

464 Series Wide Flush Lens, Green LED,
Diffused Green Lens, 2V with Wire Leads

Part Number	Color	λ_{pk} (nm)	Iv (mcd)	Viewing Angle	Lens Color	Lens Diffusion	Terminals	Voltage/Current	
								Design Vf/If	Max Vf/If
464W-NWO60H-NAO-R-	Orange	605	2000	30	Amber	Diffused	Wire Leads	60V/9mA	65V/10mA
464W-NKR5H-CRO	Red	634	3600	15	Red	Clear	Wire Leads	5V/22mA	5.5V/28mA
464W-BCA2-NYO-R-	Amber	583	100	35	Yellow	Diffused	Wire Leads	2V	-
464W-BCG2-NGO-R-	Green	565	80	24	Green	Diffused	Wire Leads	2V	-

Ordering Data

461 (Wide Hi-Hat Lens)



Example:

461-BR24H-CRO

461 Series Wide High-Hat Lens, Red LED,
Clear Red Lens, 24V with Straight Leads

Part Number	Color	λ_{pk} (nm)	Iv (mcd)	Viewing Angle	Lens Color	Lens Diffusion	Terminals	Voltage/Current	
								Design Vf/If	Max Vf/If
461-BA24H-CAO	Amber	583	16	60	Amber	Clear	Straight Leads	24V/17mA	26V/20mA
461-BA24H-CYO-R-	Amber	583	16	60	Yellow	Clear	Straight Leads	24V/17mA	26V/20mA
461-BA24H-SO	Amber	583	16	60	Smoke	-	Straight Leads	24V/17mA	26V/20mA
461-BG24H-CGO	Green	565	10	60	Green	Clear	Straight Leads	24V/17mA	26V/20mA
461-BG24H-SO	Green	565	10	60	Smoke	-	Straight Leads	24V/17mA	26V/20mA
461-BR24H-CRO	Red	635	14	60	Red	Clear	Straight Leads	24V/17mA	26V/20mA
461-BR24H-SO	Red	635	14	60	Smoke	-	Straight Leads	24V/17mA	26V/20mA
461-BA5H-CYO-R-	Amber	583	16	60	Yellow	Clear	Straight Leads	5V/22mA	5.5V/28mA
461-BA2-NAO	Amber	583	16	60	Amber	Diffused	Straight Leads	2V	-
461-BG2-NGO	Green	565	10	60	Green	Diffused	Straight Leads	2V	-
461-BR2-NRO	Red	635	14	60	Red	Diffused	Straight Leads	2V	-

C46 (Hi-Dome Lens with pin length of .20")



Example:

C46-BG5H-CGO

46 Series Hi-Dome Lens, Green LED,
Clear Green Lens, 5V

Part Number	Color	λ_{pk} (nm)	Iv (mcd)	Viewing Angle	Lens Color	Lens Diffusion	Terminals	Voltage/Current	
								Design Vf/If	Max Vf/If
C46-RAG24H-CWO	Red/Amb/Grn	630/565	6/6/6	60	Clear	Clear	Bi-Pin	24V/17mA	26V/20mA
C46-BA5H-CWO	Amber	583	16	60	Clear	Clear	Bi-Pin	5V/22mA	5.5V/28mA
C46-BG5H-CGO	Green	565	10	60	Green	Clear	Bi-Pin	5V/22mA	5.5V/28mA
C46-BR5H-CWO	Red	635	14	60	Clear	Clear	Bi-Pin	5V/22mA	5.5V/28mA

Product Dimensions

41 (Hi-Hat Lens)

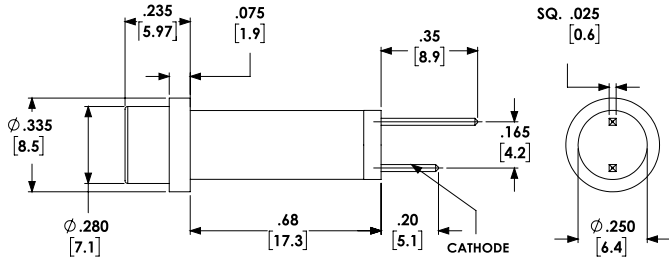

44 (Flush Lens)

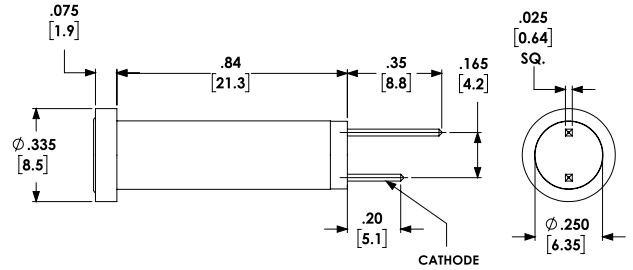

461 (Wide Hi-Hat Lens)

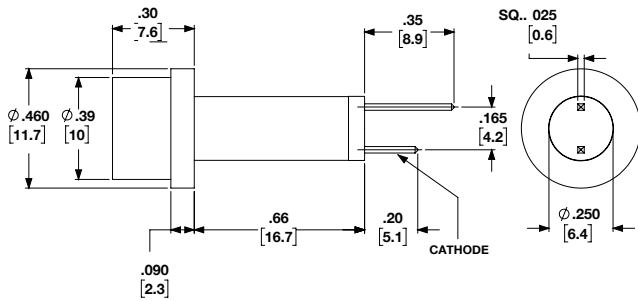

464 (Wide Flush Lens)

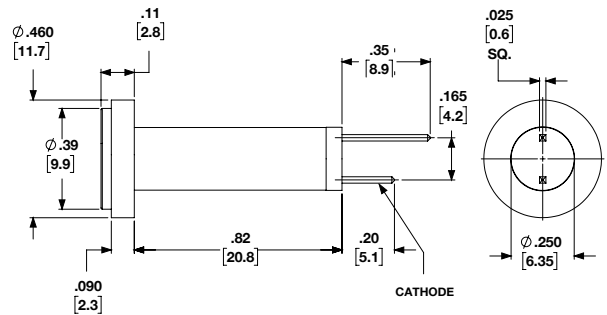

46 (Hi-Dome Lens)

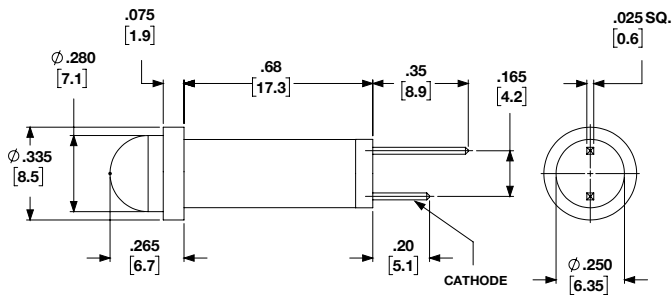

Recommended Mounting Hole

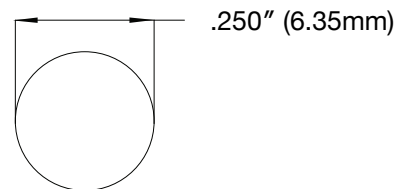

Notes:

1. All dimensions are in inches [millimeters]
2. Tolerance is $\pm 0.25''$ unless otherwise noted.
3. The specifications, characteristics and technical data described in the datasheet are subject to change without prior notice.

Product Dimensions

TC4 & NW4 (Mounting Hardware)

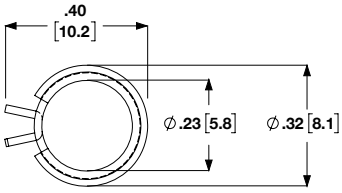

TC4

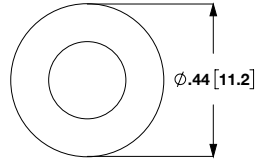
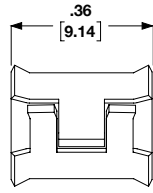

NW4

Notes:

1. All dimensions are in inches [millimeters]
2. Tolerance is $\pm 0.25''$ unless otherwise noted.
3. The specifications, characteristics and technical data described in the datasheet are subject to change without prior notice.

Compliances and Approvals



X-ON Electronics

Largest Supplier of Electrical and Electronic Components

Click to view similar products for [LED Panel Mount Indicators](#) category:

Click to view products by [Visual Communications Company](#) manufacturer:

Other Similar products are found below :

[607-3232-140F](#) [821-0331-503](#) [FL2870C8R](#) [FL2950WL7B](#) [FL2950WL8G](#) [FL589WL8R](#) [FL67C8R](#) [H8630FBBA3](#) [NL177WL2A](#)
[NL177WL3G](#) [NL276C2A](#) [NL2950BWL3G](#) [NL589WL2R](#) [NL67C2C](#) [NL67C3R](#) [C480AABG3](#) [PB22BM41K](#) [PB22SIM40Y](#)
[PB22SKRS31KC](#) [L32R-R2-2311](#) [L3353-MWRG](#) [L39UR-R24-2111](#) [L58D-G2-W](#) [L58D-Y2-W](#) [L59D-R12-W](#) [L59UD-R12-W](#) [L625DG](#)
[L625DR](#) [LE177WL39007](#) [LH1048BSWL3702](#) [LH1048BWL3702](#) [LH382A](#) [LH677G](#) [LHM628A](#) [FL276WL7R](#) [FL2950BWL7R](#)
[FL2950WL7R](#) [FL2950WL8R](#) [FL2950WL8R-12](#) [FL2951WL8G](#) [FL2951WL8R](#) [FL589C7R](#) [FL67WL8G](#) [MPC5BCW18.0](#) [556-1605-808F](#)
[556-1705-809F](#) [556-3008-839F](#) [558-0201-818F](#) [559-0001-813F](#) [559-1301-801F](#)