

# CNX 460 Series

## Build Your Own Indicator

### for Use With T-3 1/4 (10mm) LEDs



CNX 460 Series features modular panel mount indicator assemblies and mounting hardware and require no tools for assembly



#### Applications

- Industrial
- Transportation
- Emergency Applications
- Maritime, Oil and Gas Industry
- Automation and Control
- People Movers
- Instrument Panels
- Gaming and Vending Machines
- Outdoor Applications

#### Key Features

- For panel hole diameter: .562" (14.288mm) opening on 0.75" (19.05mm) center
- Choice of 4 different types of lenses
- Terminations available: stripped end, locking connector, 2,3,4 wire options
- Eliminates the need for soldering or crimping wires
- Available wire gauge: 24 AWG
- Available in 6 standard wire lengths, from 4" to 24"
- Choice of 4 different wires colors: White/Black, Red/Black, White/Black/Red and White/Black/Red/Green
- Panel thickness .030" (.762mm) - .188" (4.775mm)
- 10mm (T-3 1/4) LED with or without flange and lens needs to be ordered separately
- For additional options please contact our technical sales department
- U.S. and foreign patent issued
- RoHS and REACH Compliant

## Ordering Data

Series	LED Termination	Wire Size	Wire Color	Wire Length																																		
<b>CNX 460</b>	<b>X02</b>	<b>4</b>	<b>1</b>	<b>12</b>																																		
	<table border="1"> <tr><td>X</td><td>Stripped End</td></tr> <tr><td>E</td><td>Single Row Locking Header</td></tr> <tr><td>D</td><td>Dual Row Locking Header</td></tr> <tr><td>02</td><td>2 Wires</td></tr> <tr><td>03</td><td>3 Wires</td></tr> <tr><td>04</td><td>4 Wires</td></tr> </table>	X	Stripped End	E	Single Row Locking Header	D	Dual Row Locking Header	02	2 Wires	03	3 Wires	04	4 Wires	<table border="1"> <tr><td>4</td><td>24 AWG</td></tr> </table>	4	24 AWG	<table border="1"> <tr><td>1</td><td>White-Black</td></tr> <tr><td>2</td><td>Red/Black</td></tr> <tr><td>6</td><td>White-Black-Red</td></tr> <tr><td>0</td><td>White-Black-Red-Green</td></tr> </table>	1	White-Black	2	Red/Black	6	White-Black-Red	0	White-Black-Red-Green	<table border="1"> <tr><td>04</td><td>4in (101.6mm)</td></tr> <tr><td>06</td><td>6in (152.4mm)</td></tr> <tr><td>08</td><td>8in (203.2mm)</td></tr> <tr><td>12</td><td>12in (304.8mm)</td></tr> <tr><td>18</td><td>18in (457.2mm)</td></tr> <tr><td>24</td><td>24in (609.6mm)</td></tr> </table>	04	4in (101.6mm)	06	6in (152.4mm)	08	8in (203.2mm)	12	12in (304.8mm)	18	18in (457.2mm)	24	24in (609.6mm)
X	Stripped End																																					
E	Single Row Locking Header																																					
D	Dual Row Locking Header																																					
02	2 Wires																																					
03	3 Wires																																					
04	4 Wires																																					
4	24 AWG																																					
1	White-Black																																					
2	Red/Black																																					
6	White-Black-Red																																					
0	White-Black-Red-Green																																					
04	4in (101.6mm)																																					
06	6in (152.4mm)																																					
08	8in (203.2mm)																																					
12	12in (304.8mm)																																					
18	18in (457.2mm)																																					
24	24in (609.6mm)																																					



Example:

**CNX\_460\_X02\_4\_1\_12**

Stripped End, 2 Wires, 24 AWG Wire Size, White/Black Wire Color, 12 Inch Wire Length

*Shown with 5mm (T-1 3/4) LED and HMS 462 Lens*

\*Call VCC for additional options

## Terminations



**Stripped End (X)**

Wire color options



**Single Row (E)**

Locking Connector  
2, 3, or 4 Wire Options



**Dual Row (D)**

Locking Connector  
2, 3, or 4 Wire Options

## Accessories (Order Separately)



**10mm (T-3 1/4)**

2-lead with or  
without Flange



**10mm (T-3 1/4)**

3-lead with or  
without Flange



**HMC 461**

Sealed Fresnel Lens

- HMC\_461\_RTP
- HMC\_461\_BTP
- HMC\_461\_GTP
- HMC\_461\_ATP
- HMC\_461\_YTP
- HMC\_461\_CTP



**HMC 463**

Sealed Fresnel Lens

- HMC\_463\_CTP



**HMS 462**

Sealed Fresnel Lens

- HMS\_462\_RTP
- HMS\_462\_BTP
- HMS\_462\_GTP
- HMS\_462\_ATP
- HMS\_462\_YTP
- HMS\_462\_CTP



**HMS 464**

Sealed Fresnel Lens

- HMS\_464\_CTP

## Product Dimensions

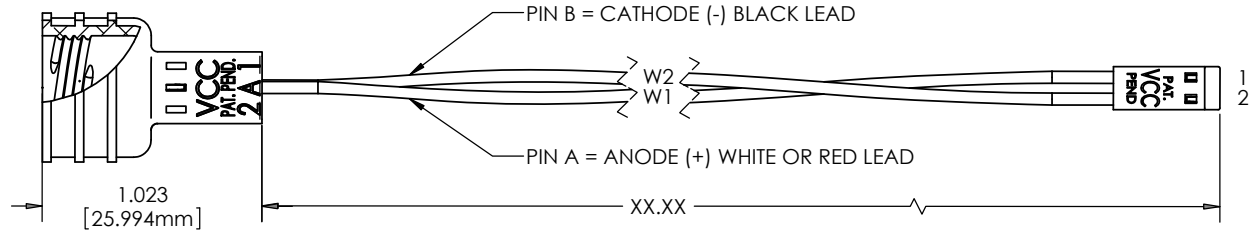

## Recommended Mounting Hole

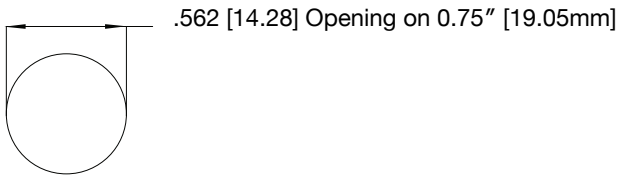

## Notes:

1. All dimensions are in inches [millimeters]
2. Tolerance is  $\pm .500$  [12.7] unless otherwise noted.
3. XX.XX refer to wire length
4. The specifications, characteristics and technical data described in the datasheet are subject to change without prior notice.

## Product Specifications

Materials	
Panel Connector Socket	Polyester, UL 94-V0
Head Connector	Polyester, UL 94-V0
Lens	Polycarbonate, UL 94-V2
Moisture Seal	EPDM
Lock Washer	Steel, Nickel Plate
Terminals	Phosphor Bronze, Tin Plate
Wire	24 AWG 1007/1569

Installation Specifications	
Mounting Hole	.562" (14.288mm) opening on 0.75" (19.05mm) center
Panel Thickness	.030" (.762mm) Min - .188" (4.775mm) Max
LED Lead Length	Bi-Lead: Trim to .300" $\pm$ 0.010 (7.620mm $\pm$ 0.254) Hi-Flux: No trim required Tri-Lead: Contact VCC
Applications	HMC 461 or HMC 463 Lens - For standard dry applications HMS 462 or HMS 464 Lens - Dust and wet conditions (Exceeds NEMA 6P/IP67)

## Compliances and Approvals



## X-ON Electronics

Largest Supplier of Electrical and Electronic Components

*Click to view similar products for [Lighting Cables](#) category:*

*Click to view products by [Visual Communications Company](#) manufacturer:*

Other Similar products are found below :

[CL2-EXTEND](#) [96CB-E0605HAA1](#) [ZWF-915-J](#) [68801-4899](#) [68801-2112](#) [68801-2123](#) [68801-4124](#) [68801-4752](#) [68801-4850](#) [ZFS-CH144-12I](#) [96CB-E0405PCA3](#) [96CB-E0405PIC3](#) [96CB-E0605HAB1](#) [SSL11-J2LJ0-022A04](#) [CNXBE4218](#) [1-2058943-7](#) [1-2058943-8](#) [1-2083075-2](#) [1-2083080-1](#) [CNX310-120-X4124](#) [CNX\\_C\\_E\\_4\\_2\\_08](#) [CNXBE4118](#) [CNX\\_310\\_012\\_E\\_4\\_1\\_12](#) [2702306](#) [2702307](#) [SSL12-J4FJ0-000001](#) [180888-0405](#) [SSL12-J2LJ0-020F01](#) [180887-0430](#) [1705131](#) [180887-0410](#) [180778-0405](#) [1-2083029-8](#) [SSL12-J4LJ0-020H01](#) [180778-0430](#) [SSL12-P4LP0-M20H01](#) [SSL12-P4LP0-M20F01](#) [SSL12-P2LP0-M20F01](#) [SSL12-J4LJ0-020F01](#) [SSL11-J2LJ0-B22A04](#) [68801-4037](#) [68801-4039](#) [68801-4053](#) [68801-4055](#) [68801-4057](#) [68801-4059](#) [68801-4061](#) [960026](#) [2-2083030-2](#) [SSL12-J2LJ0-020A04](#)