

**NOTES:**

1. ROHS COMPLIANT
2. MATERIALS:  
 FIBER OPTIC:  $\varnothing$ 1.5MM OPTICAL CORE,  $\varnothing$ 2.2MM POLYETHYLENE CABLE JACKET  
 LENS MOUNT: OPTICAL GRADE ACRYLIC  
 LED MOUNTS: FOR SMD 22 & THR 22 - NYLON 66, UL RATING 94-V2  
 FOR THR 5 22 - NYLON 66, UL RATING 94-HB  
 LENS: POLYCARBONATE, UL RATING 94-V2  
 LENS SPACER: POLYPROPYLENE
3. OPTICAL CORE ENDS POLISHED TO 10 MICRONS.
4. PANEL MOUNTING HOLE .250" (6.35mm) ON 3/8" (9.52mm)CENTERS
5. PANEL THICKNESS FOR CLF 280: 1/16" (1.60mm) TO 1/8" (3.18mm);  
 CLB 300, CLR 301 AND SQB 400: 1/32" (0.79mm) TO 1/4" (6.35mm).
6. FOR PANELS LESS THAN 3/16" (4.76mm) USE SPC 125 SPACER
7. FOR ADDED SECURITY USE RNG 268.
8. FOR BEST RESULTS USE ONLY NARROW VIEWING ANGLE NON-DIFFUSED LEDS WITH OUTPUT POWER GREATER THAN 100mcd.
9. U.S. AND FOREIGN PATENS ISSUED.

LIGHT PIPE ASSEMBLY ORDERING CODE (EXAMPLE): **FLX XX**

LENGTH	
LENGTH CODE	ACTUAL LENGTH
02	2.0"
04	4.0"
06	6.0"
08	8.0"
12	12.0"
CUSTOM LENGTHS AVAILABLE UPON REQUEST	

REVISIONS					
ECN #	REV.	DESCRIPTION	DATE	INITIALS	CHK'D
-	001	INITIAL RELEASE	7/8/10	SMU	DZ
-	002	CHG DWG FORMAT	8/2/10	KH	AZ
-	003	REVISED PER ECR 092810AA01	10/4/10	KH	AZ
396	004	REVISED PER ECR 011812KH01	1/19/12	KH	AZ

**MOUNTING OPTIONS (ORDER SEPARATELY)**

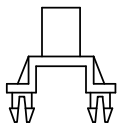

SMD 22

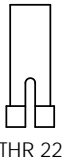

THR 22

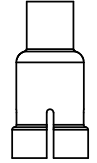

THR 5 22

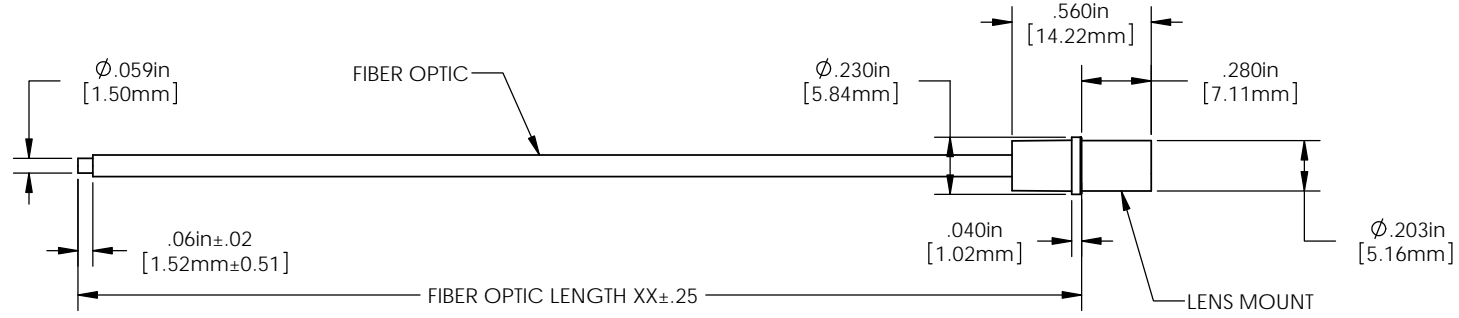

**LENS OPTIONS (ORDER SEPARATELY)**

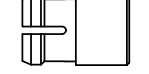

CLF 280

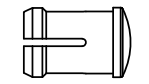

CLB 300

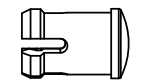

CLR 301



SQB 400

<small>DIMENSION STYLE: INCHES (MM)                  GENERAL TOLERANCES UNLESS OTHERWISE SPECIFIED</small> <table border="1"> <tr> <th>INCHES</th> <th>MM</th> </tr> <tr> <td>X</td> <td>± 0.20 ± 0.508</td> </tr> <tr> <td>XX</td> <td>± 0.10 ± 0.254</td> </tr> <tr> <td>XXX</td> <td>± 0.05 ± 1.27</td> </tr> </table>	INCHES	MM	X	± 0.20 ± 0.508	XX	± 0.10 ± 0.254	XXX	± 0.05 ± 1.27	<small>APPROVAL</small> DRAWN: KHOWARD CHECKED: AZANELLI	<small>DATE</small> 8/2/10 8/2/10	OPTOELECTRONICS 190 BOSSTICK BLVD. SUITE 101 SAN MARCOS, CA 92069 U.S.A. PHONE: (760) 560-1300, FAX: (760) 560-1301 EMAIL: vccsales@vccclite.com
	INCHES	MM									
X	± 0.20 ± 0.508										
XX	± 0.10 ± 0.254										
XXX	± 0.05 ± 1.27										
<small>ANGLE</small> 1 <small>SEE ALL DIMS AND SHARP EDGES 0.015" MAX</small> THIRD ANGLE PROJECTION <small>PROPRIETARY AND CONFIDENTIAL</small> THE INFORMATION CONTAINED IN THIS DRAWING IS THE SOLE PROPERTY OF VISUAL COMMUNICATIONS COMPANY, INC. ANY REPRODUCTION IN PART OR AS A WHOLE WITHOUT THE WRITTEN PERMISSION OF VISUAL COMMUNICATIONS COMPANY, INC IS PROHIBITED.	<small>MATERIAL</small> SEE NOTES	<small>TITLE:</small> FLX XX ASSEMBLY									
<small>FINISH</small> SEE NOTES	<small>DO NOT SCALE DRAWING</small>	<small>SCALE: 1:1</small>	<small>SIZE</small> DWG. NO. <b>B</b> FLX XX REV <b>004</b> SHEET 1 OF 1								

## X-ON Electronics

Largest Supplier of Electrical and Electronic Components

*Click to view similar products for [LED Light Pipes](#) category:*

*Click to view products by [Visual Communications Company](#) manufacturer:*

Other Similar products are found below :

[1367627-1](#) [SLP3-300-450-F](#) [SLP3-400-450-R](#) [LPA-C011301S-6](#) [LPF-C011306S](#) [FLP25-1.95](#) [VLP-640-F](#) [LPA-C011301S-5.4](#) [LPA-R051171S-12](#) [LPA-S011331S](#) [515-1027-803F](#) [515-1217F](#) [SLP3-150-300-R](#) [SLP3-500-450-R](#) [515-1064-810F](#) [FLPV-SG](#) [BDL-1187](#)  
[7511A41](#) [7511A87-500](#) [FLPV-SBC](#) [5151064802F](#) [5151-192-0055-0DF](#) [LPF-R011340S](#) [515-1166-801F](#) [FLPF-6.0](#) [SLP3-350-200-F](#) [PM4-C1522-3.70](#) [LC-11.25](#) [CLP-1214](#) [515-1064-808F](#) [FLX3\\_05](#) [515-1192-0025-0DF](#) [HS LC-H-D2/ R2XC1-2 54](#) [515-1192-80-3DF](#) [1282.2600](#)  
[1296.2004](#) [PBLP-1001-1](#) [SZ1-10.00-A220-F4P54](#) [LC2-4.1](#) [1296.7042](#) [SF4-2.5-F5P](#) [PLP5-2-625-54](#) [FLP25-13.5](#) [1330.1001](#) [1330.1002](#)  
[1330.1004](#) [1330.1006](#) [1330.1007](#) [1330.1008](#) [1271.2002](#)