

# PRODUCT DATA SHEET

**1365f.61**

**Plug pins – 1365 F Ms ag 12.5x3.8**

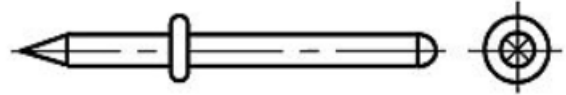

## Product Overview

|                    |                       |
|--------------------|-----------------------|
| SKU                | 1365f.61              |
| Part description   | Plug pin              |
| Part designation   | 1365 F Ms ag 12.5x3.8 |
| Net weight kg/1000 | 0.150                 |

### Material

|           |                            |
|-----------|----------------------------|
| Component | Brass (CuZn37 CW508L R410) |
| Surface   | silver-plated              |

### Marking

|                       |           |
|-----------------------|-----------|
| RoHS III, REACH       | compliant |
| Conflict Minerals DRC | compliant |

## Dimension

|             |      |
|-------------|------|
| Form        | A    |
| ØD [mm]     | 1.3  |
| L [mm]      | 12.5 |
| T [mm]      | 3.8  |
| L1 [mm]     | 8.1  |
| ØD1 [mm]    | 2.5  |
| B [mm]      | 1.4  |
|             |      |
| Hole-Ø [mm] | 1.3  |

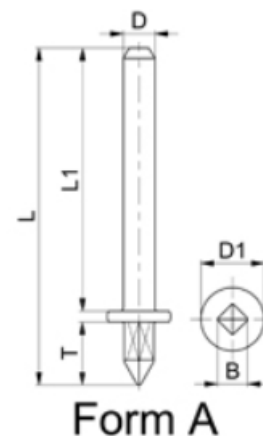

© 2020 / Vogt AG Verbindungstechnik

This leaflet is for general information about the base material only and is not subject to revision.

The data given are no warranty that the product is of a specified quality and they can not replace customer's own test and expert advice regarding the application of the manufactured component.

## X-ON Electronics

Largest Supplier of Electrical and Electronic Components

*Click to view similar products for [Terminals](#) category:*

*Click to view products by [Vogt](#) manufacturer:*

Other Similar products are found below :

[00-054007-01074-6](#) [00-054007-70206-1](#) [00-054007-70210-8](#) [00-054007-70217-7](#) [00-054007-70226-9](#) [00-054007-70228-3](#) [00-054007-70248-1](#) [00-054007-70256-6](#) [00-054007-70301-3](#) [00-054007-70316-7](#) [00-054007-49560-4](#) [00-054007-70209-2](#) [00-054007-70225-2](#) [00-054007-70227-6](#) [00-054007-70231-3](#) [00-054007-70241-2](#) [00-054007-70242-9](#) [00-054007-70244-3](#) [00-054007-70246-7](#) [00-054007-70263-4](#) [00-054007-70288-7](#) [00-054007-70290-0](#) [00-054007-70300-6](#) [00-054007-70304-4](#) [01-2065-1-0216](#) [01-2900-1-04412](#) [00581P0075](#) [600TS-10](#) [60205-1](#) [604200-1](#) [605601-1](#) [60598-1-CUT-TAPE](#) [60617-1-C](#) [61314-6-C](#) [61810-3](#) [61-S](#) [626-0194](#) [62-NBM-A](#) [62-SP](#) [63-S](#) [640179-1](#) [M55155/059I03](#) [M55155/079C01](#) [M55155/099H02](#) [M55155/109H01](#) [M55155/109H02](#) [M55155/12XH05](#) [M55155/16XH02](#) [M55155/29-5S](#) [M55155/29XJ08](#)