

日期/Date
 档案号
 Filing Clerk

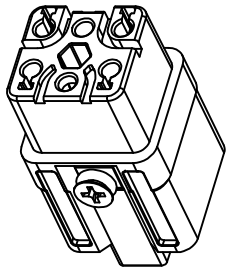
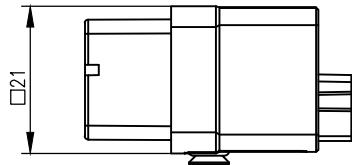
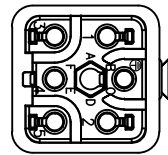
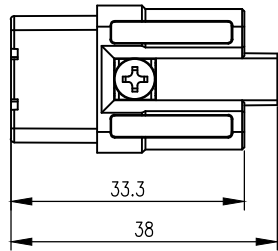
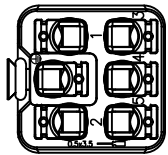

技术参数:

- 插针数: 5+PE
- 额定电流: 16A
- 额定电压: 230/400V
- 额定脉冲电压: 4kV
- 污染等级: 3
- 绝缘阻抗: $> 10^{10}\Omega$
- 材料: 聚碳酸酯
- 颜色: RAL 7032 (浅灰色)
- 温度范围: $-40^{\circ}\text{C} - +125^{\circ}\text{C}$
- 依据UL 94的阻燃等级: V0
- 可插拔次数: > 500

插针:

- 接线方式: 弹片连接
- 材料: 铜合金
- 处理: 镀银
- 电阻: $\leq 3\text{m}\Omega$
- 范围: $0.5-4.0\text{mm}^2/20-12\text{ AWG}$
- (带管形接线端子线径范围: $0.14-2.5\text{mm}^2/26-14\text{ AWG}$)
- 剥线长度: $10\pm 0.5\text{mm}$
- 附件:

· 编码元件: CODE-Q5

Technical specification:

Inserts:

- No. of contact: 5+PE
- Rated current: 16A
- Rated voltage: 230/400V
- Rated impulse voltage: 4kV
- Pollution degree: 3
- Insulation resistance: $> 10^{10}\Omega$
- Material: polycarbonate
- Colour: RAL 7032(light grey)
- Temperature range: $-40^{\circ}\text{C} - +125^{\circ}\text{C}$
- Flammability acc.to UL 94: V0
- Mating cycles: > 500

Contacts:

- Terminal: spring terminal
- Material: copper alloy
- Surface: Hard-silver plated
- Contact resistance: $\leq 3\text{m}\Omega$
- Wire gauge: $0.5-4.0\text{mm}^2/20-12\text{ AWG}$
- (For wires with crimped ferrule, wire gauge: $0.14-2.5\text{mm}^2/26-14\text{ AWG}$)
- Stripping length: $10\pm 0.5\text{mm}$
- Tools:

· Coding element: CODE-Q5

						表面处理 Finish		-		图号 Drawing No.		-		
						材料 Material		-		产品代号 Part Code		HQ-005/0-FQ		
标记 Mark	处数 Number	变更描述/Description			签名 Signature	日期 Date	比例 Scale		版本 REV.	重量 Weight	数量 Qty.	产品料号 Part No.		
绘图 Drawn	TC YE	05.01.2022	标准化 Stand.	-	-	1:1	V1.0	-	-	产品名称 Part Name				
审核 Checked	HZ LAN	05.01.2022											-	
工艺 Process	-	-	批准 Approved	HQ ZHANG	05.01.2022			All Dimensions in mm Original Size DIN A 4		厦门唯恩电气有限公司 XIAMEN WAIN ELECTRICAL CO.LTD				

X-ON Electronics

Largest Supplier of Electrical and Electronic Components

Click to view similar products for [DC Power Connectors](#) category:

Click to view products by [WAIN](#) manufacturer:

Other Similar products are found below :

[KLDX-SMT-0202-BPTR](#) [171-0722-E](#) [K596](#) [KLD-0201-BC](#) [4C6831AX](#) [10073976-112LF](#) [LCB60PW-M](#) [LCB30PW-M](#) [LCB60PB-M](#)
[LCC30PB-M](#) [LCB50PW-M](#) [LCB50-M](#) [LCB60-F](#) [LCC30-M](#) [LCB40PW-M](#) [LCC30PW-M](#) [LCB50-F](#) [LCB40-F](#) [LCB30-F](#) [LCC40-M](#)
[LCC40PB-M](#) [LCB40PB-M](#) [LCC40-F](#) [LCB60-M](#) [LCC40PW-M](#) [LCB50PB-M](#) [DC-002-100](#) [DC-031A-130](#) [DC-031A-100](#) [DC-003A-130](#)
[DC-045-130](#) [DC-192-130](#) [DC-033-130](#) [DC-011-100](#) [DC-002F-130](#) [DC-002-130](#) [DB-14-2F](#) [DC-183B](#) [DC-060-04A](#) [DC-099-200](#) [DC-015-](#)
[250-A](#) [DC-016-200-A](#) [DC-005A-200](#) [DC-044A-200](#) [DC-088-200](#) [DC-022A-200](#) [DC-038-150](#) [DC-012A-250](#) [DC-005C-130](#) [DC-012A-200](#)