

NOTES:
 Rated Current: 2.0AMP.
 Contact Resistance: 20mΩ Max.
 Withstand Voltage: 500V AC/DC
 Insulation Resistance: 1000MΩ Min.
 Operation Temperature: -40°C to +125°C(GOLD)
 -40°C to +105°C(TIN) Δ

Contact Material: Brass
 Contact Plating: Au or Sn Over Ni
 Insulator Material: PA9T+33%GF UL94V-0 BK

Ordering Information

1215-21 XX XX M XXX C R XX Δ

No. of Pins Contact Plating Pin Length Insulator Packing Series No.
 02-40 G0=Gold Flash I=B+C+D+ $\frac{W}{2}$ Material T=Tube 01-99
 Standard: C=PA9T P=Tube+CAP
 G4=10u"Gold
 G3=10u"Gold
 G4=15u"Gold
 G5=30u"Gold
 S0=Gold Flash/Tin
 S3=10u"Gold/Tin
 S4=15u"Gold/Tin
 S5=30u"Gold/Tin
 SN=Tin
 SM=Mate Tin

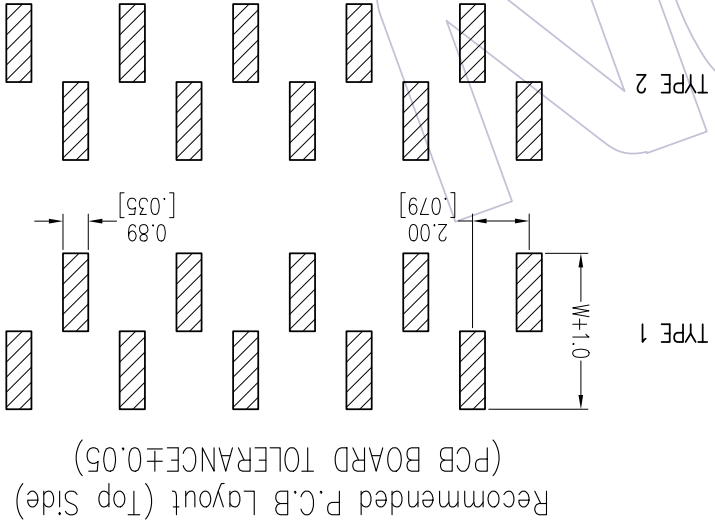
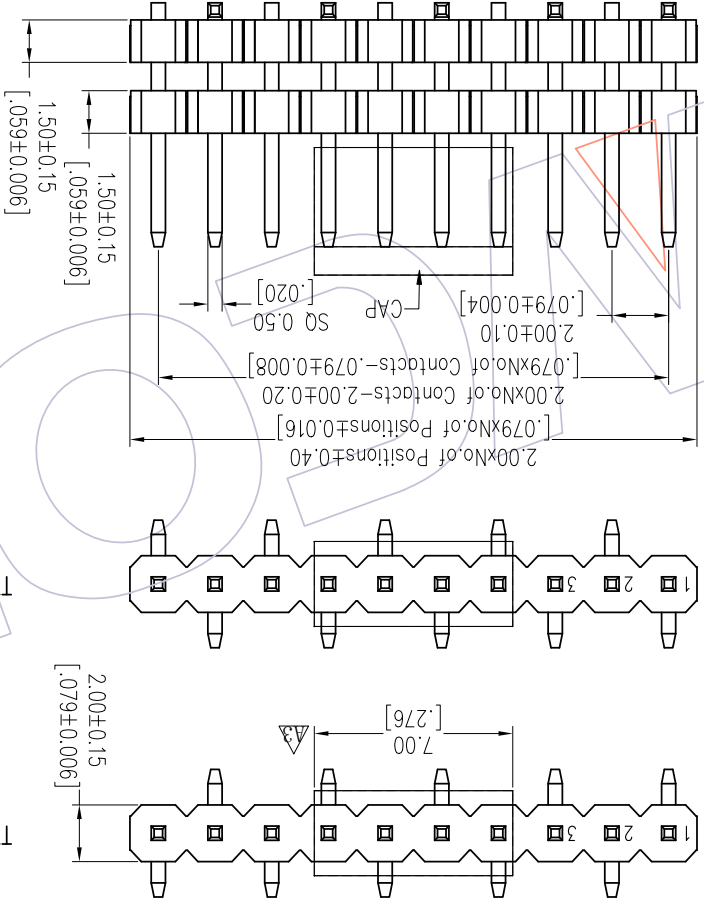

Item	Pin Length	W	D	B	E	Mating
Standard	---	4.50	0.10	4.00	---	2240 2243 2263 2272
Alternate						

REV	DATE	MODIFICATION DESCRIPTION	CHANGE	DIM	TOL	APPROVE	DATE	PROJ.	Customer NO.	Customer NO.
A0	2012/04/18	NEW	---	Angle ± .3°						
A1	2018/01/18	Modify P/N	Δ	X.XXX ±0.15						
A2	2018/09/07	Modify	Δ	X.XX ±0.25						
A3	2019/07/20	Modify the CAP	Δ	X.X ±0.40						

OPERATION	DRAW	DATE	SCALE	FIT	PART NO.	TITLE:
Δ	Dug	2019/07/20	mm	M	1215-21XXXXMXXXXCRXX Δ	PH2.00 SINGLE ROW DOUBLE PLASTIC SMT H=1.5

DATE	CHECK	DATE	SIZE	SHEET	PROJ.
			A4	1/1	

DATE	APPROVE	DATE	APPROVE	Customer NO.

Item	Pin Length	W	D	B	E	Mating
Standard	---	4.50	0.10	4.00	---	2240 2243 2263 2272
Alternate						

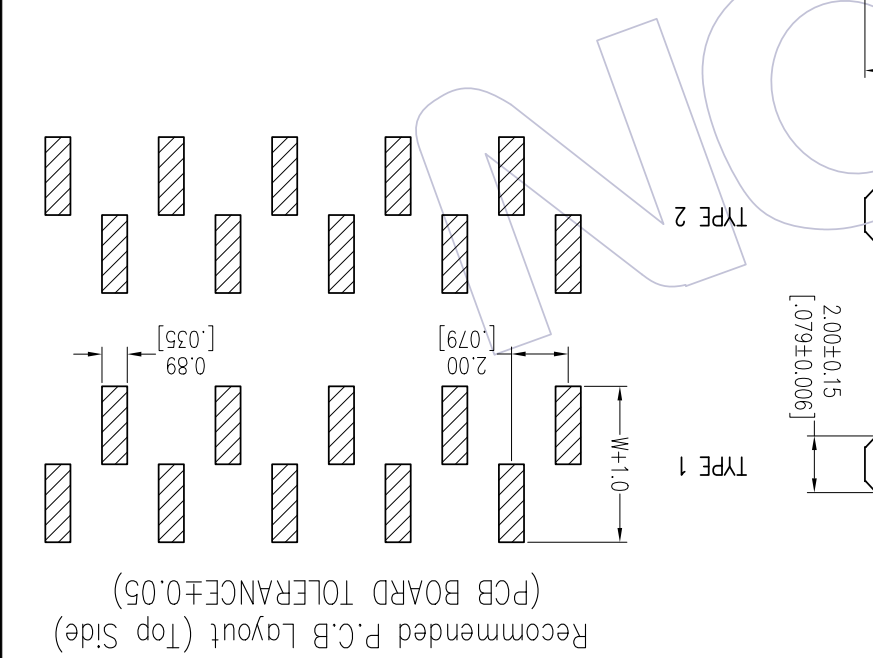
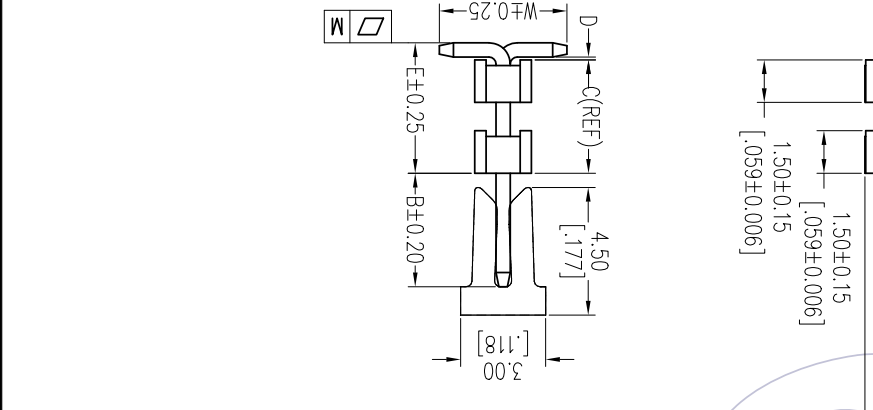

X-ON Electronics

Largest Supplier of Electrical and Electronic Components

Click to view similar products for [Headers & Wire Housings](#) category:

Click to view products by [Wcon](#) manufacturer:

Other Similar products are found below :

[95000-104TRLF](#) [10135584-644402LF](#) [DF62W-EP2022PCA](#) [95000-106TRLF](#) [DF62W-2022SCA](#) [DF62W-EP2022PC](#) [2203348](#) [DF62W-2022SC](#) [1084018](#) [1029039](#) [1084017](#) [802-10-012-10-002000](#) [1112640](#) [1112639](#) [891-007-9SS-BST1T](#) [000-34000](#) [0008550134](#) [0009482033](#) [0009507031](#) [57102-F02-18ULF](#) [57102-S06-03LF](#) [57202-S52-04LF](#) [PCN6-15S-2.5E](#) [0039019024](#) [58102-G61-06LF](#) [582553-1](#) [0009485154](#) [0009508121](#) [0022285053](#) [0050291907](#) [018731A](#) [LY20-4P-DT1-P1E-BR](#) [02.125.8002.8](#) [60101931](#) [60598-1 \(Cut Strip\)](#) [M1625-3R/100](#) [61062-3](#) [61082-181009](#) [CSU011177004](#) [636-1427](#) [638009-1](#) [641938-9](#) [641991-4](#) [644168-1](#) [644827-2](#) [647662-1](#) [65039-019ELF](#) [65692-001LF](#) [65781-018](#) [65781-047](#)