

**HSP**

NOTES:

Rated Current:2.0AMP.  
Contact Resistance:20mΩ Max.

Withstand Voltage:500V AC/DC  
Insulation Resistance:1000MΩ Min.

Operation Temperature:-40℃ to +105℃

Contact Material:Brass  
Contact Plating:Au or Sn Over Ni

Insulator Material:PA9T+33%G.F UL94V-0 BK

### Ordering Information

1220-12 XX XX Z XXX CR XX  $\Delta$

No. of Pins Contact Plating Pin Length(Short) Insulator Packing Series No.  
Per Row:02-40 G0=Gold Flash L=A1+B+2.2 Material T=Tube 01-99  
G3=10u"Gold Standard:06-6.9 C=PA9T P=Tube+CAP  
G4=15u"Gold 080-8.0 R=Tape&Reel+CAP  
G5=30u"Gold 090-9.0  
S0=Gold Flash/Tin  
S3=10u"Gold/Tin  
S4=15u"Gold/Tin  
S5=30u"Gold/Tin  
SN=Tin  
SM=Mate Tin

Item	Pin Length	A1	A	B	Mating
Standard	8.00	2.80	6.22	3.00	
Alternate	9.00	2.80	6.22	4.00	2240 2243 2263 2272

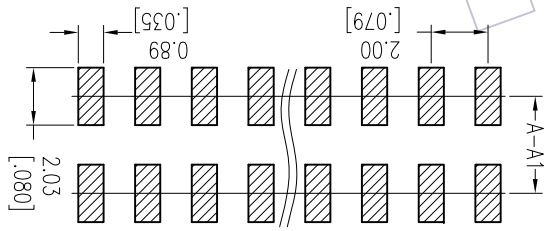
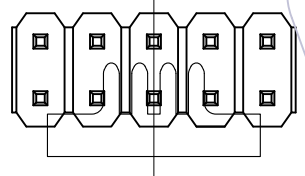
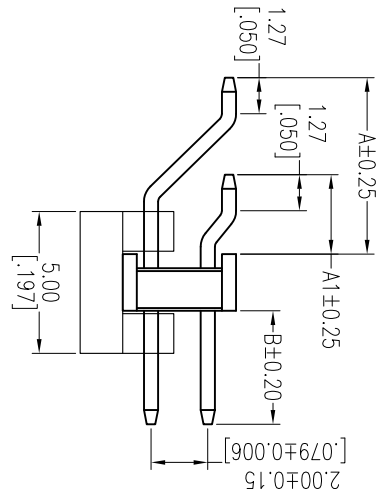
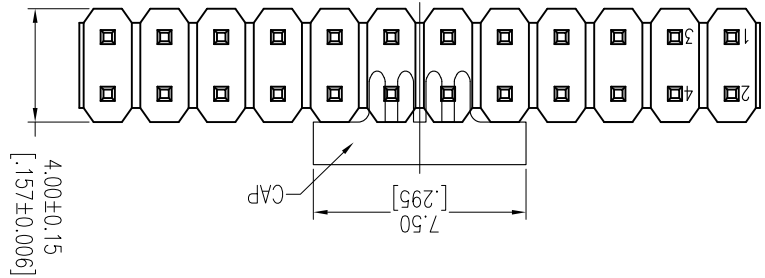
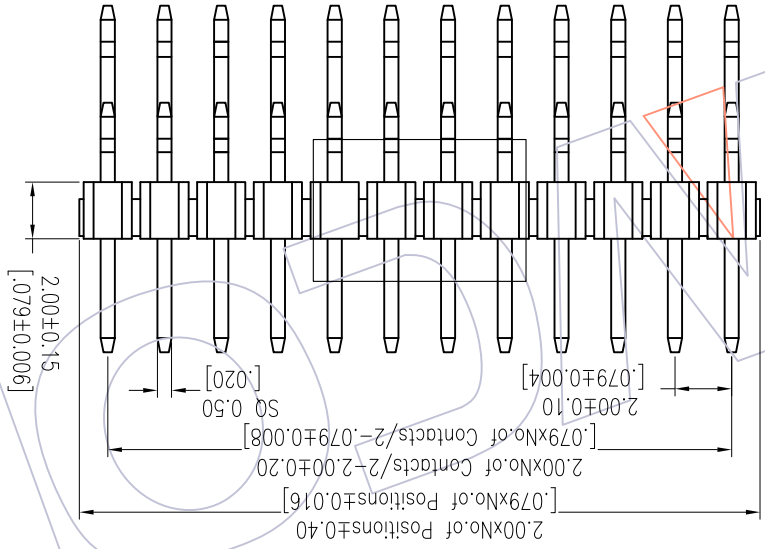

Recommended P.C.B Layout (Top Side)  
(PCB BOARD TOLERANCE±0.05)

REV	DATE	MODIFICATION DESCRIPTION	CHANGE	DIM	TOL	OPERATION	DRAW	DATE	SCALE	FIT	PART NO.	TITLE:	Customer NO.	PROJ.
A0	2012/04/26	NEW	---	Angle	±.3	APPROVE		DATE	SHEET	1/1	Customer NO.	PH2.00 DUAL ROW 90° SMT H=2.0	WCON-Donguan	PROJ.
A1	2018/01/19	Modify P/N	$\Delta$	X.XXX	±0.15	CHECK		DATE	SIZE	A4	1220-12XXXXXXCRXX	PH2.00 DUAL ROW 90° SMT H=2.0	WCON-Kunshan	PROJ.
				X.X	±0.40	OPERATION	2w	2018.01.19	UNIT	mm				

**WCON**  
Http://www.wcon.com

WCON-Donguan  
Tel: +86 769 85358920  
Fax: +86 769 85358915  
E-mail: sdies@wcon.com

WCON-Kunshan  
Tel: +86 512 57468408  
Fax: +86 512 57468468  
E-mail: sdiesks@wcon.com

## X-ON Electronics

Largest Supplier of Electrical and Electronic Components

*Click to view similar products for [Headers & Wire Housings](#) category:*

*Click to view products by [Wcon](#) manufacturer:*

Other Similar products are found below :

[95000-104TRLF](#) [10135584-644402LF](#) [DF62W-EP2022PCA](#) [95000-106TRLF](#) [DF62W-2022SCA](#) [DF62W-EP2022PC](#) [2203348](#) [DF62W-2022SC](#) [1084018](#) [1029039](#) [1084017](#) [802-10-012-10-002000](#) [1112640](#) [1112639](#) [891-007-9SS-BST1T](#) [000-34000](#) [0008550134](#) [0009482033](#) [0009507031](#) [57102-F02-18ULF](#) [57102-S06-03LF](#) [57202-S52-04LF](#) [PCN6-15S-2.5E](#) [0039019024](#) [58102-G61-06LF](#) [582553-1](#) [0009485154](#) [0009508121](#) [0022285053](#) [0050291907](#) [018731A](#) [LY20-4P-DT1-P1E-BR](#) [02.125.8002.8](#) [60101931](#) [60598-1 \(Cut Strip\)](#) [M1625-3R/100](#) [61062-3](#) [61082-181009](#) [CSU011177004](#) [636-1427](#) [638009-1](#) [641938-9](#) [641991-4](#) [644168-1](#) [644827-2](#) [647662-1](#) [65039-019ELF](#) [65692-001LF](#) [65781-018](#) [65781-047](#)