

**HSF**

NOTES:

Current Rating: 3.0AMP  
 Contact Resistance: 20mΩ Max  
 Withstand Voltage: 1000V AC/DC  
 Insulation Resistance: 1000MΩ Min  
 Operation Temperature: -40°C to +125°C(GOLD)  
 -40°C to +105°C(TIN)

Contact Material: Phosphor Bronze  
 Contact plating: Au Or Sn over Ni  
 Insulator Material: PA9T+33%G.F UL94V-0

# Ordering Information

2135-1XXMXXCUNX X

- Series No. \_\_\_\_\_  
 1=TYPE 1  
 2=TYPE 2  
 P=Tube+CAP  
 R=Tape&Reel+CAP  
 G3=10μ Gold  
 G4=15μ Gold  
 G5=30μ Gold  
 S0=Gold Flash/Tin  
 S3=10μ Gold/Tin  
 S4=15μ Gold/Tin  
 S5=30μ Gold/Tin  
 SN=Tin  
 SM=Matte Tin

Item	Pitch	Standard	Alternate
Mating	2.54	1115/1120/1125	

REV	DATE	MODIFICATION DESCRIPTION	CHANG	DIM	TOL	APPROVE	DATE	PROJ.	CUSTOMER NO.	WCON- Dongguan	WCON-Kunshan
A0	2012/08/02	NEW	---	Angle ± 3°	± 0.15					Tel: +86 769 85358915 Fax: +86 769 85358915 E-mail: sales@wcon.com	Tel: +86 512 57468408 Fax: +86 512 57468468 E-mail: sales@wcon.com
A1	2018/05/07	MODIFY CAP : ADD DIM.	---	X.XX ± 0.15	± 0.25				H=3.5	WCON-Dongguan	
A2	2018/08/18	ADD 1*2P-1*3P CAP;MODIFY DRAWING	---	X.X ± 0.40	± 0.25				FH2.54mm SINGLE ROW 180SMT	WCON-Kunshan	
						OPERATION	DATE	SCALE	FIT	Http://www.wcon.com	
						DRAW	DATE	UNIT	mm	Http://www.wcon.com	
						CHECK	DATE	SIZE	A4	Http://www.wcon.com	
						APPROVE	DATE	SHEET	1/1	Http://www.wcon.com	
										Http://www.wcon.com	

TITLE	PART NO.	SPEC.
TYPE 1	2135-1XXMXXCUNX1	DUAL/ODD PINS
TYPE 2	2135-1XXMXXCUNX2	DUAL PINS

PIN	2-15P	16-25P	26-40P
M	0.10	0.15	0.18

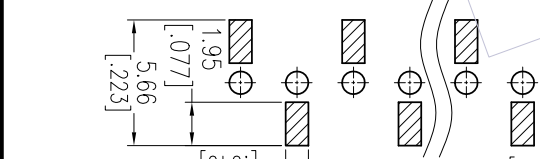
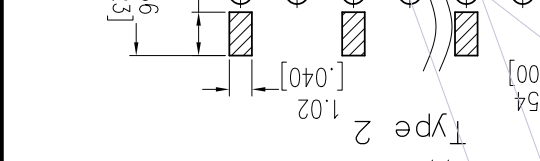
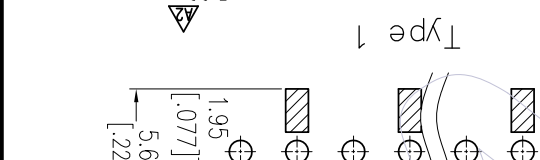
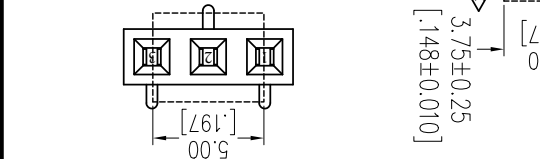
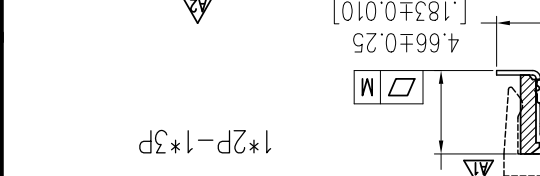

Recommended P.C.B Layout(Top Side)  
 (PCB BOARD TOLERANCE±0.05)

SECTION A-A

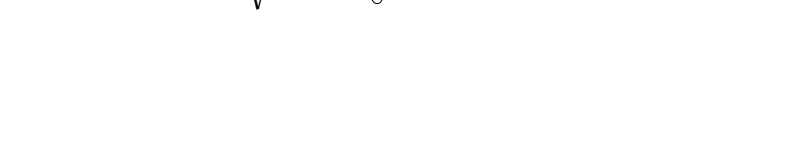
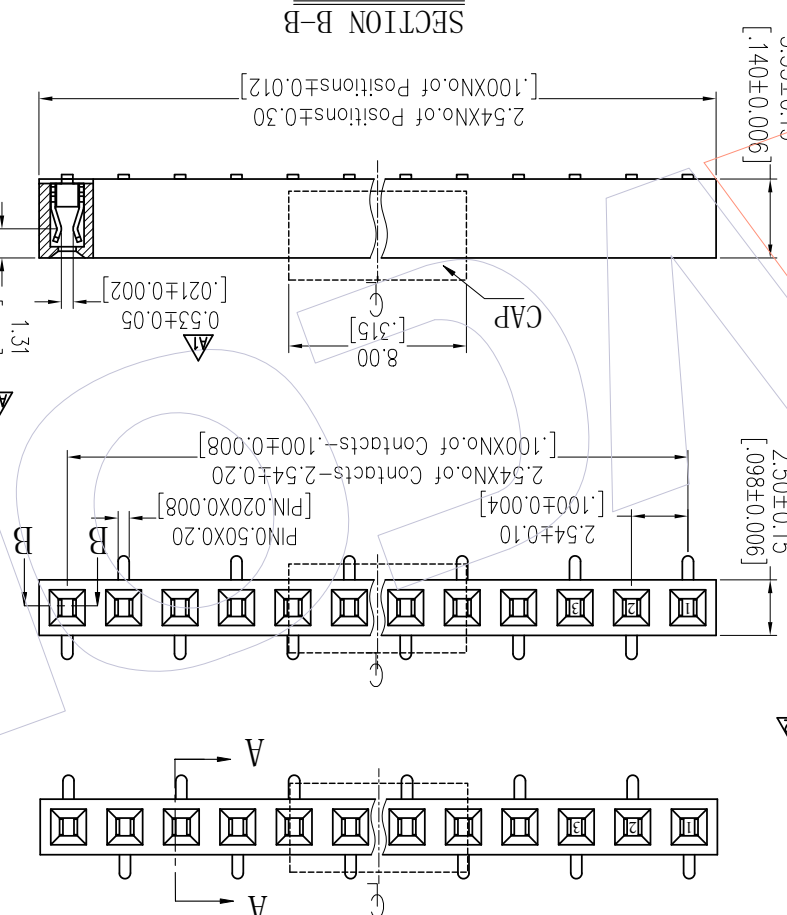

SECTION B-B

## X-ON Electronics

Largest Supplier of Electrical and Electronic Components

*Click to view similar products for [Headers & Wire Housings](#) category:*

*Click to view products by [Wcon](#) manufacturer:*

Other Similar products are found below :

[95000-104TRLF](#) [10135584-644402LF](#) [DF62W-EP2022PCA](#) [95000-106TRLF](#) [DF62W-2022SCA](#) [DF62W-EP2022PC](#) [2203348](#) [DF62W-2022SC](#) [1084018](#) [1029039](#) [1084017](#) [802-10-012-10-002000](#) [1112640](#) [1112639](#) [891-007-9SS-BST1T](#) [000-34000](#) [0008550134](#) [0009482033](#) [0009507031](#) [57102-F02-18ULF](#) [57102-S06-03LF](#) [57202-S52-04LF](#) [PCN6-15S-2.5E](#) [0039019024](#) [58102-G61-06LF](#) [582553-1](#) [0009485154](#) [0009508121](#) [0022285053](#) [0050291907](#) [018731A](#) [LY20-4P-DT1-P1E-BR](#) [02.125.8002.8](#) [60101931](#) [60598-1 \(Cut Strip\)](#) [M1625-3R/100](#) [61062-3](#) [61082-181009](#) [CSU011177004](#) [636-1427](#) [638009-1](#) [641938-9](#) [641991-4](#) [644168-1](#) [644827-2](#) [647662-1](#) [65039-019ELF](#) [65692-001LF](#) [65781-018](#) [65781-047](#)