

**HSP**

NOTES:

Current Rating: 2.0AMP  
 Contact Resistance: 20mΩ Max  
 Withstand Voltage: 500V AC/DC  
 Insulation Resistance: 1000MΩ Min  
 Operation Temperature: -40°C to +105°C  
 Contact Material: Phosphor Bronze  
 Contact plating: Au Or Sn over Ni  
 Insulator Material: PA9T+30%GF UL94V-0

### Ordering Information

2243-2 XX W XX CUN X X

No. of Pins per Row: 02-40Pin  
 Contact Plating: G0=Gold Flash  
 Packing: T=Tube  
 Series No.: 1=TYPE 1  
 2=TYPE 2

S0=Gold Flash/Tin  
 S3=10μ"Gold/Tin  
 S4=15μ"Gold/Tin  
 S5=30μ"Gold/Tin  
 SN=Tin  
 SM=Mate Tin

A=Tray

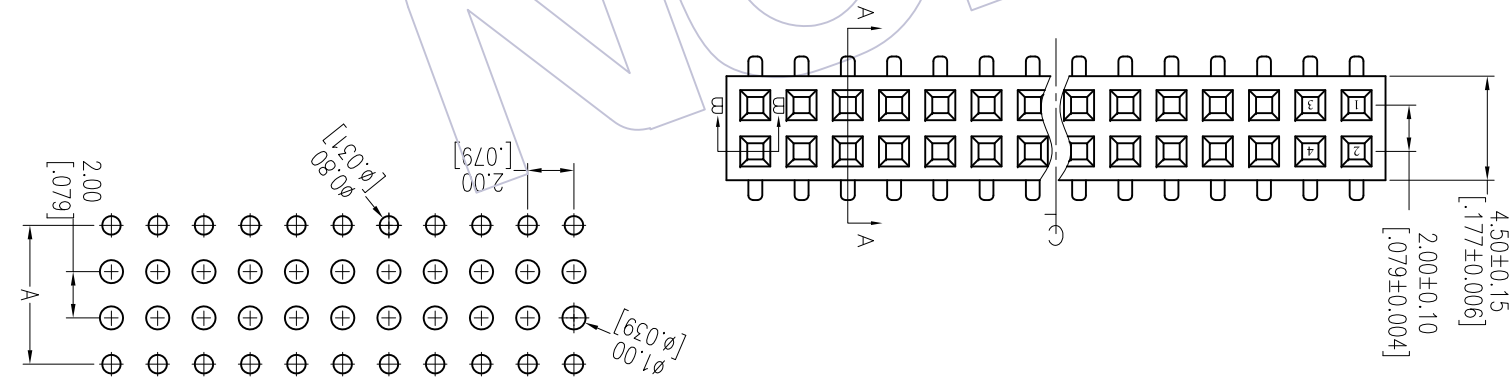

Recommended P.C.B Layout(Top Side)  
 (PCB BOARD TOLERANCE±0.05)

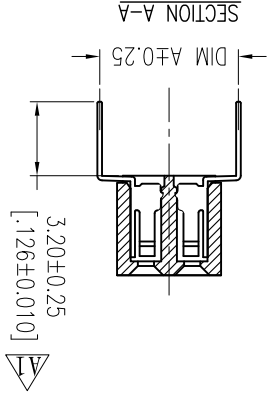
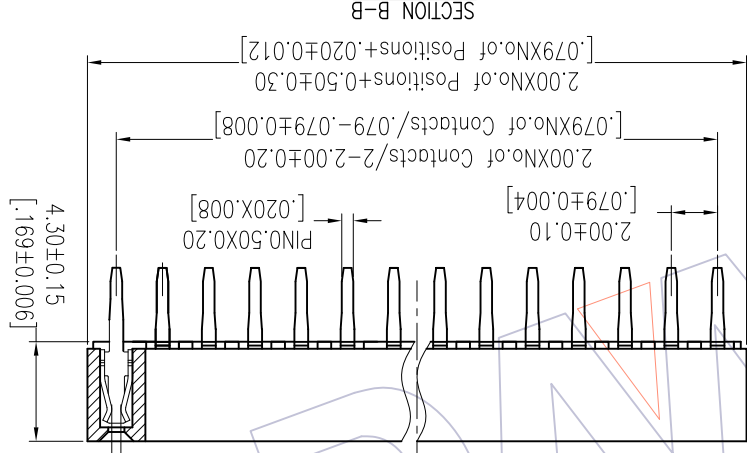

Item	Pitch	Mating
Standard	2.00	1215/1220
Alternate		

TITLE	DIM A	PART NO.
TYPE 1	6.00	2243-2XXWXXCUNX1
TYPE 2	5.00	2243-2XXWXXCUNX2

REV	DATE	MODIFICATION DESCRIPTION	CHANGE	OPERATION		DRAW		CHECK		APPROVE		DATE	DATE	PROJ.	Customer NO.
				SCALE	FIT	UNIT	SIZE	SHEET	DATE	DATE	DATE				
A1	2015/09/14	Modify 3.00 to 3.20	A1	X.X	±0.40	Allen	2015/09/14	mm	A4	1/1					
A0	2012/07/14	NEW		X.XXX	±0.15										

**WCON**  
 Http://www.wcon.com

WCON-Dongguan  
 WCON-Kunshan

Tel: +86 769 85358920  
 Fax: +86 769 85358915  
 E-mail: sdies@wcon.com

Tel: +86 512 57468408  
 Fax: +86 512 57468468  
 E-mail: sdiesks@wcon.com

## X-ON Electronics

Largest Supplier of Electrical and Electronic Components

*Click to view similar products for [Headers & Wire Housings](#) category:*

*Click to view products by [Wcon](#) manufacturer:*

Other Similar products are found below :

[95000-104TRLF](#) [10135584-644402LF](#) [DF62W-EP2022PCA](#) [95000-106TRLF](#) [DF62W-2022SCA](#) [DF62W-EP2022PC](#) [2203348](#) [DF62W-2022SC](#) [1084018](#) [1029039](#) [1084017](#) [802-10-012-10-002000](#) [1112640](#) [1112639](#) [891-007-9SS-BST1T](#) [000-34000](#) [0008550134](#) [0009482033](#) [0009507031](#) [57102-F02-18ULF](#) [57102-S06-03LF](#) [57202-S52-04LF](#) [PCN6-15S-2.5E](#) [0039019024](#) [58102-G61-06LF](#) [582553-1](#) [0009485154](#) [0009508121](#) [0022285053](#) [0050291907](#) [018731A](#) [LY20-4P-DT1-P1E-BR](#) [02.125.8002.8](#) [60101931](#) [60598-1 \(Cut Strip\)](#) [M1625-3R/100](#) [61062-3](#) [61082-181009](#) [CSU011177004](#) [636-1427](#) [638009-1](#) [641938-9](#) [641991-4](#) [644168-1](#) [644827-2](#) [647662-1](#) [65039-019ELF](#) [65692-001LF](#) [65781-018](#) [65781-047](#)