

Ordering Information

3110-XX S XX X K00 XX

NOTES:
 Current Rating: 3.0AMP
 Contact Resistance: 20mΩ Max
 Withstand Voltage: 1000V AC/DC
 Insulation Resistance: 1000MΩ Min
 Operation Temperature: -40°C to +105°C
 Contact Material: Brass
 Contact plating: Au Or Sn over Ni
 Insulator Material: PA9T+3%GF UL94V-0 (Std)
 Or PBT+30%GF UL94V-0

- No. of Pins
 6P
 8P
 10P
 12P
 14P
 16P
 18P
 20P
- Contact Plating
 G0=Gold Flash
 G3=10u"Gold
 G4=15u"Gold
 G5=30u"Gold
 S0=Gold Flash/Tin
 S3=10u"Gold/Tin
 S4=15u"Gold/Tin
 S5=30u"Gold/Tin
 SN=Tin
- Color Insulator
 A=Black
 B=Blue
 R=White
 T=Tube
- Packaging
 A=Tray
 B=Black
 L=Tube
 R=1 Tape&Reel+CAP
- E=Gray(413C)
 F=Gray(427C)

Item	Pitch	Standard	Alternate
Mating	2.54	5212/2185	

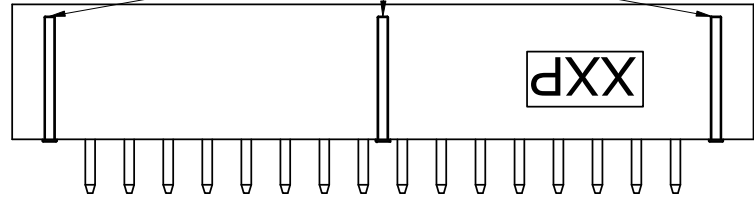

8P及以上(3个加强筋) ▲

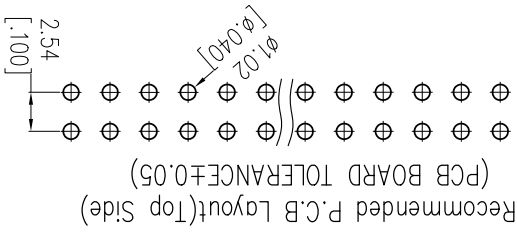
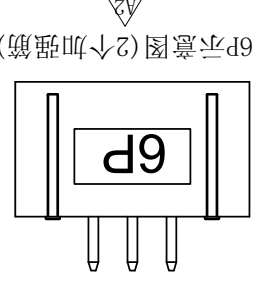
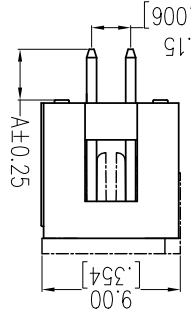
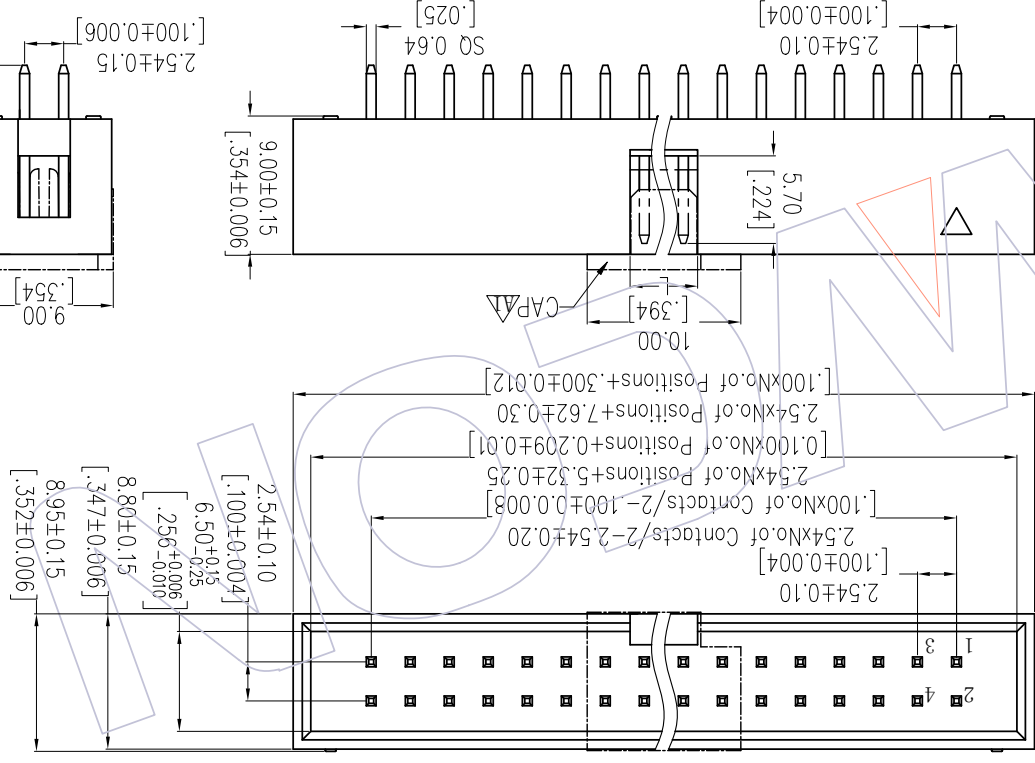

REV	DATE	MODIFICATION DESCRIPTION	CHANGE	DIM	TOL	OPERATION	DRAW	DATE	SCALE	FIT	PART NO.
A0	2012/09/25	NEW	-----	Angle	±.3		APPROVE	DATE			
A1	2018/05/04	Add the CAP	-----	X.XXX	±0.15		CHECK	DATE			
A2	2019/07/12	Modify	-----	X.XX	±0.25		Dwg	2019/07/12			3110-XXXXXXK00XX

PROJ.	SHEET	SIZE	UNIT	SCALE
Customer NO.	1/1	A4	mm	
TITE: 2.54 BOX HEADER 180° H=9.0				

DATE	APPROVE	DATE	APPROVE

NO.	DESCRIPTION	DATE	BY
1	Customer NO.		

NO.	DESCRIPTION	DATE	BY
1	Customer NO.		

NO.	DESCRIPTION	DATE	BY
1	Customer NO.		

NO.	DESCRIPTION	DATE	BY
1	Customer NO.		

WCON
 WCON-Dongguan
 WCON-Kunshan
 Http: www.wcon.com

Tel: +86 769 8535820
 Fax: +86 769 85358915
 E-mail: sdies@wcon.com

Tel: +86 512 57468408
 Fax: +86 512 57468468
 E-mail: sdiesks@wcon.com

X-ON Electronics

Largest Supplier of Electrical and Electronic Components

Click to view similar products for [wcon](#) manufacturer:

Other Similar products are found below :

[2185-140SG0AYNT1](#) [1125-1206G0S155C002](#) [2263-205SG0DYNT6](#) [2185-207ZG0CYNT1](#) [2157-140SG0CYNT1](#) [1125-2212G0S280C001](#)
[WF2543-1H03B01](#) [WF2543-1H04B01](#) [1220-1210G0M087P1](#) [WF2543-1H07B01](#) [2185DN1-205SG0CYNT1](#) [3622-S040-027G1R02](#) [2263-222RG0DYNT1](#) [1215-2114G0S076C002](#) [1325-1208G0Z093CT01](#) [1125-2208G0S360C001](#) [2220T-206MS0CUNT2](#) [3622-P040-038G1R02](#)
[WF1501-WM09ER1](#) [1125-1206G0M113CR01](#) [WF2005-2H09W01](#) [6223-09FMNS0B02](#) [6212-26FHS0B01](#) [3220-20SW0BST1](#) [WF2005-WR02ET2](#) [2185DN2-106SG0CYNT1](#) [2185-240SG0AYNT1](#) [2111P-232SG0FYNT4](#) [3111-20MSNBK00R1](#) [1125-2205G0S210C001](#) [2185-208SS0CYNT1](#) [2159-213RG0CUNT1](#) [2263D-204SG0DYNT6](#) [2185-209SS1CYNT2](#) [2211-112MG0CYNR4](#) [2227T-204MG3CUNR1](#) [2185-210SG0CYNR1](#) [6212-26MHS0B01](#) [3610-S020-040G1R01](#) [WF3001-2WR03BA1](#) [WF1001A-WZ06ET1](#) [6321D-040SDS1PNT01](#) [2185-208SSNCYNT1](#) [6320D-040RDS1PNT01](#) [WF2547-2H06B01](#) [2135-207MH3CUNR3](#) [2243-211WG0CUNT2](#) [2185-104ZG0CYNR1](#) [2272-209RG0CUNT1](#) [WF2549-2WS10S0B01](#)